



**Global
V-Line Catalogue
2026/2027**



SAFETYLINK

A DELTA PLUS GROUP COMPANY



HEIGHT SAFETY, ACCESS & FALL PROTECTION SYSTEMS

Established in 1998, SafetyLink has become a globally recognised leader in the design, manufacture and distribution of high-quality height safety systems.

Renowned for pioneering the first energy-absorbing anchor point, this innovative technology has since been integrated across the Frog range and extended into our anchor points, lifeline and rail systems, delivering enhanced safety performance across a wide range of applications.

All SafetyLink products are extensively tested to meet and exceed international industry standards. Testing is conducted across a wide range of real-world scenarios, ensuring our systems perform reliably beyond the laboratory. We test to European Standards EN795 and CEN/TS16415, Australian Standards AS/NZS 1891.4 and 5532 and USA Standards OSHA/ANSI 1926.502 and Z359.

About SafetyLink



SCAN ME

**SafetyLink Webinar
Online Training**

SafetyLink takes working at heights seriously, providing comprehensive installation instructions and online training, supported with an experienced technical and design team. Our online platform enables easy access to our learning management system, product information and lifeline system builds all in the one place.

- Supply a large range of height safety systems that protect workers from the ground up
- All products tested and manufactured to current standards
- Access to online training modules 24/7
- Supply of installation guides and product data sheets
- Assisted system design layout and advice
- Extensive technical support with collectively over 100 years of experience in the height safety industry

Visit www.safetylink.com for the latest training, height safety resources and fall protection products.

Version: 3



Contents

- VERTICAL LIFELINE5**
 - V-LINE VERTICAL LIFELINE KITS 6
 - V-LINE VERTICAL LIFELINE - CABLE GUIDES 8
 - V-LINE VERTICAL LIFELINE BRACKETS..... 9

- PERSONAL PROTECTIVE EQUIPMENT & SELF RETRACTING LIFELINES11**
 - SRL ANCHOR KIT 12
 - SELF RETRACTING LIFELINES - EDGE..... 13
 - PPE - HARNESSSES 15
 - PPE - ROOFERS KITS..... 16
 - PPE - LANYARDS 18

- TOOLS.....21**
 - RIVET TOOLS 22
 - CRIMPING TOOLS..... 23

- SERVICES.....24**
 - APPENDIX 3 - CABLE 24
 - TRAINING 25
 - BIM CONTENT..... 26
 - EXPERT FALL PROTECTION PLANNING..... 27
 - DELTA PLUS 28

V Line

SafetyLink's V-Line is a vertical lifeline system designed to provide safe, continuous fall protection for ladder and structure access in industrial and commercial environments.

Key Features:

- Supports single or multiple users on a vertical lifeline system
- Permanently mounted cable system for continuous access
- Energy-absorbing shuttle with automatic fall arrest function
- Suitable for retrofit to ladders, monopoles and climbing structures
- Durable construction using 316 stainless steel and galvanised steel
- Engineered for demanding industrial environments



SCAN ME

V-LINE INSTALLATION HANDBOOK



SCAN ME

V-LINE WEBSITE



SCAN ME

V-LINE CATALOGUE



Got questions? Contact SafetyLink for more information.

1300 789 545

VERTICAL LIFELINE

SafetyLink's V-Line is a vertical lifeline system designed to deliver safe and continuous fall protection during ladder and structure access. It enables smooth vertical movement for one or multiple users via a permanently installed safety cable, while maintaining a controlled connection that helps reduce free fall distance, limit swing fall and maximise available fall clearance.

The system is designed for flexible installation across a range of structures including steel ladders, monopoles and similar access systems. A maximum allowable deviation of 15 degrees from vertical ensures optimal performance.

An energy-absorbing shuttle with integrated karabiner travels with the user and automatically locks in the event of a fall, providing a reliable and consistent fall arrest response. Manufactured from durable 316 stainless steel and galvanised steel, the system is engineered for long-term performance in demanding environments.

APPLICATION:

Vertical fall protection system for ladder and structure access in industrial and commercial environments.

USE:

Designed for single or multiple users requiring continuous vertical access while maintaining fall protection. Installation must be carried out in accordance with a risk assessment and rescue plan by trained and competent personnel.

V-LINE CABLE

VLINE.CABLE.XXX

- V-Line cable with swaged termination.
- Cable Length to be advised, 2 metres to be included on longer stiles.

Components	Description	Material	Qty	Weight
VLINE.SWAGE	V-LINE Swaged Termination	316SS	1	0.081
VLINE.CABLE001	Cable: 8mm diameter, 7 x 7 wire rope	316SS	1	0.252
				0.333



V-LINE CABLE WITH 90 DEGREE CABLE GUIDE

VLINE.CABLE.AG.XXX

- V-Line cable with swaged termination.
- Cable Length to be advised, 2 metres to be included on longer stiles.

Components	Description	Material	Qty	Weight
VLINE.SWAGE	V-LINE Swaged Termination	316SS	1	0.081
VLINE.CABLE001	Cable: 8mm diameter, 7 x 7 wire rope	316SS	1	0.252
VLINEGDE003	V-LINE 90 degree bolt on cable guide	Galvanized	1	0.332



V-LINE CABLE WITH STRAIGHT CABLE GUIDE

VLINE.CABLE.SG.XXX

- V-Line cable with swaged termination.
- Cable Length to be advised, 2 metres to be included on longer stiles.

Components	Description	Material	Qty	Weight
VLINE.SWAGE	V-LINE Swaged Termination	316SS	1	0.081
VLINE.CABLE001	Cable: 8mm diameter, 7 x 7 wire rope	316SS	1	0.252
VLINEGDE004	V-LINE Straight bolt on cable guide	Galvanized	1	0.304



V-LINE KIT: TOP AND BOTTOM BRACKETS

VLINE002

- V-Line top and bottom bracket only. Does not include mounting plates.

Components	Description	Material	Qty	Weight
VLINE.BTM.PM	V-LINE Bottom Bracket Kit	316SS	1	1.000
VLINE.TOP.PM	V-LINE Top Bracket Kit	316SS	1	0.800
				1.800



V-LINE KIT: TOP AND BOTTOM BRACKETS - BOLT ON 1995MM

VLINE012

- V-Line ladder rung top and bottom brackets, Supplied with U Bolts for fixing to ladder rungs.
- Extends above top ladder rung 1300mm.

Components	Description	Material	Qty	Weight
VLINE.BTM.PM	V-LINE Bottom Bracket Kit	316SS	1	1.000
VLINE.TOP.PM	V-LINE Top Bracket Kit	316SS	1	0.800
VLINE.UBS.K	V-LINE Single U Bolt Kit	Galvanized	1	0.104
VLINE.UBS.K.135	V-LINE Single U Bolt Kit 135mm	Galvanized	1	0.200
VLINE.UBT.K.135	V-LINE Twin U Bolt Kit 135mm	Galvanized	2	1.200
VLINE.POST.1995	V-LINE Post 1995mm (Top)	Galvanized	1	9.000
VLINE.POST.480B	V-LINE Post 480mm (Bottom)	Galvanized	1	1.600
				13.90



Got questions? Contact SafetyLink for more information.

1300 789 545

V-LINE KIT: TOP AND BOTTOM BRACKETS WITH MOUNTING PLATES

VLIN003

- V-Line top and bottom brackets with structural fixing mounting plates for welding to structure.



Components	Description	Material	Qty	Weight
VLIN.BTM.PM	V-LINE Bottom Bracket Kit	316SS	1	1.000
VLIN.TOP.PM	V-LINE Top Bracket Kit	316SS	1	0.800
VLIN.PLT.BTM	V-LINE Bottom Plate	316SS	1	0.085
VLIN.PLT.TOP	V-LINE Top Plate	316SS	1	0.085
				1.970

V-LINE KIT: TOP AND BOTTOM BRACKETS - BOLT ON 485MM

VLIN004

- V-Line top and bottom brackets, top bracket terminates at top rung of ladder.

Galvanized V-LINE- PRODUCT CODE: VLIN004

Components	Description	Material	Qty	Weight
VLIN.BTM.PM	V-LINE Bottom Bracket Kit	316SS	1	1.000
VLIN.TOP.PM	V-LINE Top Bracket Kit	316SS	1	0.800
VLIN.UBS.K	V-LINE Single U Bolt Kit	Galvanized	2	0.104
VLIN.UBT.K	V-LINE Twin U Bolt Kit	Galvanized	1	0.409
VLIN.POST.480	V-LINE Post 480mm (Top)	Galvanized	1	1.600
VLIN.POST.480B	V-LINE Post 480mm (Bottom)	Galvanized	1	1.600
				5.617



STAINLESS STEEL V-LINE- PRODUCT CODE: VLIN004-SS

Components	Description	Material	Qty	Weight
VLIN.BTM.PM	V-LINE Bottom Bracket Kit	316SS	1	1.000
VLIN.TOP.PM	V-LINE Top Bracket Kit	316SS	1	0.800
VLIN.UBS.K-SS	V-LINE Single U Bolt Kit	316SS	2	0.170
VLIN.UBT.K-SS	V-LINE Twin U Bolt Kit	316SS	1	0.500
VLIN.POST.480-SS	V-LINE Post 480mm (Top)	316SS	1	1.570
VLIN.POST.480B-SS	V-LINE Post 480mm (Bottom)	316SS	1	1.580
				5.790

V-LINE KIT: TOP AND BOTTOM BRACKETS - BOLT ON 1575MM

VLIN005

- V-Line ladder rung top and bottom brackets, Supplied with U Bolts for fixing to ladder rungs.
- Extends above top ladder rung 900mm.



Galvanized V-LINE - PRODUCT CODE: VLIN005

Components	Description	Material	Qty	Weight
VLIN.BTM.PM	V-LINE Bottom Bracket Kit	316SS	1	1.000
VLIN.TOP.PM	V-LINE Top Bracket Kit	316SS	1	0.800
VLIN.UBS.K	V-LINE Single U Bolt Kit	Galvanized	2	0.104
VLIN.UBT.K	V-LINE Twin U Bolt Kit	Galvanized	2	0.409
VLIN.POST.1575	V-LINE Post 1575mm (Top)	Galvanized	1	5.300
VLIN.POST.480B	V-LINE Post 480mm (Bottom)	Galvanized	1	1.600
				9.726

STAINLESS STEEL V-LINE- PRODUCT CODE: VLIN005-SS

Components	Description	Material	Qty	Weight
VLIN.BTM.PM	V-LINE Bottom Bracket Kit	316SS	1	1.000
VLIN.TOP.PM	V-LINE Top Bracket Kit	316SS	1	0.800
VLIN.UBS.K-SS	V-LINE Single U Bolt Kit	316SS	2	0.170
VLIN.UBT.K-SS	V-LINE Twin U Bolt Kit	316SS	1	0.500
VLIN.POST.1575-SS	V-LINE Post 1575mm (Top)	316SS	1	5.100
VLIN.POST.480B-SS	V-LINE Post 480mm (Bottom)	316SS	1	1.580
				9.820

V-LINE SHUTTLE

VLINESHUT001

- V-Line shuttle to be connected to harness.
- Single user shuttle.



Components	Description	Material	Qty	Weight
VLINESHUT001.01	V-LINE Vertical Shuttle	Stainless Steel	1	0.800
KARBNR036	Karabiner: Steel, Dual Action, Gate 20mm, Rated 41kn	Steel	1	0.200
				1.000

CABLE GUIDE POLE BOLT ON KIT - 90 DEGREE

VLINEGDE001

- Vertical lifeline 90 degree cable guide pole bolt on kit for use on ladder lifelines.
- Cable guides are used to stop cable from swaying, required every 8 metres.



Product Code	Description	Material	Qty	Weight
VLINEGDE001	V-LINE Cable Guide Pole Bolt on 90 Degree Kit	Galvanized	1	0.339

CABLE GUIDE POLE BOLT ON KIT - STRAIGHT

VLINEGDE002

- Vertical lifeline straight cable guide pole bolt on kit for use on ladder lifelines.
- Cable guides are used to stop cable from swaying, required every 8 metres.



Product Code	Description	Material	Qty	Weight
VLINEGDE002	V-LINE Cable Guide Pole Bolt on Straight Kit	Galvanized	1	0.311

CABLE GUIDE LADDER RUNG BOLT ON KIT - 90 DEGREE

VLINEGDE003

- Vertical lifeline 90 degree cable guide bolt on kit for use on ladder lifelines.
- Cable guides are used to stop cable from swaying, required every 8 metres.



Product Code	Description	Material	Qty	Weight
VLINEGDE003	V-LINE Cable Guide Ladder Rung Bolt on 90 Degree Kit	Galvanized	1	0.332

CABLE GUIDE LADDER RUNG BOLT ON KIT - STRAIGHT

VLINEGDE004

- Vertical lifeline straight cable guide bolt on kit for use on ladder lifelines.
- Cable guides are used to stop cable from swaying, required every 8 metres.



Product Code	Description	Material	Qty	Weight
VLINEGDE004	V-LINE Cable Guide Ladder Rung Bolt on Stright Kit	Galvanized	1	0.304

CABLE GUIDE POLE MOUNTING BRACKET

VLINE.PLT.CG

- Cable guide pole support brackets can be fastened with any M12 fastner capable of supporting 200kg. Alternatively, the brackets may be welded to metal poles. Any welds shall be suitably protected from corrosion with a minimum 75um or zinc rich primer.



Product Code	Description	Material	Qty	Weight
VLINE.PLT.CG	V-LINE Plate for Cable Guide Pole	Galvanized	1	0.150

CABLE GUIDE POLE MOUNTING BRACKET - EXTENDED

VLINE.PLT.CG.EXT

- Cable guide pole support brackets can be fastened with any M12 fastner capable of supporting 200kg. Alternatively, the brackets may be welded to metal poles. Any welds shall be suitably protected from corrosion with a minimum 75um or zinc rich primer.



Product Code	Description	Material	Qty	Weight
VLINE.PLT.CG.EXT	V-LINE Plate for Cable Guide Pole- Extended 100mm	Galvanized	1	0.240

Got questions? Contact SafetyLink for more information.

1300 789 545

V-LINE WARNING COMPLIANCE SIGN

VLIN.WARN

- Vertical lifeline warning compliance sign.
- Notes installer information, safe use and inspection details.

Product Code	Description	Material	Qty	Weight
VLIN.WARN	V-LINE: Warning Compliance Sign	Aluminium	1	0.200



V-LINE FIXING BRACKET - TOP WELD ON

VLIN.PLT.TOP

- V-Line top weld on support fixing bracket.

Product Code	Description	Material	Qty	Weight
VLIN.PLT.TOP	V-LINE: Tope Plate- Weld on	316SS	1	0.085



V-LINE FIXING BRACKET - BOTTOM WELD ON

VLIN.PLT.BTM

- V-Line bottom weld on support fixing bracket.

Product Code	Description	Material	Qty	Weight
VLIN.PLT.BTM	V-LINE: Bottom Plate- Weld on	316SS	1	0.085



FIXING BRACKET - TOP POLE BOLT ON

VLIN.PLT.TOP.POLE

- V-Line top bolt on support fixing bracket.
- Fixing to Steel - M12 or M16 bolts as per section 3.2.4 of manual.
- Fixing to Concrete - M16 fasteners, embedment depth 95mm as per section 3.2.3 of manual.

Product Code	Description	Material	Qty	Weight
VLIN.PLT.TOP.POLE	V-Line top bolt on support fixing bracket	316SS	1	1.610



FIXING BRACKET - BOTTOM POLE BOLT ON

VLIN.PLT.BTM.POLE

- V-Line bottom bolt on support fixing bracket.
- Fixing to Steel - M12 or M16 bolts as per section 3.2.4 of manual.
- Fixing to Concrete - M16 fasteners, embedment depth 95mm as per section 3.2.3 of manual.

Product Code	Description	Material	Qty	Weight
VLIN.PLT.BTM.POLE	V-Line bottom bolt on support fixing bracket	316SS	1	1.520



FIXING BRACKET - TOP POLE BOLT ON EXTENSION

VLIN.PLT.TOP.POLE.EXT

- V-Line top bolt on support fixing bracket, extended 100mm.
- Fixing to Steel - M12 or M16 bolts as per section 3.2.4 of manual.
- Fixing to Concrete - M16 fasteners, embedment depth 120mm as per section 3.2.3 of manual.

Product Code	Description	Material	Qty	Weight
VLIN.PLT.TOP.POLE.EXT	V-Line top bolt on support fixing bracket, extended 100mm	316SS	1	2.260



FIXING BRACKET - BOTTOM POLE BOLT ON EXTENSION

VLIN.PLT.BTM.POLE.EXT

- V-Line bottom bolt on support fixing bracket, extended 100mm.
- Fixing to Steel - M12 or M16 bolts as per section 3.2.4 of manual.
- Fixing to Concrete - M16 fasteners, embedment depth 120mm as per section 3.2.3 of manual.

Product Code	Description	Material	Qty	Weight
VLIN.PLT.BTM.POLE.EXT	V-Line bottom bolt on support fixing bracket, extended 100mm	316SS	1	1.990



PERSONAL PROTECTIVE EQUIPMENT & SELF RETRACTING LIFELINES

SafetyLink's PPE range provides reliable, compliant personal protective equipment designed to support safe working at heights and in hazardous environments. From essential height safety gear such as harnesses, kits and lifelines through to a comprehensive selection of head, hand, eye, hearing, respiratory and protective workwear, the range delivers durable, site-ready protection for demanding industrial applications.



Got questions? Contact SafetyLink for more information.

1300 789 545



PERSONAL PROTECTIVE EQUIPMENT & SELF RETRACTING LIFELINES



V-LINE SELF RETRACTING KIT

VLINE.SRL.KIT

- Self-retracting lanyard anchor kit, designed to be installed on the rungs of a ladder.
- Systems shall be designed to limit free fall, swing fall and maximise fall clearance.
- Where possible, systems should be installed as close to the centre of the ladder or climbing zone as possible.
- Use in conjunction with SafetyLink's Tuff-Bloc's (shown in picture above, purchased separately).

⚠ All load cases shall be considered by a trained engineer.

Product Code	Description	Material	Qty	Weight
VLINE.SRL.ANCHOR	Self Retracting Anchor Kit	Galvanized	1	10.00
VLINE.SRL.ROPE	SRL Rope (for use at Maximum Height 15m)	Polyester	1	1.000
VLINE.SRL.PULLEY	Self Retracting Anchor Pulley Kit	Galvanized	2	2.000

- STANDARD
- The Ladder SRL Anchor System is compliant with AS/NZS 5532, EN795 TYPE A and OSHA 1926.502 and 1910.140.
- USER RATING
- The Ladder SRL Anchor is rated for 1 user per system.



Got questions? Contact SafetyLink for more information.

1300 789 545

The SafetyLink Tuff-Bloc is a Self Retracting Lifeline suitable for use as part of a personal fall protection system. Non edge rated versions of the Tuff-Bloc Pro shall be used in the vertical or near vertical orientation. The Tuff-Bloc Edge models can be used horizontally and shall be used if there is a chance a fall occurring over a leading edge. Where possible the Tuff-Bloc should be used to limit free fall to less than 600mm (2ft).

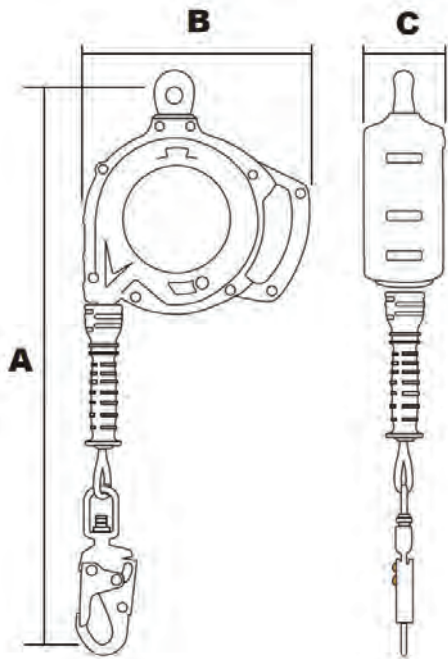

FIGURE 1



FIGURE 2

Standard

The Tuff-Bloc Pro models listed in Figure 1 are certified to;

- EN360-2002 40-140kg
- AS/NZS 1891.3-2020 40-140kg
- ANSI Z359.14-2021 130-310lbs Class 1
- CSA Z259.2.2-17 130-310 lbs
- OSHA 1910.140 420lbs

The Tuff-Bloc Edge models listed in Figure 1 are certified to;

- EN360-2002 and RFU 11.060 40-140kg
- AS/NZS 1891.3-2020 40-140kg
- EU Declaration can be found at <https://www.safetylink.com>
-

When selecting an anchor for use with the Tuff-Bloc Self Retracting Lifeline, consider the local standards and regulations. Where a free fall does not exceed 600mm (2ft), the anchor selected shall be rated to a minimum of 12kN (2700lbs). Where a free fall can exceed 600mm (2ft), the anchor selected shall be rated to 15kN (3400lbs).

For leading edge applications, the anchor shall not be located below the edge.

The fall hazard shall never be between the user and the anchor when using this product.

User Rating

The Tuff-Bloc is rated for one user. If a fall could occur over an edge, ensure an edge rated model is used.

Product Code	Anchor Below Connection /Edge Rated	Functional Length	Retracted Length (A)	Width (B)	Thickness (C)	Weight
TUFF-BLOC-PRO006	☒	6m (20ft)	610mm (24")	226mm (8.9")	86mm (3.4")	3.5kg (7.7lbs)
TUFF-BLOC-PRO010	☒	10m (33ft)	610mm (24")	226mm (8.9")	86mm (3.4")	4.4kg (9.8lbs)
TUFF-BLOC-PRO015	☒	15m (50ft)	671mm (26.4")	259mm (10.2")	97.5mm (3.8")	6.8kg (15lbs)
TUFF-BLOC-PRO020	☒	20m (66ft)	701mm (27.6")	292mm (11.5")	99mm (3.9")	9.1kg (20.1lbs)
TUFF-BLOC-EDGE006	☑	6m (20ft)	860mm (33.9")	226mm (8.9")	86mm (3.4")	4.0kg (8.8lbs)
TUFF-BLOC-EDGE010	☑	10m (33ft)	860mm (33.9")	226mm (8.9")	86mm (3.4")	4.7kg (10.4lbs)
TUFF-BLOC-EDGE015	☑	15m (50ft)	920mm (36.2")	259mm (10.2")	97.5mm (3.8")	7.1kg (15.7lbs)
TUFF-BLOC-EDGE020	☑	20m (66ft)	950mm (37.4")	292mm (11.5")	99mm (3.9")	9.4kg (20.7lbs)

AERO BLOC - SINGLE SELF RETRACTING LIFELINE WITH SNAP HOOK

AEROBLOC2M-SH-KB

- Lightweight compact unit.
- Clear durable housing for ease of unit inspection.
- External shock pack with durable cover.
- Aluminium connectors with 16kN gate strength.

Components	Description	Material	Qty	Weight
AEROBLOC2M-SH-KB	2m SRL with Snap Hook and Karabiner	Nylon/Alloy	1	1.400



AERO BLOC - TWIN SELF RETRACTING LIFELINE WITH SNAP HOOK

AEROBLOC2M-SH-X2

- Lightweight compact unit.
- Clear durable housing for ease of unit inspection.
- External shock pack with durable cover.
- Aluminium connectors with 16kN gate strength.
- Aero connect triple action dual leg bracket, joins twin legs.

Components	Description	Material	Qty	Weight
AEROBLOC2M-SH-X2	2m Twin SRL with Snap Hook and Aero Connect	Nylon/Alloy	1	2.700



AERO BLOC - SINGLE SELF RETRACTING LIFELINE WITH REBAR/SCAFFOLD HOOK

AEROBLOC2M-RH-KB

- Lightweight compact unit.
- Clear durable housing for ease of unit inspection.
- External shock pack with durable cover.
- Aluminium connectors with 16kN gate strength.

Components	Description	Material	Qty	Weight
AEROBLOC2M-RH-KB	2m SRL with Rebar/Scaffold Hook and Karabiner	Nylon/Alloy	1	1.800



AERO BLOC - TWIN SELF RETRACTING LIFELINE WITH REBAR/SCAFFOLD HOOK

AEROBLOC2M-RH-X2

- Lightweight compact unit.
- Clear durable housing for ease of unit inspection.
- External shock pack with durable cover.
- Aluminium connectors with 16kN gate strength.
- Aero connect triple action dual leg bracket, joins twin legs.

Components	Description	Material	Qty	Weight
AEROBLOC2M-RH-X2	2m Twin SRL-Rebar/Scaffold Hook and Aero Connect	Nylon/Alloy	1	3.600



Got questions? Contact SafetyLink for more information.

1300 789 545

DELTA PLUS FULL BODY HARNESS

DP_WAUHAR12

- Centre Rear D ring attachment.
- Two (2) Centre Front Hoops.
- Orange Webbing with Black Stitching.
- Aluminium Fittings.

TWO (2) SIZES AVAILABLE

Components	Description	Material	Qty	Weight
DP_WAUHAR12GT	Delta Plus Full Body Harness	Polyester	S,M,L	0.730
DP_WAUHAR12XX	Delta Plus Full Body Harness	Polyester	XL,XXL	0.730



DELTA PLUS FULL BODY HARNESS

DP_WAUHAR14

- Centre Rear D ring attachment.
- Two (2) Centre Front Hoops.
- Includes Belt with Side D Rings and Restraint D Ring.
- Orange Webbing with Black Stitching.
- Aluminium Fittings.

TWO (2) SIZES AVAILABLE

Components	Description	Material	Qty	Weight
DP_WAUHAR14GT	Delta Plus Full Body Harness with Belt	Polyester	S,M,L	1.100
DP_WAUHAR14XX	Delta Plus Full Body Harness with Belt	Polyester	XL,XXL	1.100



DELTA PLUS PREMIUM RIGGER FULL BODY HARNESS

DP_WAUHAR32M

- Sternal Loops, Dorsal D-Ring.
- Quick Connect Legs, Pull Through Torso.
- Quick Connect Chest.
- Grey Webbing with Green Stitching.
- Aluminium Fittings.

TWO (2) SIZES AVAILABLE

Components	Description	Material	Qty	Weight
DP_WAUHAR32MGT	Premium Rigger Full Body Harness	Polyester	S,M,L	1.400
DP_WAUHAR32MXX	Premium Rigger Full Body Harness	Polyester	XL,XXL	1.400



DELTA PLUS PREMIUM MULTI-PURPOSE BODY HARNESS

DP_WAUHAR35M

- Sternal Loops, Dorsal D-Ring.
- Belt/Side Drings, Rear Waist D-Ring, Quick Connect Legs.
- Pull Through Torso, Quick Connect Chest.
- Grey Webbing with Green Stitching.
- Aluminium Fittings.

TWO (2) SIZES AVAILABLE

Components	Description	Material	Qty	Weight
DP_WAUHAR35MGT	Premium Multi-purpose Body Harness with Belt	Polyester	S,M,L	2.000
DP_WAUHAR35MXX	Premium Multi-purpose Body Harness with Belt	Polyester	XL,XXL	2.000



PPE - ROOFERS KITS

AS/NZS1891.1:2020
AS/NZS 1891.5
AS/NZS 1891.3



DP_ROOFKIT_SL_DP12GT.20

Roof Workers Kit

WAUHAR12 Harness S,M,L or XL,XXL: Ergonomic design for comfort and protection | Adjustable Energy-Absorbing Rope Line – 20m or 30m | Anchor Strap : 1.5m red 25mm webbing strap with 21kN rating | High-Strength Karabiners | Gear Bag.



Available Options: Roofers Kit S,M,L with 20M Rope line: DP_ROOFKIT_SL_DP12GT.20
Roofers Kit XL, XXL with 20M Rope line: DP_ROOFKIT_SL_DP12XX.20
Roofers Kit S,M,L with 30M Rope line: DP_ROOFKIT_SL_DP12GT.30
Roofers Kit XL, XXL with 30M Rope line: DP_ROOFKIT_SL_DP12XX.30

AS/NZS1891.1:2020
AS/NZS 1891.5
AS/NZS 1891.3

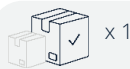

DP_ROOFKIT_SL_DP14GT.20

Roof Workers Kit

WAUHAR14 Harness S,M,L or XL,XXL: Ergonomic design for comfort and protection | Adjustable Energy-Absorbing Rope Line – 20m or 30m | Anchor Strap : 1.5m red 25mm webbing strap with 21kN rating | High-Strength Karabiners | Gear Bag.



Available Options: Roofers Kit S,M,L with 20M Rope line: DP_ROOFKIT_SL_DP14GT.20
Roofers Kit XL, XXL with 20M Rope line: DP_ROOFKIT_SL_DP14XX.20
Roofers Kit S,M,L with 30M Rope line: DP_ROOFKIT_SL_DP14GT.30
Roofers Kit XL, XXL with 30M Rope line: DP_ROOFKIT_SL_DP14XX.30

AS/NZS1891.1:2020
AS/NZS 1891.5
AS/NZS 1891.3

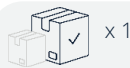

DP_ROOFKIT_SL_DP32MGT.20

Roof Workers Kit

WAUHAR32 Harness S,M,L or XL,XXL: Ergonomic design for comfort and protection | Adjustable Energy-Absorbing Rope Line – 20m or 30m | Anchor Strap : 1.5m red 25mm webbing strap with 21kN rating | High-Strength Karabiners | Gear Bag.



Available Options: Roofers Kit S,M,L with 20M Rope line: DP_ROOFKIT_SL_DP32MGT.20
Roofers Kit XL, XXL with 20M Rope line: DP_ROOFKIT_SL_DP32MXX.20
Roofers Kit S,M,L with 30M Rope line: DP_ROOFKIT_SL_DP32MGT.30
Roofers Kit XL, XXL with 30M Rope line: DP_ROOFKIT_SL_DP32MXX.30

AS/NZS1891.1:2020
AS/NZS 1891.5
AS/NZS 1891.3



DP_ROOFKIT_SL_DP35MGT.20

Roof Workers Kit

WAUHAR35 Harness S,M,L or XL,XXL: Ergonomic design for comfort and protection | Adjustable Energy-Absorbing Rope Line – 20m or 30m | Anchor Strap : 1.5m red 25mm webbing strap with 21kN rating | High-Strength Karabiners | Gear Bag.



Available Options: Roofers Kit S,M,L with 20M Rope line: DP_ROOFKIT_SL_DP35MGT.20
Roofers Kit XL, XXL with 20M Rope line: DP_ROOFKIT_SL_DP35MXX.20
Roofers Kit S,M,L with 30M Rope line: DP_ROOFKIT_SL_DP35MGT.30
Roofers Kit XL, XXL with 30M Rope line: DP_ROOFKIT_SL_DP35MXX.30

Got questions? Contact SafetyLink for more information.

1300 789 545

AS/NZS1891.1:2020
AS/NZS 1891.5
AS/NZS 1891.3



DP_ROOFKIT_DP12GT.20EG

Roof Workers Kit with Eyewear and Gloves | WAUHAR12 Harness S,M,L or XL,XXL: Ergonomic design for comfort and protection | Adjustable Energy-Absorbing Rope Line – 20m or 30m | Anchor Strap : 1.5m red 25mm webbing strap with 21kN rating | High-Strength Karabiners | Gear Bag | Eyewear : DP_IRAZUIN | Gloves: DP_VE727NO09.



- Available Options:**
- Roofers Kit S,M,L with 20M Rope line, Eyewear & Gloves: DP_ROOFKIT_DP12GT.20EG
 - Roofers Kit XL, XXL with 20M Rope line, Eyewear & Gloves: DP_ROOFKIT_DP12XX.20EG
 - Roofers Kit S,M,L with 30M Rope line, Eyewear & Gloves: DP_ROOFKIT_DP12GT.30EG
 - Roofers Kit XL, XXL with 30M Rope line, Eyewear & Gloves: DP_ROOFKIT_DP12XX.30EG

AS/NZS1891.1:2020
AS/NZS 1891.5
AS/NZS 1891.3

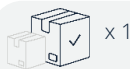

DP_ROOFKIT_DP14GT.20EG

Roof Workers Kit with Eyewear and Gloves | WAUHAR14 Harness S,M,L or XL,XXL: Ergonomic design for comfort and protection | Adjustable Energy-Absorbing Rope Line – 20m or 30m | Anchor Strap : 1.5m red 25mm webbing strap with 21kN rating | High-Strength Karabiners | Gear Bag | Eyewear : DP_IRAZUIN | Gloves: DP_VE727NO09.



- Available Options:**
- Roofers Kit S,M,L with 20M Rope line, Eyewear & Gloves: DP_ROOFKIT_DP14GT.20EG
 - Roofers Kit XL, XXL with 20M Rope line, Eyewear & Gloves: DP_ROOFKIT_DP14XX.20EG
 - Roofers Kit S,M,L with 30M Rope line, Eyewear & Gloves: DP_ROOFKIT_DP14GT.30EG
 - Roofers Kit XL, XXL with 30M Rope line, Eyewear & Gloves: DP_ROOFKIT_DP14XX.30EG

AS/NZS1891.1:2020
AS/NZS 1891.5
AS/NZS 1891.3

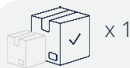

DP_ROOFKIT_DP32MGT.20EG

Roof Workers Kit with Eyewear and Gloves | WAUHAR32 Harness S,M,L or XL,XXL: Ergonomic design for comfort and protection | Adjustable Energy-Absorbing Rope Line – 20m or 30m | Anchor Strap : 1.5m red 25mm webbing strap with 21kN rating | High-Strength Karabiners | Gear Bag | Eyewear : DP_IRAZUIN | Gloves: DP_VE727NO09.



- Available Options:**
- Roofers Kit S,M,L with 20M Rope line, Eyewear & Gloves: DP_ROOFKIT_DP32MGT.20EG
 - Roofers Kit XL, XXL with 20M Rope line, Eyewear & Gloves: DP_ROOFKIT_DP32MXX.20EG
 - Roofers Kit S,M,L with 30M Rope line, Eyewear & Gloves: DP_ROOFKIT_DP32MGT.30EG
 - Roofers Kit XL, XXL with 30M Rope line, Eyewear & Gloves: DP_ROOFKIT_DP32MXX.30EG

AS/NZS1891.1:2020
AS/NZS 1891.5
AS/NZS 1891.3

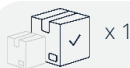

DP_ROOFKIT_DP35MGT.20EG

Roof Workers Kit with Eyewear and Gloves | WAUHAR35 Harness S,M,L or XL,XXL: Ergonomic design for comfort and protection | Adjustable Energy-Absorbing Rope Line – 20m or 30m | Anchor Strap : 1.5m red 25mm webbing strap with 21kN rating | High-Strength Karabiners | Gear Bag | Eyewear : DP_IRAZUIN | Gloves: DP_VE727NO09.



- Available Options:**
- Roofers Kit S,M,L with 20M Rope line, Eyewear & Gloves: DP_ROOFKIT_DP35MGT.20EG
 - Roofers Kit XL, XXL with 20M Rope line, Eyewear & Gloves: DP_ROOFKIT_DP35MXX.20EG
 - Roofers Kit S,M,L with 30M Rope line, Eyewear & Gloves: DP_ROOFKIT_DP35MGT.30EG
 - Roofers Kit XL, XXL with 30M Rope line, Eyewear & Gloves: DP_ROOFKIT_DP35MXX.30EG

Single Lanyard with Tear Web Energy Absorbing

DP_WAUAN203200NN

- Single Lanyard with Tear Web Energy Absorbing
- Harness Connector: Karabiner. Anchor Connector: Karabiner.
- Orange Webbing.



Components	Description	Material	Qty	Weight
DP_WAUAN203200NN	Single Lanyard with Tear Web Energy Absorbing	Polyester	1	0.850

Premium Single Lanyard with Tear Web Energy Absorbing and Elasticised Leg

DP_WAUAN235200NN

- Premium Single Lanyard with Tear Web Energy Absorbing and Elasticised Leg.
- Harness Connector: Karabiner. Anchor Connector: Karabiner.
- Black Webbing with Orange Fleck.



Components	Description	Material	Qty	Weight
DP_WAUAN235200NN	Single Lanyard. Tear Web Energy Absorbing Elasticised Leg	Polyester	1	0.800

Premium Single Lanyard with Tear Web Energy Absorbing and Elasticised Leg

DP_WAUAN235200JJ

- Premium Single Lanyard with Tear Web Energy Absorbing and Elasticised Leg.
- Harness Connector: Snap Hook. Anchor Connector: Snap Hook.
- Black Webbing with Orange Fleck.



Components	Description	Material	Qty	Weight
DP_WAUAN235200JJ	Single Lanyard with Tear Web Energy Absorbing and Elasticised Leg	Polyester	1	1.100

Premium Single Lanyard with Tear Web Energy Absorbing and Elasticised Leg

DP_WAUAN235200JW

- Premium Single Lanyard with Tear Web Energy Absorbing and Elasticised Leg.
- Harness Connector: Snap Hook. Anchor Connector: Rebar Hook.
- Black Webbing with Orange Fleck.



Components	Description	Material	Qty	Weight
DP_WAUAN235200JW	Single Lanyard with Tear Web Energy Absorbing and Elasticised Leg	Polyester	1	1.550

Premium Twin Lanyard with Tear Web Energy Absorbing and Elasticised Legs

DP_WAUAN245200JWW

- Premium Twin Lanyard with Tear Web Energy Absorbing and Elasticised Legs
- Harness Connector: Snap Hook. Anchor Connector: Rebar Hook.
- Black Webbing with Orange Fleck.



Components	Description	Material	Qty	Weight
DP_WAUAN245200JWW	Twin Lanyard with Tear Web Energy Absorbing and Elasticised Legs	Polyester	1	2.400

Got questions? Contact SafetyLink for more information.

1300 789 545

DELTA PLUS EXTENSION STRAP

DP_LV102050

- Extension strap in high tenacity polyester with D-ring.
- Color: Black - Orange
- Width: 45mm.



Components	Description	Material	Qty	Weight
DP_LV102050	Delta Plus Anchorage Device	Polyester	1.5m	0.327kg

TRAUMA RELIEF STRAPS

DP_HA203FS

- Ultra-compact anti-compression strap kit in a reusable textile case to limit femoral compression in the event of a fall.
- Helps maintain normal blood circulation after a fall.
- Color: Black



Components	Description	Material	Qty	Weight
DP_HA203FS	Pair of femoral anti-compression straps	Polyamide	1	0.062kg

ANCHOR SLING

ASTRAP003

- 1.5 metre red 20mm Webbing Anchor Strap.
- Flat construction.
- Rated to 21kN.



Components	Description	Material	Qty	Weight
ASTRAP003	Anchor Strap	Nylon	1.5m	0.062kg

KARABINER

KARBNR034

- High strength aluminium Karabiner.
- Minimum breaking strength Rated 23kN.
- Gate opening 17mm.
- Double action, 16kN Rated gate strength.



Components	Description	Material	Qty	Weight
KARBNR034	Karabiner	Alu	1	0.163

DELTA PLUS GEAR BAG

DP_TC008

- Delta Plus Gear Bag
- Material: PVC
- Size: 80cm x 46cm x 30cm unfolded.



Components	Description	Material	Qty	Weight
DP_TC008	Delta Plus Gear Bag	PVC	1	0.414

ROPE LINE 20M & 30M

ROPELN

- Adjustable Rope Lines available in 20 and 30 metres.
- Light weight alloy Rope Grab.
- 140kg Shock Pack and two Karabiners.



TWO (2) SIZES AVAILABLE

Components	Description	Material	Qty	Weight
ROPELN022	20m Rope Line	Alloy	20m	3.019
ROPELN030	30m Rope Line	Alloy	30m	4.600

TEMPORARY HORIZONTAL SAFETYLINE

SAFETYLYNE_LV201

- Temporary webbing lifeline, allowing to secure two (2) simultaneous users.
- Fall arrest work situations: Movement on lifeline, Restraint, Long horizontal movement on horizontal surface, Long horizontal movement on vertical structure, Short horizontal movement (less than 3m).
- Strap Width (mm): 50mm.
- Size 2.5m - 20m.



Components	Description	Material	Qty	Weight
SAFETYLYNE_LV201	Temporary Horizontal Lifeline	Polyester	1	0.062

- All products must be used within their intended design only.
- Failure to follow all warnings and instructions may result in a serious injury or death.
- Harnesses must be inspected as safe every time before and after each use.
- Six monthly logged safety inspections are to be completed by a competent person (refer to harness care/maintenance instructions).

Got questions? Contact SafetyLink for more information.

1300 789 545



TOOLS

SafetyLink offers a range of essential hand tools and installation accessories designed to support the safe, efficient installation, inspection and maintenance of height safety systems. Developed for use in demanding industrial and construction environments, these tools are engineered to assist installers and technicians in achieving accurate, compliant system setup while improving on-site efficiency. The range complements SafetyLink's broader fall protection systems by ensuring reliable, purpose-built equipment is available for every stage of installation and maintenance work at height.



SCAN ME

www.safetylink.com



SCAN ME

**SAFETY CENTRE
ONLINE TRAINING**

Gesipa Accubird Pro Kit

GESIPA.ACCU.PRO

- Setting force: 13,000 N. Weight: 2.1 kg with battery (2.0 Ah)
- Drive: brushless motor (BLDC). Stroke: 25 mm
- Nosepieces: 17/20, 17/24, 17/27, 17/29, 17/32, 17/36, 17/40 and 17/48, Additional jaw pusher for bigger blind-rivet dimensions
- Blind rivets from O 2.4 mm up to O 6 mm all materials (max. mandrel O 3.7 mm).

Product Code	Description	Qty	Weight
GESIPA.ACCU.PRO	Gesipa Accubird Pro Rivet Tool	1	6



Gesipa Powerbird Pro (Gold) Kit

GESIPA.PB.PRO.GOLD

- Ergonomically and well – proven design – It is equipped with low – wear jaws systems and features. The motor of the PowerBird® Pro Gold Edition has a very long service life, is essentially non-wearing and consistently guarantees the fastest setting frequencies.
- Supplied with 2 CAS 2.0 Ah Li-Ion battery packs and charger in L-BOX with nosepieces: 17/32, 17/36, 17/40 and 17/45. BULB-TITE® Nosepiece 17/48BT in working position.
- Riveter MUST Be Cleaned & Lubricated After Every 50-100 Bulb-Tite Rivets Pulled.

Product Code	Description	Qty	Weight
GESIPA.PB.PRO.GOLD	Gesipa Powerbird Pro Gold Rivet Tool	1	6



Gesipa Hand Tool HN 2-BT

GESIPA001.02

- Used in conjunction with 8mm Tri-fold rivets.
- Drill size 7.8-8.2mm. Length 27.7mm. Grip Range 1.0-9.5mm.
- Technical Data: Stroke: 10mm. Length: 577mm.

Product Code	Description	Qty	Weight
GESIPA001.02	Gesipa Hand Rivet Tool (HN 2-BT)	1	2.071



SafetyLink Hand Rivet Tool

HANDTOOL001

- Designed for installing height safety surface mounted anchor points.
- Lightweight and simple operation.
- Three piece jaws made of CR Mo steel provides long lasting tool life.
- Designed for use with 8mm Tri-fold rivets.
- Waste container for tidy collection of mandrels.
- Supplied with handy hex tool for removing and maintaining nose piece and jaws.
- Maximum Rivet Size: 8mm. Length 320mm.

Product Code	Description	Qty	Weight
HANDTOOL001	SafetyLink Hand Rivet Tool	1	1.200



Rivet - 8mm

- Aluminium Tri-fold Rivets.
- Diameter 7.7mm.

Product Code	Description	Seal	Grip mm	Hole mm	Qty	Weight
RIVET_8mm(27.7)	8mm Tri-fold Rivet	Green	1.1-9.5	7.8-8.2	1	0.007
RIVET_8mm(34)	8mm Tri-fold Rivet	Yellow	6.4-15.9	7.8-8.2	1	0.009
RIVET_8mm(39)	8mm Tri-fold Rivet	Black	9.5-19.1	7.8-8.2	1	0.011



Got questions? Contact SafetyLink for more information.

1300 789 545

Crimping Tool 18V + DIE

STAT.CRIMP_EPB-4301+DIE

- Battery powered Crimping Tool.
- Able to rotate for different working positions.
- Features: 42mm C-Jaw Opening. 360 degrees swivel head.
- For connector, cable lug hexagon crimping.
- Standard die set (total 10pcs): 35/50/70/95/120/150/185/240/300/400mm².
- Battery & Charger Set Model No: B-04 (18V DC Li-Ion Battery/ 4Ah).
- Tool Dimension (reference only): 440(L)*290(W)*78(H)mm.
- Crimping range: 6-400mm (AWG10-750MCM).
- Complete unit with extra Die to crimp 8mm cable (use with STAT.TENSR003, STAT.TENSR005 & STAT.TERMN003).



Product Code	Description	Qty	Weight
STAT.CRIMP_EPB-4301.01	18V Li Ion Battery Crimper 35-400mm (without Batteries/Charger)	1	6.345
STAT.CRIMP_B-04	Battery: 18V 4Ah for EP Crimping Tools (B-04)	1	0.874
STAT.CRIMP_CH-07	Charger: for 18V Battery for EP Crimping Tools (CH-07)	1	0.775
STAT.CRIMP.DIE	Die: for Crimping 8mm Cable	1	0.194

Crimping Tool Die

STAT.CRIMP.DIE

- Die for battery powered crimping tool.
- Required for 8mm Cable, for use with STAT.TENSR003, STAT.TENSR005 and STAT.TERMN003.
- Size A/F10.83.



Product Code	Description	Qty	Weight
STAT.CRIMP.DIE	Die: for Crimping 8mm Cable	1	0.194





LIFELINE CABLE

7x7 wire rope	7x19 wire rope	1x19 wire rope
---------------	----------------	----------------



- | | | |
|--|---|--|
| <ul style="list-style-type: none"> • Standard Flexibility. • For use on all lifelines. | <ul style="list-style-type: none"> • High Flexibility. • For use on lifelines with short intermediate intervals and multiple corners. | <ul style="list-style-type: none"> • Limited Flexibility. • Suited to overhead lines. • Makes for easy transitions over intermediates with SRL's. • Not for use with Swageless Fittings. |
|--|---|--|

LIFELINE CABLE

Product Parts	Description	Qty	Materials
STAT.CABLE001	Cable: 8mm dia, 7x7 wire rope	Per metre	316 SS
STAT.CABLE001.01	Cable: 8mm dia, 7x7 wire rope	305m Roll	316 SS
STAT.CABLE001.02	Cable: 8mm dia, 7x7 wire rope	500m Roll	316 SS
STAT.CABLE_8mm_7x19_SS	Cable: 8mm dia, 7x19 wire rope	Per metre	316 SS
STAT.CABLE_8mm_1x19_SS	Cable: 8mm dia, 1x19 wire rope (DO NOT USE WITH SWAGELESS FITTINGS)	Per metre	316 SS

Got questions? Contact SafetyLink for more information.

1300 789 545

Steps to becoming a qualified SafetyLink product installer

1 Accreditation

Each user must have their Working at Heights accreditation (RIIWH5204D).

The requirements for installation of any fall protection equipment is to be a competent person. The definition of this is someone with suitable skills, knowledge, experience and training in the height safety industry. In order for you to work at heights you must complete a working at heights accreditation. Contact your local training centre.

2 Insurance

Each user/business entity must have correct insurance for installing height safety equipment.

Certification and annual recertification may have an effect on your Public and Products Liability Insurance. Engaging in these activities may also require you to take out or amend your existing Professional Indemnity Insurance. Because policies vary between insurers it is best you speak to your insurance advisor to ensure your coverage will include these activities.

3 Product Training

Each user must complete and pass each course for the product they are purchasing/installing.

SafetyLink's online training portal (Safety Centre) provides online courses on SafetyLink Anchors. Register yourself for free on SafetyLink's website www.safetylink.com/safetycentre. After completing and passing the product course you will receive a certificate to download and provide to your customer. Certificates are valid for 2 years. Personal training is required for installing lifelines, contact SafetyLink.

4 Certification

Issue a certificate for height safety system certification upon completion of the project.

On completion supply certification documents with site layout plan, training certificates, product checklist and manuals to the end user. You should also discuss the wording of any proposed certification with your relevant insurer and legal adviser to ensure you are covered in the event of a claim.

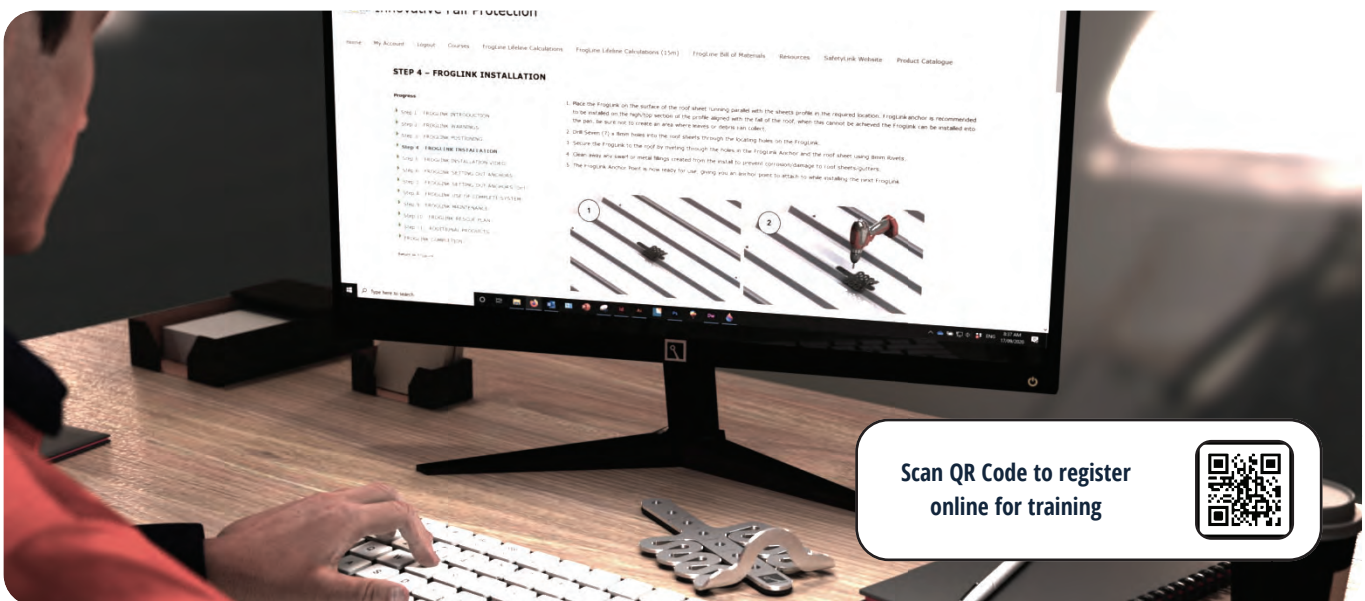

Scan QR Code to register online for training



SafetyLink: BIM-Ready Fall Protection Solutions

As a global leader in fall protection, SafetyLink is proud to offer comprehensive BIM content, making it easier than ever for architects, designers, and engineers to specify and integrate our products into their projects. Our advanced safety systems—including energy-absorbing anchors and engineered lifeline solutions—are designed to exceed industry standards, delivering maximum protection and compliance across a wide range of applications.

Virtual Showroom

Explore our Revit project file (.RVT), featuring preloaded families and types laid out for quick navigation. The file is preformatted for quality assurance, with optimized 2D/3D views and detailed family data to support efficient design and documentation workflows.

Object Collections

Download a collection zip file, containing a curated selection of BIM objects or high-quality product images—ideal for streamlined project planning, visualizations, and presentations.

<https://www.safetylink.com/bim-content/>



Scan Me

BIM CONTENT ONLINE

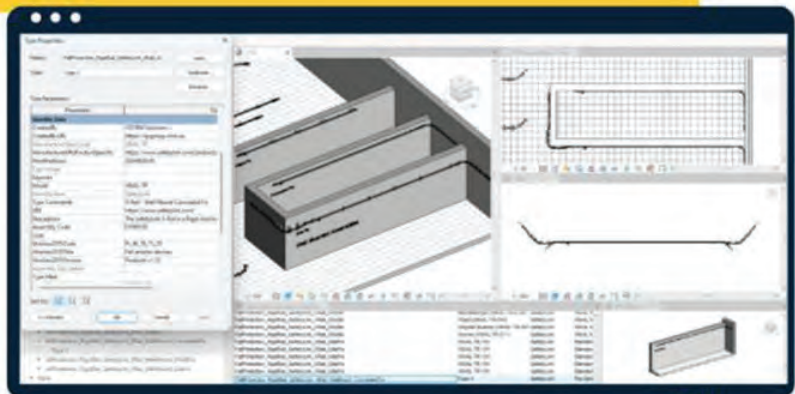

- Native Revit Geometry
- Virtual Showroom Available
- Bulk Download Options

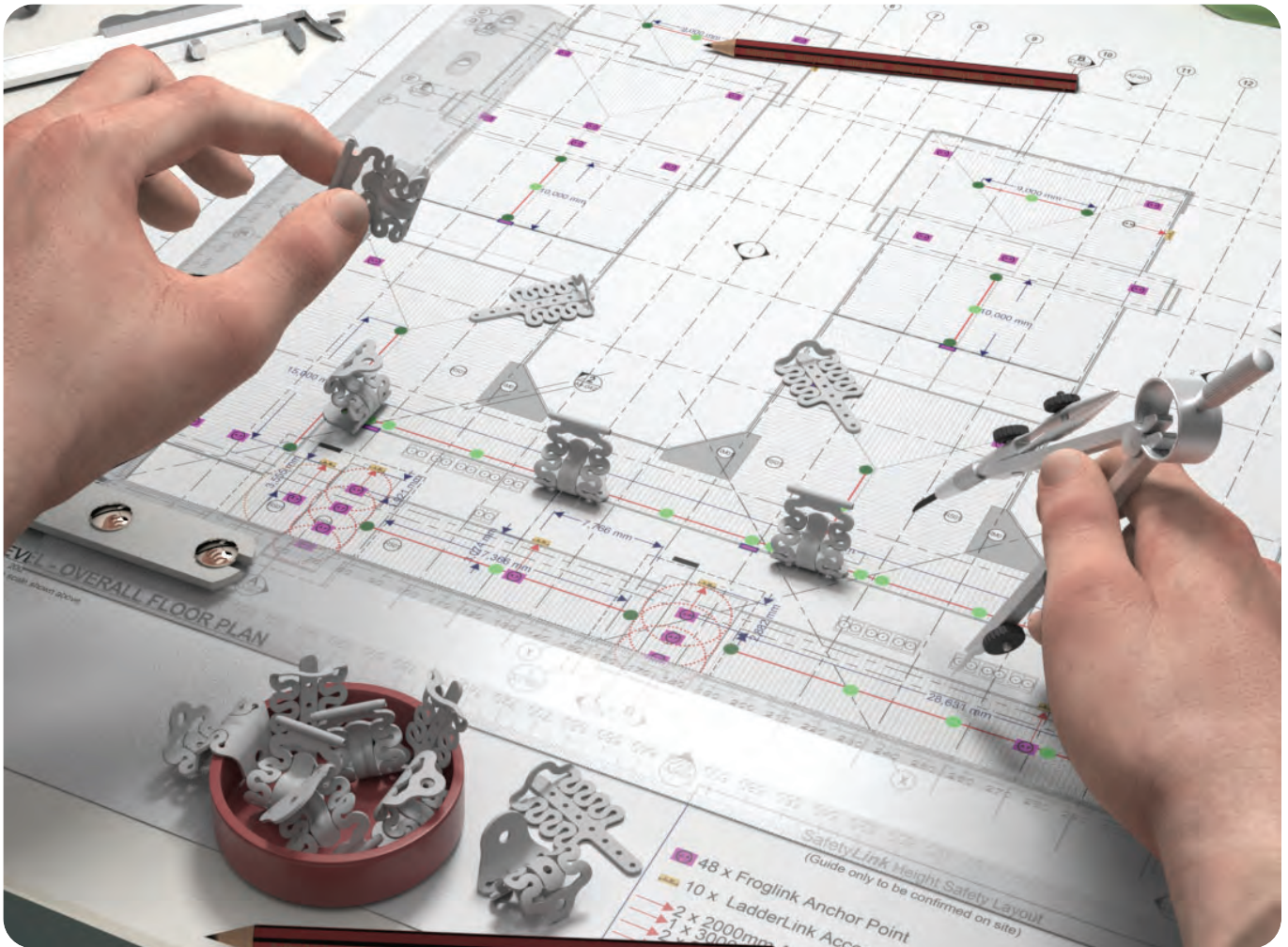

SafetyLink's design and planning team are here to help work out the positioning of your fall protection system, ensuring all areas of your roof are accessed safely.

- Things to consider when planning your roof layout:
- Are all areas of your roof protected, allowing complete access when working at heights?
- Are you protected from the ground up, allowing complete access to your roof?
- Detailed comprehensive documentation provided e.g. installation guides, testing results, product sheets should be provided.
- SafetyLink can also provide you with a qualified and reputable installer of SafetyLink products.

Contact our design team at info@safetylink.com and we can plan your fall arrest system for you.



Expert Fall Protection Planning



Catalogue



SafetyLink Online Training



SafetyLink Website



Designing, manufacturing and
distributing a full range of PPE.

www.deltaplus.com.au



DELTAPLUS

**© 2018, SafetyLink Pty Ltd,
Australia.**
**Patents : SafetyLink Pty Ltd has
a multitude of patents, patents
pending, design applications,
trademarks and copyrighted
documents both lodged and
issued.**
**Should you wish to know the
progress of our intellectual
property on a specific product
please email us on
info@safetylink.com
and quote the product code.**



Asia-Pacific/The Americas

info@safetylink.com

1300 789 545

Europe/Africa/Middle East

export@safetylink.com

+61 (0)2 4964 1068

Northern Europe

export@safetylink.com

+61 (0)2 4964 1068

www.safetylink.com



FS 707792