



*SafetyLink is an innovative anchor company achieving success and keeping you safe whilst working at heights.*

# INSTALLATION HANDBOOK

## ROPEGUIDE BRACKET

- ▲ ROOF ANCHORS
- ▲ HORIZONTAL LIFELINES
- ▲ PERMANENT LADDERS
- ▲ LADDER STABILISERS
- ▲ PERSONAL PROTECTIVE EQUIPMENT
- ▲ RAIL - ALTIRAIL
- ▲ RAIL - ULTRA HORIZONTAL RAIL
- ▲ RAIL - X-RAIL HORIZONTAL RAIL
- ▲ TEMPORARY ANCHORS
- ▲ WALKWAY & GUARDRAIL

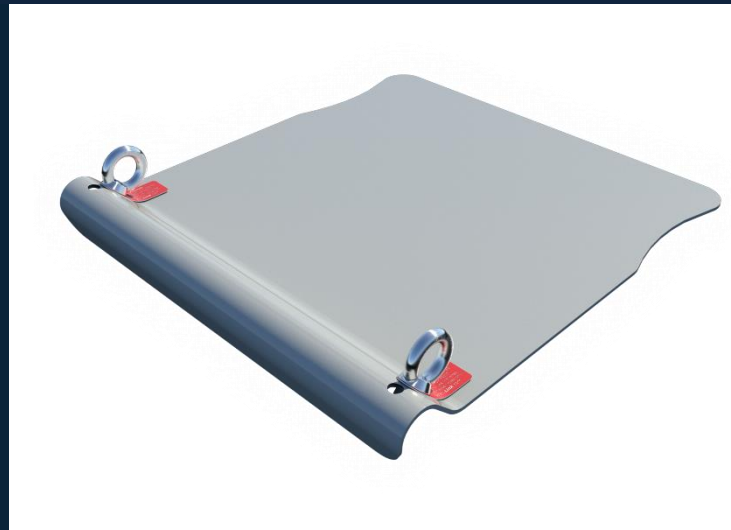

**Read entire handbook before installing SafetyLink products. All products must be installed in accordance with SafetyLink's installation handbook, using only products supplied by SafetyLink Pty Ltd. Failure to follow all warnings and instructions may result in serious injury or death.**

# TABLE OF CONTENTS

## INSTALLATION OF SAFETYLINK ROPE GUIDE BRACKET

WARNINGS .....	3
MAINTENANCE – PERIODIC INSPECTIONS .....	4
FIXED LADDERLINK: LADDER SUPPORT BRACKET .....	4
SAFETYLINK ANCHORAGES .....	4
WARRANTIES.....	5
ROPE GUIDE BRACKET.....	6
ROPE GUIDE BRACKET .....	6
INSTALLATION FOR METAL ROOFS – UNDER ROOF SHEETING .....	7
INSTALLATION FOR METAL ROOFS – ON TOP OF ROOF SHEETING .....	8
APPENDIX – DIAGRAM 2 – ANCHOR POSITIONING LAYOUT.....	9
EXPERT FALL PROTECTION PLANNING .....	10
NOTES .....	11
IN CASE OF ACCIDENT .....	12

### ATTACHED: MAINTENANCE INSPECTION CHECKLIST

# WARNINGS

## READ CAREFULLY SOMEONE'S LIFE DEPENDS ON IT

- ⚠ Improper Use, Installation or Maintenance may result in serious injury or death.
  - ⚠ The structure or anchorage to which SafetyLink products are to be installed shall be assessed by a professional engineer to ensure it has adequate strength to support the product.
  - ⚠ SafetyLink products shall be installed, used and maintained in accordance with the applicable SafetyLink installation and use manual.
  - ⚠ SafetyLink's product shall be used in accordance with the current working at height standards, codes of practice, regulation or legislation in the region of use.
  - ⚠ During installation, use and maintenance, personnel shall not be exposed to a fall hazard.
  - ⚠ Installation is to be carried out by, or under the supervision of, a competent person.
  - ⚠ The installer shall complete the applicable SafetyLink online training modules before installing this product.
  - ⚠ Connection systems used with SafetyLink Anchor, Lifelines and Rigid Rail Systems shall contain a personal energy absorber.
  - ⚠ Do not carry out any modifications to this product without written permission from SafetyLink.
- Recommended waterproofing for roof tiles: Sika Flex Co-Polymer Sealant.
  - Recommended waterproofing for metal roof: Silicone Sealant.

*SafetyLink's Rope Guide Bracket is uniquely designed to mimic the protective properties of our patented Fixed LadderLink.*

- *Made from Marine Grade Aluminium.*
- *Protects your ropes being damaged when abseiling over a sharp edge or gutter.*
- *Guides your ropes.*
- *Protects the guttering systems from rope pressure and damage.*
- *Easy to install and unobtrusive.*
- *Can be permanently installed or removed after use.*
- *One person user.*

*The Rope Guide Bracket has two collared eyebolts attached, these are not to be used as load rated anchors in any situation. The collared eyebolts are present to ensure that the abseil ropes will stay in the desired location and do not slip from the bracket. It is recommended that a strap be used between the collared eyebolts to secure the abseil ropes, so they cannot unintentionally leave the Rope Guide Bracket.*



Safety Centre  
Training



Catalogue



Website

# MAINTENANCE – PERIODIC INSPECTIONS

All items of height safety equipment which are in regular use shall be subjected to periodic inspection and servicing. These regular scheduled inspections and servicing must be carried out by a competent height safety installer.

## **FIXED LADDERLINK: LADDER SUPPORT BRACKET**

**ALL LADDERLINKS MUST BE INSPECTED EVERY 12 MONTHS, INSPECTIONS NEED TO BE CARRIED OUT BY A COMPETENT HEIGHT SAFETY INSTALLER.**

Procedures to be followed at inspection time:

- Visually inspect ladder support brackets for any signs of deterioration or the protective coating being removed. *(Note: LadderLink is made from marine grade aluminium and therefore should not corrode).*
- Ensure LadderLink is firmly secured to the structure as per SafetyLink Installation Handbook. *(refer to [Installing LadderLink](#)).*

## **SAFETYLINK ANCHORAGES**

**ALL ANCHORAGES MUST BE INSPECTED EVERY TWELVE MONTHS, INSPECTIONS NEED TO BE CARRIED OUT BY A COMPETENT HEIGHT SAFETY INSTALLER.**

Procedures to be followed at inspection time:

- Visually inspect anchors for signs of deterioration.
- The FrogLink/TileLink anchor point has two energy absorbing regions and two stabilising joins which hold the eyelet in place during use. If these energy absorbing regions are expanded this will indicate the anchor point has arrested a fall. Similarly, if the two stabilising joins have been broken this would also indicate the FrogLink/TileLink has arrested a fall and should be replaced.
- The eyebolt should remain straight, a bent eyebolt will indicate that the anchor point has arrested a fall *(The design features of the eyebolt includes the ability to bend like a fishing pole starting from the top and working its way to the bottom, enabling it to use up energy as the eyebolt bends whilst lessening the force on the person falling and the attachment point).*
- Visually inspect the components of the anchor for corrosion, superficial surface marking is permitted while deeper corrosion or pitting would require attention.
- Manually (by hand) check the eyebolt for rigidity and tightness, if the eyebolt can turn in the anticlockwise direction it will require attention.
- Visually inspect the rubber hat washer and waterproofing components to ensure it has remained sealed.
- Visually inspect the attachment component of the anchorage where practically possible.
- Visually inspect the parent structure for modifications or deterioration which might lead to loss of anchorage strength.
- For Concrete Installation Only: To comply with Australian Standards, each Concretelink must be tested after installation and at every recertification inspection. Ensure you wait the recommended curing time as specified by the chemical anchor instructions. The pull test can be done using a 16mm threaded eyebolt. Test consists of ultimate pull out force proof loading to 50% of design purpose of anchorage.
- A personal energy absorber or a fall-arrest device with a personal energy absorber must be used in conjunction with all SafetyLink Anchorages and Lifeline systems.

**IN ADDITION TO SAFETYLINK PTY LTD EQUIPMENT, ALL ANCILLARY EQUIPMENT MUST BE INSPECTED IN ACCORDANCE WITH APPLICABLE REGULATORY REQUIREMENTS AND THE MANUFACTURER'S INSTRUCTIONS.**



**FOR MAINTENANCE ADVICE AND SERVICES PLEASE CONTACT SAFETYLINK  
ON +61 249 641068 OR 1300 789545 FOR YOUR NEAREST SAFETYLINK INSPECTION SERVICE  
CENTRE OR EMAIL: [info@safetylink.com](mailto:info@safetylink.com)**

# WARRANTIES

## EXTRACT: SafetyLink Pty Ltd STANDARD TERMS AND CONDITIONS

- 11.1 To the extent permitted by law all implied conditions, warranties and undertakings are expressly excluded.
- 11.2 Except as provided in this clause the Company shall not be liable for any loss or damage, whether direct or indirect (including consequential losses or damage) arising out of any breach of contract by the Company or any negligence of the Company, its employees or agents.
- 11.3 Should the Company be liable for a breach of a guarantee, condition or warranty implied by the Australian Consumer Law (not being a guarantee, condition or warranty implied by sections 51, 52 and 53 of that Law) then its liability for a breach of any such condition or warranty express or implied shall be limited, at its option, to any one or more of the following.
- A) in case of Goods
    - (I) the replacement of the Goods or the supply of equivalent Goods.
    - (II) the repair of the goods,
    - (III) the payment of the cost of replacing the Goods or acquiring equivalent Goods.
    - (IV) The payment of the cost of having the Goods repaired.Provided that any such Goods are returned to the Company by the Purchaser at the Purchaser's expense.
  - B) in the case of services
    - (i) the supply of the services again,
    - (ii) the payment of the cost of having the services supplied again.
- 11.4 The Company will not be liable for the costs of recovery of the Goods from the field, loss of use of the Goods, loss of time, inconvenience, incidental or consequential loss or damage, nor for any other loss or damage other than as stated above, whether ordinary or exemplary, caused either directly or indirectly by use of the Goods.
- 11.5 The Company warrants that at the time of shipment, Products manufactured by it will be free from defects in material and workmanship. In the absence of a modified written warranty, the Company agrees to making good any such defects by repairing the same or at the Company's option by replacement, for a period of (1) one year from the date of shipment. This limited warranty applies provided that:
- (a) defects have arisen solely from faulty materials or workmanship;
  - (b) the Products have not received maltreatment, inattention or interference;
  - (c) **the Products have been installed in accordance with the Company's Installation Handbooks using only products supplied by the Company;**
  - (d) accessories used with the Products are manufactured by or approved by the Company;
  - (e) the Products are maintained in accordance with Australian Standard 1891.4 (section 9).
  - (f) you notify any claim under this warranty to SafetyLink in writing to the address below no later than 14 days after the event or occurrence concerning the product giving rise to the claim and you pay all costs related to your claim.
- This warranty does not apply to any defects or other malfunctions caused to the Goods by accident, neglect, vandalism, misuse, alteration, modification or unusual physical, environment or electrical stress.
- Please note that the benefits to the purchaser (as a consumer) given by this warranty are in addition to your other rights and remedies under the Australian Consumer Law. Our goods come with guarantees that cannot be excluded under the Australian Consumer Law. You are entitled to a replacement or refund for a major failure and compensation for any other reasonably foreseeable loss or damage. You are also entitled to have the goods repaired or replaced if the goods fail to be of acceptable quality and the failure does not amount to a major failure.
- 11.6 If any goods are not manufactured by the Company, the guarantee of the manufacturer thereof shall be accepted by the Purchaser as the only express warranty given in respect of the goods.
- 11.7 Except as provided in this clause 11, all express and implied warranties, guarantees and conditions under statute or general law as the merchantability, description, quality, suitability or fitness of the Products for any purpose or as to design, assembly, installation, materials or workmanship or otherwise are hereby expressly excluded (to the extent to which they may be excluded by law).

PLEASE SEE SAFETYLINK PTY LTD FULL STANDARD TERMS OF CONDITIONS OF SALE FOR FURTHER REFERENCE.

# ROPE GUIDE BRACKET

Product Code: LADFX007

All safety procedures must comply in accordance with the current legislation and regulations. Ensure safety at all times by being attached to suitable anchor points and approved safety equipment or approved scaffolding.

## ROPE GUIDE BRACKET

Made from marine grade aluminium the rope guide bracket is designed to guide a user's rope over the building and protect them from any sharp edges. SafetyLink's Rope Guide Bracket is uniquely designed to mimic the protective properties of our patented Fixed Rope Guide Bracket.

Using the Rope Guide Bracket will prevent rope damage when abseiling over sharp edges or guttering systems. Conversely the bracket will prevent damage to the gutter when in use, expertly guiding the rope's exactly where you want them. The rope guide bracket is easy to install on any buildings' façade and can be painted to blend in completely. It can also be removed with ease.

Bracket may need to be adjusted to suit different roof pitches.

- ⚠ **Adjusting the pitch of the Rope Guide Bracket is to be done by a sheet metal fabricators' bending machine. The Rope Guide Bracket is made from high tensile aluminium therefore ensure the bender is set on a high radius to prevent cracking.**
- ⚠ **Protective coating must not be removed.**

**The Rope Guide Bracket has two collared eyebolts attached, these are not to be used as load rated anchors in any situation.** The collared eyebolts are present to ensure that the abseil ropes will stay in the desired location and do not slip from the bracket. It is recommended that a strap be used between the collared eyebolts to secure the abseil ropes, so they cannot unintentionally leave the Rope Guide Bracket.

- Made from Marine Grade Aluminium.
- Protects your ropes from being damaged when abseiling over a sharp edge or gutter.
- Guides your ropes.
- Protects the guttering systems from rope pressure and damage.
- Easy to install and unobtrusive.
- Can be permanently installed or removed after use.
- **Note: One person use.**

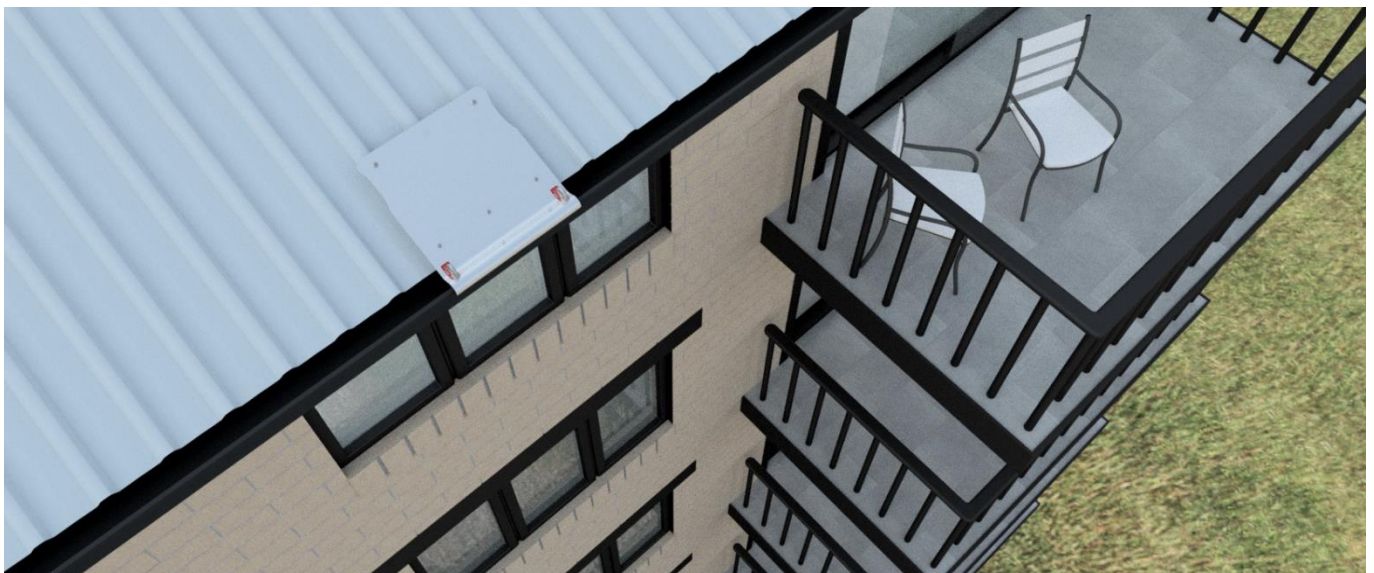

# Rope Guide Bracket – Installation under Roof Sheeting

## INSTALLATION FOR METAL ROOFS – UNDER ROOF SHEETING

1. To install the Rope Guide Bracket simply remove existing hex head roofing screws along the bottom edge of the roof sheeting at the desired location.
2. Slide the Rope Guide Bracket under the roof sheeting between the sheeting and batten as shown in the diagram below.
3. Position the Rope Guide Bracket so the rolled section is centred over the gutters front edge.
4. Once the ladder bracket is in the desired location, re-install the hex head roofing screws through the original holes, through the Rope Guide Bracket and into the roof batten below.
5. Ensure that a minimum of three (3) x 12g 65mm roofing screws anchor the Rope Guide Bracket to the structure (recommended to pilot drill holes).

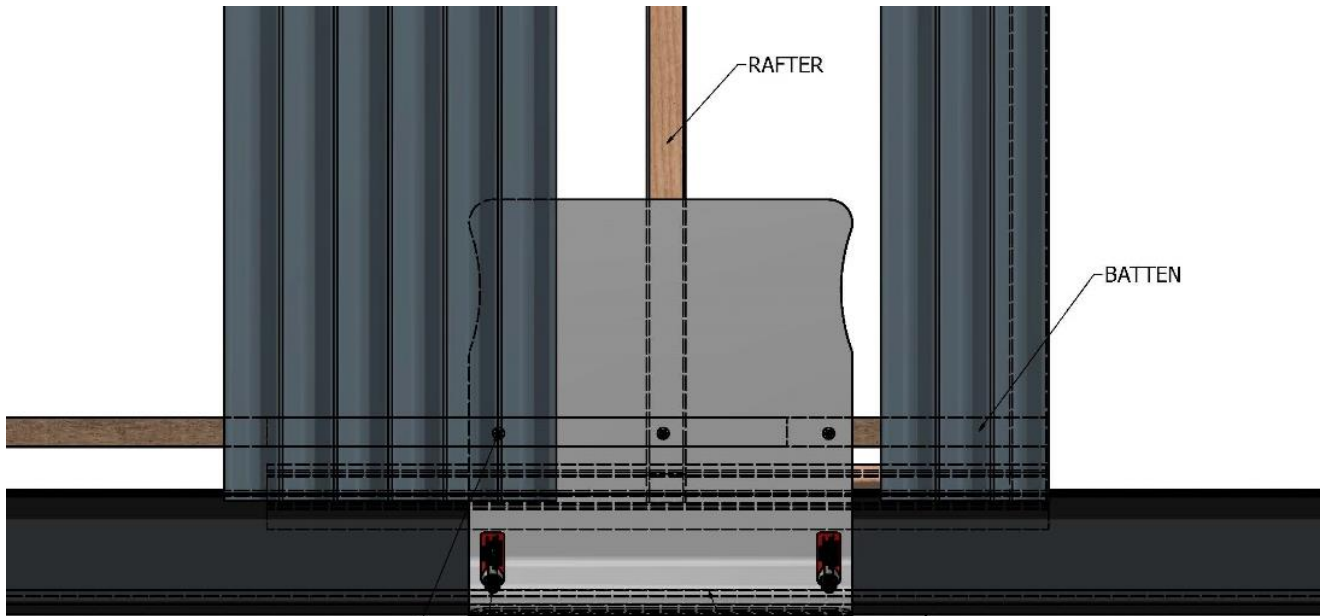

USE THREE 12g x 65mm ROOFING SCREWS INTO THE BATTEN

EYELETS ARE NOT RATED AS ANCHOR POINTS. EYELETS FOR USE WITH STRAP TO CONTAIN ABSEIL ROPES ONLY

ROPE GUIDE BRACKET

GUTTER

USE THREE 12g x 65mm ROOFING SCREWS INTO THE BATTEN

EYELETS ARE NOT RATED AS ANCHOR POINTS. EYELETS FOR USE WITH STRAP TO CONTAIN ABSEIL ROPES ONLY

ROPE GUIDE BRACKET

GUTTER

FASCIA BOARD

RAFTER

BATTEN

# Rope Guide Bracket – Installation on top of Roof Sheeting

## INSTALLATION FOR METAL ROOFS – ON TOP OF ROOF SHEETING

1. To install the Rope Guide Bracket simply remove existing hex head roofing screws along the bottom edge of the roof sheeting at the desired location.
2. Place the Rope Guide Bracket on top of the roof sheeting as shown in the diagram below.
3. Position the Rope Guide Bracket so the rolled section is centred over the gutters front edge.
4. Once the Rope Guide Bracket is in the desired location, re-install the hex head roofing screws through the Rope Guide Bracket, ensure the screws go through the roof sheeting and into the roof batten below.
5. Ensure that a minimum of three (3) x 12g 65mm roofing screws anchor the Rope Guide Bracket to the structure (recommended to pilot drill holes).
6. Install an additional two (2) x 8mm Rivets at the top corners 50mm down from the top edge, see below diagram. This must be completed to prevent rocking of the Rope Guide Bracket.

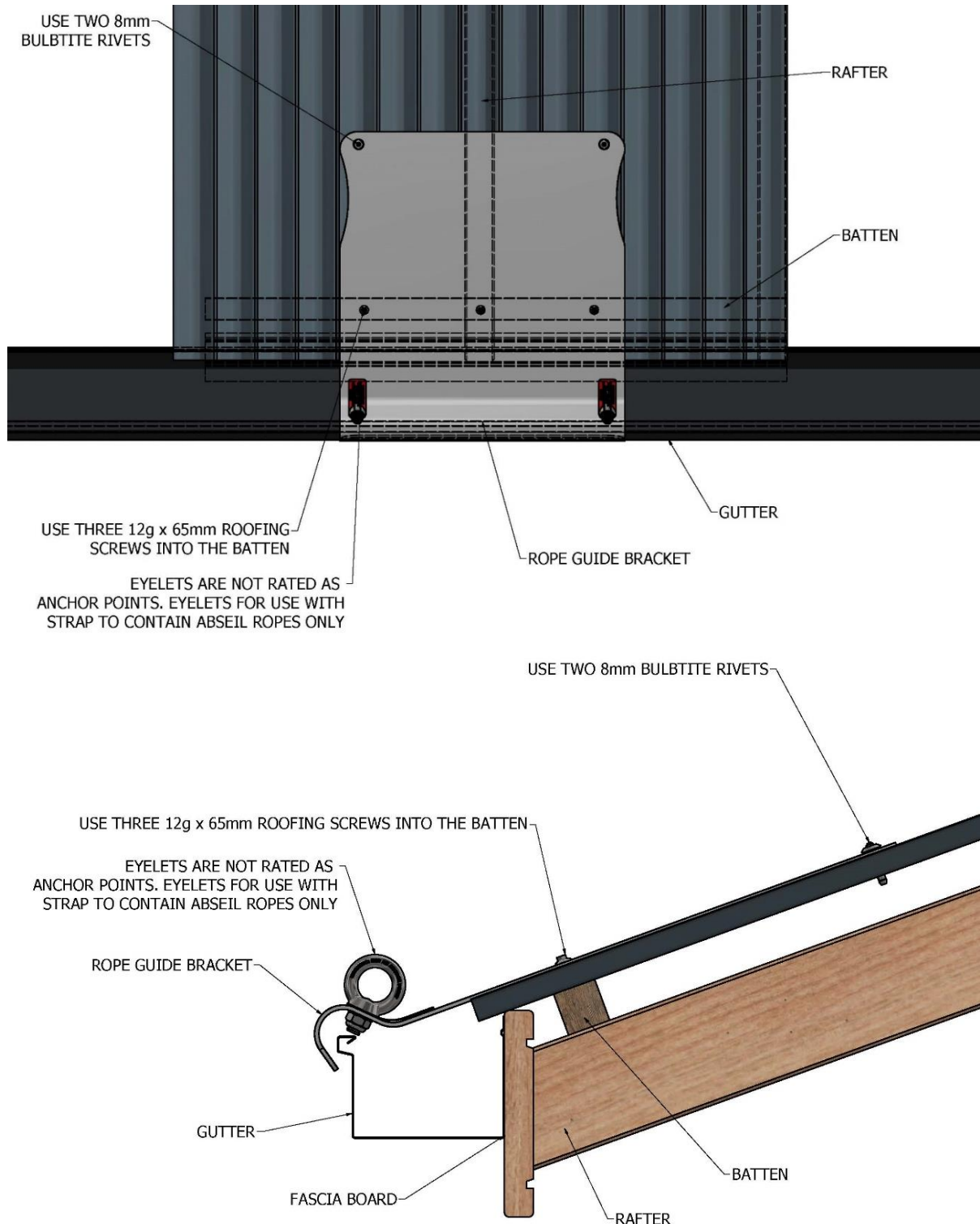

# APPENDIX – Diagram 2 – Anchor Positioning Layout

## THIS IS A GUIDE ONLY

All working at heights safety procedures must be complied with when installing SafetyLink anchor points. For more information refer to your state or territories current legislation, regulations, policies and codes of practices.

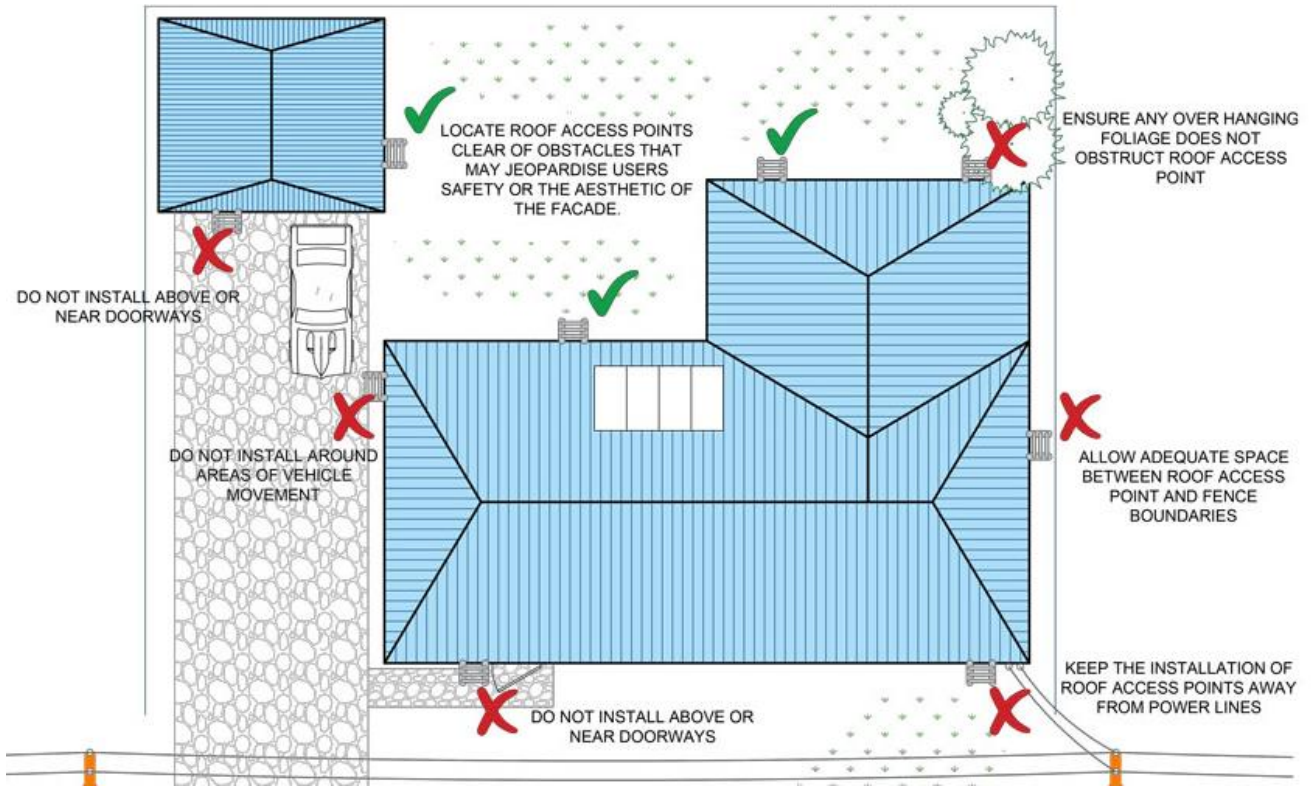

- ⚠ IF ANY DOUBT EXISTS WITH THE STRENGTH OF THE STRUCTURE OR ROOF SHEETS AN ENGINEER SHOULD MAKE THE ASSESSMENT.
- ⚠ DURING INSTALLATION YOU MUST BE SAFE AT ALL TIMES.
- ⚠ INSTALLATION MUST BE CARRIED OUT BY, OR UNDER THE SUPERVISION OF A COMPETENT HEIGHT SAFETY INSTALLER.

### ACCESS, LAYOUT AND USE OF A SAFETYLINK ANCHOR SYSTEM

SafetyLink anchor points are positioned by calculating the pendulum effect, this limits the likelihood of a fall past the edge of the roof space. The pendulum effect still applies to a flat roof.

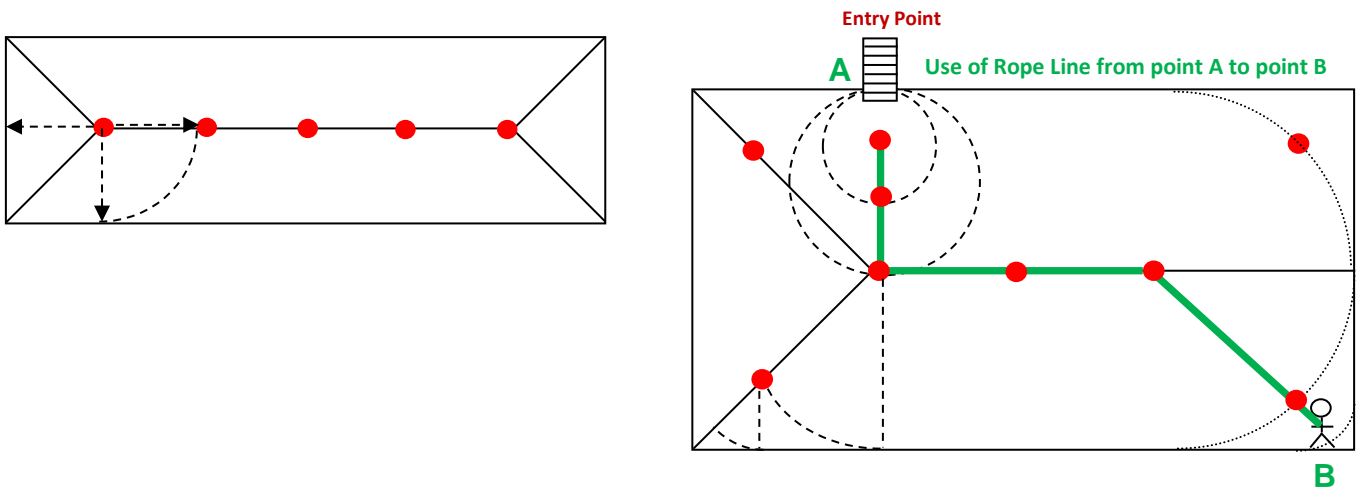

SPACING MUST BE NO GREATER THAN THE RAFTER LENGTH, PLEASE CONTACT YOUR DISTRIBUTOR IF YOU ARE UNSURE.

SAFETYLINK HEIGHT SAFETY SYSTEMS MUST ONLY BE INSTALLED AS PER OUR INSTALLATION GUIDES, TO STRUCTURES AS SPECIFIED IN THE INSTALLATION MANUAL FOR EACH PRODUCT. SHOULD ANY DOUBT EXIST IN REGARD TO THE STRUCTURES INTEGRITY AN ENGINEER SHOULD BE CONSULTED.

# EXPERT FALL PROTECTION PLANNING

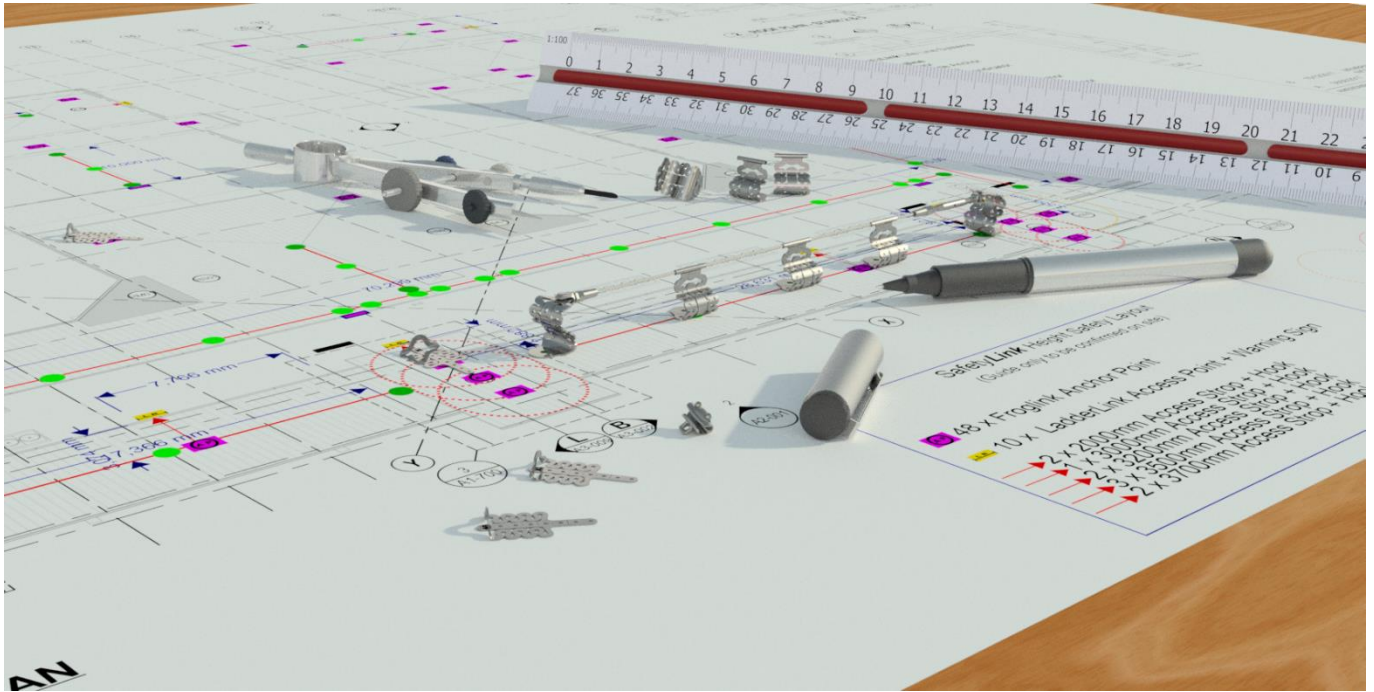

SafetyLink's design and planning team are here to help work out the positioning of your fall protection system, ensuring all areas of your roof are accessed safely.

Things to consider when planning your roof layout:

- Are all areas of your roof protected, allowing complete access when working at heights?
- Are you protected from the ground up, allowing complete access to your roof?
- Detailed comprehensive documentation provided e.g. installation guides, testing results, product sheets should be provided.
- SafetyLink can also provide you with a qualified and reputable installer of SafetyLink products.

Contact our design team at [info@safetylink.com](mailto:info@safetylink.com) and we can plan your fall arrest system for you.

# NOTES

# IN CASE OF ACCIDENT

- ⚠️ **A FALL RESCUE PLAN AND SAFE WORK STATEMENT MUST BE DEVELOPED PRIOR TO USING SAFETYLINK SYSTEMS AND EQUIPMENT.**
- ⚠️ **PERSONS WORKING AT HEIGHTS SHOULD NOT WORK ALONE.**

It is critical that before using any SafetyLink Systems a fall rescue plan is in place for any persons suspended mid-air following a fall. Serious injury or death can occur in a matter of minutes, particularly if a person’s movement or breathing is restricted or loss of consciousness has occurred. In accordance with your fall rescue plan and appropriate first aid procedures it is essential to remove the person from the suspended position as quickly as possible.

*In accordance with AS/NZS 1891.4:2009 clause 9.5*

## EQUIPMENT WHICH HAS ARRESTED A FALL OR SHOWS A DEFECT

Any piece of equipment including both personal and permanently installed items, which has been used to arrest a fall or which shows any defect during operator or periodic inspection shall be withdrawn from service immediately and a replacement obtained if necessary. A label indicating the condition or defect should be attached to the equipment, and it should be examined by a competent height safety installer who will decide whether the equipment is to be destroyed or repaired if necessary and returned to service. In the latter case, details of any repair shall be documented, and a copy given to the operator.



SafetyLink Pty Ltd | ABN 83 081 777 371 | [www.safetylink.com](http://www.safetylink.com)

**DISTRIBUTOR:**

Asia-Pacific/The Americas | +61 2 4964 1068 | [info@safetylink.com](mailto:info@safetylink.com)  
Europe/Africa/Middle East | [europe.sales@safetylink.com](mailto:europe.sales@safetylink.com)  
Northern Europe | [uk.sales@safetylink.com](mailto:uk.sales@safetylink.com)