



*SafetyLink is an innovative anchor company achieving success and keeping you safe whilst working at heights.*

# INSTALLATION HANDBOOK

## FROGLINK (S5-Z)

### SURFACE MOUNTED ANCHOR

- ▲ ROOF ANCHORS
- ▲ HORIZONTAL LIFELINES
- ▲ PERMANENT LADDERS
- ▲ LADDER STABILISERS
- ▲ PERSONAL PROTECTIVE EQUIPMENT
- ▲ RAIL - ALTIRAIL
- ▲ RAIL - ULTRA HORIZONTAL RAIL
- ▲ RAIL - X-RAIL HORIZONTAL RAIL
- ▲ TEMPORARY ANCHORS
- ▲ WALKWAY & GUARDRAIL

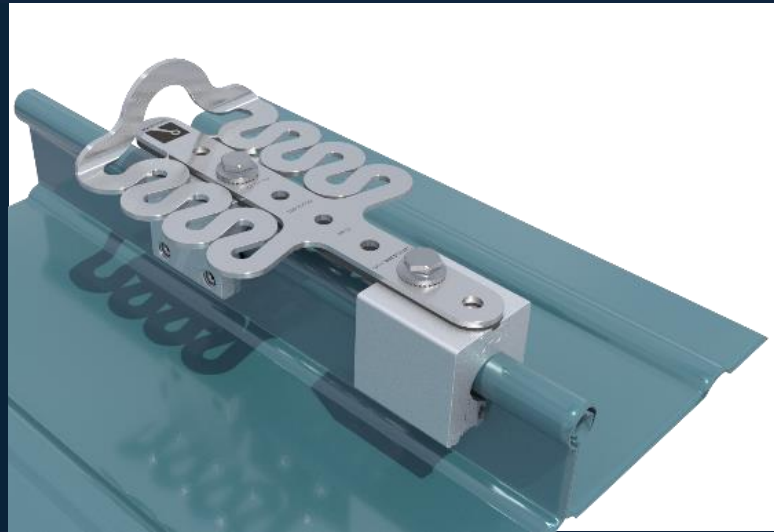

**Read entire handbook before installing SafetyLink products. All products must be installed in accordance with SafetyLink's installation handbook, using only products supplied by SafetyLink Pty Ltd. Failure to follow all warnings and instructions may result in serious injury or death.**

# TABLE OF CONTENTS

## INSTALLATION OF SAFETYLINK FROGLINK ANCHOR WITH S5-Z CLAMPS

- WARNINGS ..... 3
- MAINTENANCE – PERIODIC INSPECTIONS ..... 4
  - FIXED LADDERLINK: LADDER SUPPORT BRACKET ..... 4
  - SAFETYLINK ANCHORAGES ..... 4
- WARRANTIES ..... 5
- FROGLINK ANCHOR UNIT ..... 6
  - COMPONENTS ..... 6
  - INSPECT THE INTEGRITY OF THE STRUCTURE AND ROOF SHEETING ..... 6
  - POSITIONING FROGLINK ANCHOR POINTS ..... 7
  - INSTALLATION: TO THE SURFACE OF A METAL ROOF SHEET ..... 7
- APPENDIX 1 – S-5 CLAMPS ..... 8
- APPENDIX 1 – S-5 CLAMPS ..... 9
- APPENDIX 2 – Anchor Positioning Layout ..... 10
- EXPERT FALL PROTECTION PLANNING ..... 11
- IN CASE OF ACCIDENT ..... 12

ATTACHED: MAINTENANCE INSPECTION CHECKLIST



# WARNINGS

## READ CAREFULLY SOMEONE'S LIFE DEPENDS ON IT

- ⚠ Improper Use, Installation or Maintenance may result in serious injury or death.
- ⚠ The structure or anchorage to which SafetyLink products are to be installed shall be assessed by a professional engineer to ensure it has adequate strength to support the product.
- ⚠ SafetyLink products shall be installed, used and maintained in accordance with the applicable SafetyLink installation and use manual.
- ⚠ SafetyLink's product shall be used in accordance with the current working at height standards, codes of practice, regulation or legislation in the region of use.
- ⚠ During installation, use and maintenance, personnel shall not be exposed to a fall hazard.
- ⚠ Installation is to be carried out by, or under the supervision of, a competent person.
- ⚠ The installer shall complete the applicable SafetyLink online training modules before installing this product.
- ⚠ Connection systems used with SafetyLink Anchor, Lifelines and Rigid Rail Systems shall contain a personal energy absorber.
- ⚠ Do not carry out any modifications to this product without written permission from SafetyLink.
- ⚠ **MAXIMUM USER PER FROGLINK IS ONE (1).**

- Recommended waterproofing for roof tiles: Sika Flex Co-Polymer Sealant.
- Recommended waterproofing for metal roof: Silicone Sealant.
- STANDARD EYEBOLTS MUST ONLY BE USED AS A FALL ARREST ANCHOR.
- ABSEILING EYEBOLTS ARE TO BE USED FOR ROPE ACCESS (ABSEILING).
- SURFACE MOUNTED ANCHORS MUST NOT BE USED FOR ROPE ACCESS (ABSEILING).
- RETRO EYEBOLTS USED FOR ROPE ACCESS (ABSEILING) EXCEPT ON HIGH PROFILE SECTION.



Safety Centre  
Training



Installation Guide



Anchor Layout  
Video



Catalogue



Website

# MAINTENANCE – PERIODIC INSPECTIONS

All items of height safety equipment which are in regular use shall be subjected to periodic inspection and servicing. These regular scheduled inspections and servicing must be carried out by a competent height safety installer.

## **FIXED LADDERLINK: LADDER SUPPORT BRACKET**

**ALL LADDERLINKS MUST BE INSPECTED EVERY 12 MONTHS, INSPECTIONS NEED TO BE CARRIED OUT BY A COMPETENT HEIGHT SAFETY INSTALLER.**

Procedures to be followed at inspection time:

- Visually inspect ladder support brackets for any signs of deterioration or the protective coating being removed. *(Note: LadderLink is made from marine grade aluminium and therefore should not corrode).*
- Ensure LadderLink is firmly secured to the structure as per SafetyLink Installation Handbook. *(refer to [Installing LadderLink](#)).*

## **SAFETYLINK ANCHORAGES**

**ALL ANCHORAGES MUST BE INSPECTED EVERY TWELVE MONTHS, INSPECTIONS NEED TO BE CARRIED OUT BY A COMPETENT HEIGHT SAFETY INSTALLER.**

Procedures to be followed at inspection time:

- Visually inspect anchors for signs of deterioration.
- The FrogLink/TileLink anchor point has two energy absorbing regions and two stabilising joints which hold the eyelet in place during use. If these energy absorbing regions are expanded this will indicate the anchor point has arrested a fall. Similarly, if the two stabilising joints have been broken this would also indicate the FrogLink/TileLink has arrested a fall and should be replaced.
- The eyebolt should remain straight, a bent eyebolt will indicate that the anchor point has arrested a fall *(The design features of the eyebolt includes the ability to bend like a fishing pole starting from the top and working its way to the bottom, enabling it to use up energy as the eyebolt bends whilst lessening the force on the person falling and the attachment point).*
- Visually inspect the components of the anchor for corrosion, superficial surface marking is permitted while deeper corrosion or pitting would require attention.
- Manually (by hand) check the eyebolt for rigidity and tightness, if the eyebolt can turn in the anticlockwise direction it will require attention.
- Visually inspect the rubber hat washer and waterproofing components to ensure it has remained sealed.
- Visually inspect the attachment component of the anchorage where practically possible.
- Visually inspect the parent structure for modifications or deterioration which might lead to loss of anchorage strength.
- For Concrete Installation Only: To comply with Australian Standards, each Concretelink must be tested after installation and at every recertification inspection. Ensure you wait the recommended curing time as specified by the chemical anchor instructions. The pull test can be done using a 16mm threaded eyebolt. Test consists of ultimate pull out force proof loading to 50% of design purpose of anchorage.
- A personal energy absorber or a fall-arrest device with a personal energy absorber must be used in conjunction with all SafetyLink Anchorages and Lifeline systems.

**IN ADDITION TO SAFETYLINK PTY LTD EQUIPMENT, ALL ANCILLARY EQUIPMENT MUST BE INSPECTED IN ACCORDANCE WITH APPLICABLE REGULATORY REQUIREMENTS AND THE MANUFACTURER'S INSTRUCTIONS.**



**FOR MAINTENANCE ADVICE AND SERVICES PLEASE CONTACT SAFETYLINK  
ON +61 249 641068 OR 1300 789545 FOR YOUR NEAREST SAFETYLINK INSPECTION SERVICE  
CENTRE OR EMAIL: [info@safetylink.com](mailto:info@safetylink.com)**

# WARRANTIES

## EXTRACT: SafetyLink Pty Ltd STANDARD TERMS AND CONDITIONS

- 11.1 To the extent permitted by law all implied conditions, warranties and undertakings are expressly excluded.
- 11.2 Except as provided in this clause the Company shall not be liable for any loss or damage, whether direct or indirect (including consequential losses or damage) arising out of any breach of contract by the Company or any negligence of the Company, its employees or agents.
- 11.3 Should the Company be liable for a breach of a guarantee, condition or warranty implied by the Australian Consumer Law (not being a guarantee, condition or warranty implied by sections 51, 52 and 53 of that Law) then its liability for a breach of any such condition or warranty express or implied shall be limited, at its option, to any one or more of the following.
- A) in case of Goods
- (I) the replacement of the Goods or the supply of equivalent Goods.
  - (II) the repair of the goods,
  - (III) the payment of the cost of replacing the Goods or acquiring equivalent Goods.
  - (IV) The payment of the cost of having the Goods repaired.
- Provided that any such Goods are returned to the Company by the Purchaser at the Purchaser's expense.
- B) in the case of services
- (i) the supply of the services again,
  - (ii) the payment of the cost of having the services supplied again.
- 11.4 The Company will not be liable for the costs of recovery of the Goods from the field, loss of use of the Goods, loss of time, inconvenience, incidental or consequential loss or damage, nor for any other loss or damage other than as stated above, whether ordinary or exemplary, caused either directly or indirectly by use of the Goods.
- 11.5 The Company warrants that at the time of shipment, Products manufactured by it will be free from defects in material and workmanship. In the absence of a modified written warranty, the Company agrees to making good any such defects by repairing the same or at the Company's option by replacement, for a period of (1) one year from the date of shipment. This limited warranty applies provided that:
- (a) defects have arisen solely from faulty materials or workmanship;
  - (b) the Products have not received maltreatment, inattention or interference;
  - (c) **the Products have been installed in accordance with the Company's Installation Handbooks using only products supplied by the Company;**
  - (d) accessories used with the Products are manufactured by or approved by the Company;
  - (e) the Products are maintained in accordance with Australian Standard 1891.4 (section 9).
  - (f) you notify any claim under this warranty to SafetyLink in writing to the address below no later than 14 days after the event or occurrence concerning the product giving rise to the claim and you pay all costs related to your claim.
- This warranty does not apply to any defects or other malfunctions caused to the Goods by accident, neglect, vandalism, misuse, alteration, modification or unusual physical, environment or electrical stress.
- Please note that the benefits to the purchaser (as a consumer) given by this warranty are in addition to your other rights and remedies under the Australian Consumer Law. Our goods come with guarantees that cannot be excluded under the Australian Consumer Law. You are entitled to a replacement or refund for a major failure and compensation for any other reasonably foreseeable loss or damage. You are also entitled to have the goods repaired or replaced if the goods fail to be of acceptable quality and the failure does not amount to a major failure.
- 11.6 If any goods are not manufactured by the Company, the guarantee of the manufacturer thereof shall be accepted by the Purchaser as the only express warranty given in respect of the goods.
- 11.7 Except as provided in this clause 11, all express and implied warranties, guarantees and conditions under statute or general law as the merchantability, description, quality, suitability or fitness of the Products for any purpose or as to design, assembly, installation, materials or workmanship or otherwise are hereby expressly excluded (to the extent to which they may be excluded by law).

PLEASE SEE SAFETYLINK PTY LTD FULL STANDARD TERMS OF CONDITIONS OF SALE FOR FURTHER REFERENCE.



# FROGLINK ANCHOR UNIT

Product Code: FROGL001+S5-Z

All safety procedures must comply in accordance with the current safety code(s) of practice(s) for working at heights. Ensure safety at all times during and after installation by using an appropriate height safety protection system.

- ⚠️ **FROGLINK ANCHORS MUST NOT BE USED FOR ROPE ACCESS (ABSEILING).**
- ⚠️ **MAXIMUM USER PER FROGLINK IS ONE (1) PERSON.**

## COMPONENTS

Qty	Product Description
1	FrogLink Plate with waterproofing membrane
2	S5_Z Clamp Brackets



## INSPECT THE INTEGRITY OF THE STRUCTURE AND ROOF SHEETING

- Installation of anchors can only be made to roof sheeting strong enough to support the anchor point.
- **MINIMUM** roof sheet gauge is **0.42mm** for steel and **0.7mm** for aluminium.
- Roof sheets must be inspected thoroughly for splits, rust, corrosion damage and correct installation.
- Ensure the roof sheeting and structure is secured in accordance with current building codes and manufacturer's instructions.

- ⚠️ **During installation you must be safe at all times.**
- ⚠️ **If any doubt exists with the strength of the structure or roof sheets an engineer should make the assessment.**
- ⚠️ **Installation must be carried out by, or under the supervision of a competent height safety installer.**

# FROGLINK ANCHOR UNIT

Product Code: FROGL001+S5-Z

## POSITIONING FROGLINK ANCHOR POINTS

The first FrogLink must be in a position easily and safely reached from a safe access point. Access to the underside of the roof is not required for installation.

## INSTALLATION: TO THE SURFACE OF A METAL ROOF SHEET

1. Place the FrogLink on the surface of the roof sheet running parallel with the sheets profile in the required location. FrogLink anchor is recommended to be installed on the high section of the profile aligned with the fall of the roof, be sure not to create an area where leaves or debris can collect.
2. Bolt the two Clamps under FrogLink, ensuring the set screws are facing opposite direction on each Clamp.
3. Place the Clamps over the roofing profile and secure each clamp with two set screws. Ensure the setscrews are tensioned to 160 and 180 inch pounds on 22ga steel, and 130 to 150 inch pounds on all other metals and thinner gauges of steel (see clamp installation guide).
4. The FrogLink Anchor Point is now ready for use, giving you an anchor point to attach to while installing the next FrogLink.

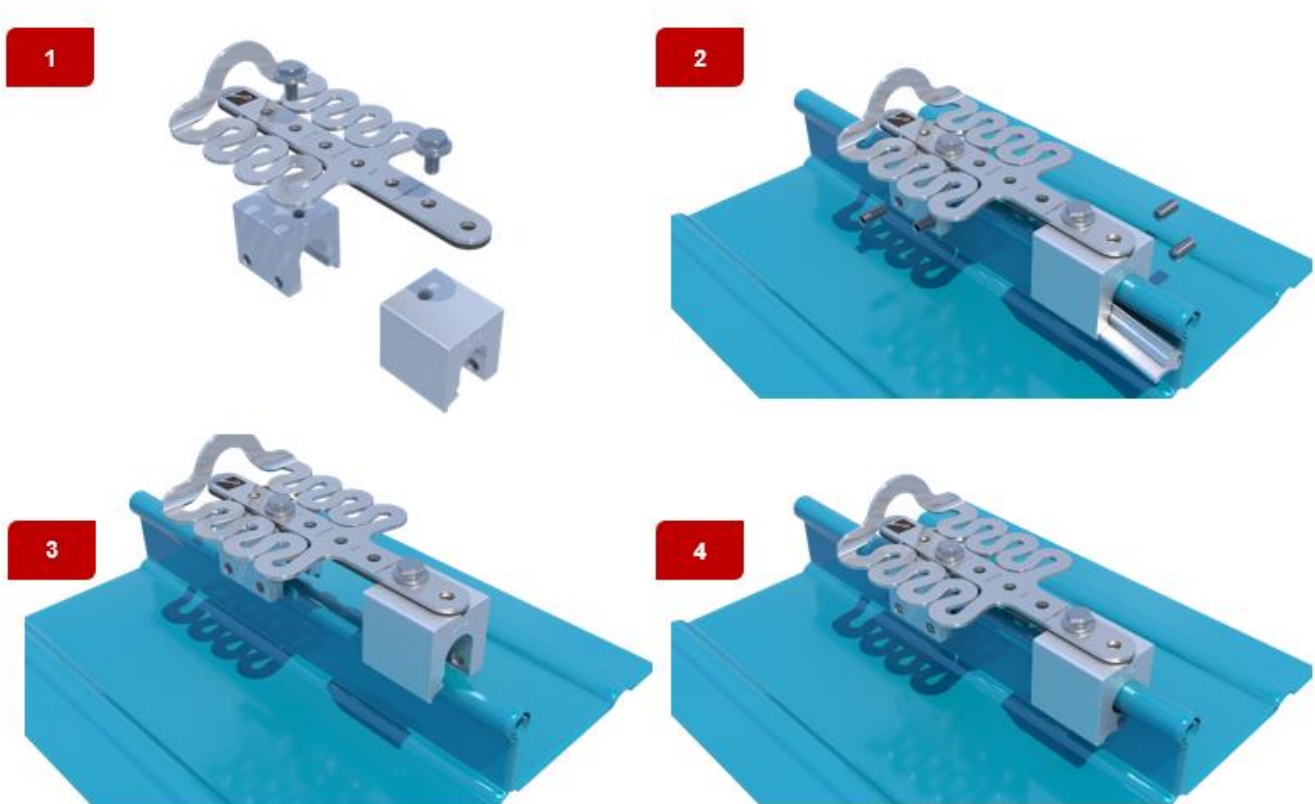

### **Live Load on Anchors:**

The FrogLink anchor is best suited to roof pitches up to 30 degrees. For over 30 degrees FrogLinks should be used in conjunction with other access methods to ensure no live loading. Note: These anchors are not abseil or lifting anchors and therefore if they are subjected to a live load this may trigger the energy absorbing regions.

# S-5!®

## The Right Way!

The right way to attach almost anything to metal roofs!

## Installation Instructions

**S-5!® Warning!** Please use these products responsibly! Visit our website or contact your S-5! distributor for available load test results. The user and/or installer of these parts is responsible for all necessary engineering and design to ensure S-5! clamps have been properly spaced and configured.

**Notice to S-5! product users:** Due to the many variables involved with specific panel products, climates, snow melt phenomena, and job particulars, the manufacturer cannot and does not express any opinions as to the suitability of any S-5! assembly for any specific application and assumes no liability with respect thereto. S-5! products are tested for ultimate holding strength on various profile types and materials. This information is available from the S-5! website: [www.S-5.com](http://www.S-5.com). This document is an installation guide only and the photographs and drawings herein are for the purpose of illustrating installation, tools and techniques, not system designs. Information contained within is intended to apply to the document as a whole.

**The S-5-T, S-5-Z, S-5-Q, and S-5-H clamps fit "T" and "bulb" shaped seams. Please see individual clamp product sheets or the S-5! website for profile details and clamp dimensions.**

## Tools Needed

- Screw Gun\*
- T30 Torx Bit Tip (Provided)
- Dial-Calibrated Torque Wrench  
(For accurate tension values, do NOT use a clicking torque wrench.)

## To Install the S-5-T, S-5-Z, S-5-Q, and S-5-H

1. Partially thread the provided round-point setscrews into the clamp by hand.
  2. Position clamp at desired location along seam with the bolt hole in the correct (upslope or downslope) orientation.
  3. **For S-5-T, S-5-Z, and S-5-Q (illustrated in image 2A):** Install by holding the clamp insert piece under the edge of the seam, then roll the clamp into position over the seam and the insert.  
**For S-5-H (illustrated in image 2B):** Install by positioning clamp at desired location on seam. Then, **slide** insert into place.
  4. Tighten the setscrews at the base of the clamp using a screw gun\* and the included screw gun bit tip. Standard clamps requiring two setscrews should be tensioned and re-tensioned as the seam material compresses, i.e. tighten the first setscrew, then the second; then repeat until each setscrew achieves the recommended torque. The setscrews will dimple the seam material but will not penetrate it. When relying upon tested load values, setscrew tension should be verified periodically throughout installation using a calibrated torque wrench at 160 to 180 inch pounds on 22ga steel and 130 to 150 inch pounds on all other metals and thinner gauges of steel. Once installed correctly, these clamps require no maintenance or re-inspection for the life of the roof (See reverse for setscrew torque table and units).
- \* **For time-saving tool recommendations, call S-5!**
5. For critical attachment applications utilizing an M8-1.25 X 16 mm hex flange bolt, tighten the included M8 bolt to 160 inch pounds (13 foot pounds).

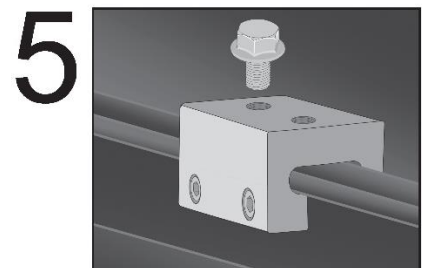
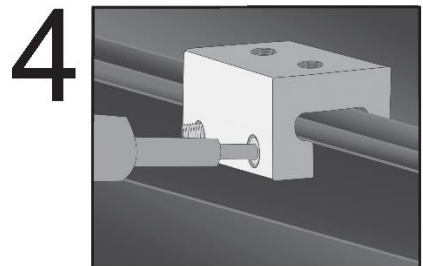
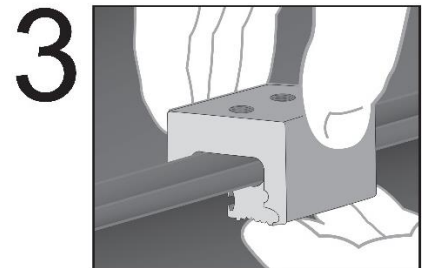
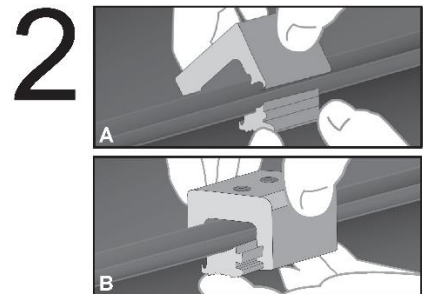
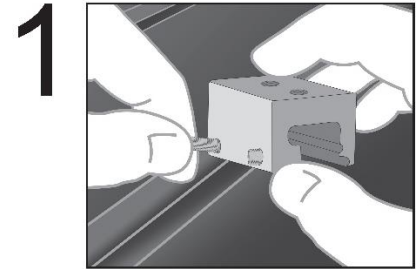

Above illustrations show S-5-T clamp, along with S-5-H clamp on step 2.



### To Install the S-5-T Mini, S-5-Z Mini, S-5-Q Mini, and S-5-H Mini

- Partially thread the provided round-point setscrew into the clamp by hand.
- Position clamp at desired location along seam.
- For S-5-T Mini, S-5-Z Mini, and S-5-Q Mini (illustrated in 2A):** Install by holding the clamp insert piece under the edge of the seam, then roll the clamp into position over the seam and the insert.  
**For S-5-H Mini (illustrated in 2B):** Install by positioning clamp at desired location on seam. Then **slide** insert into place.
- Tighten the setscrew at the base of the clamp using a screw gun\* and the included screw gun bit tip. The setscrew will dimple the seam but will not penetrate it. When relying upon tested load values, setscrew tension should be verified throughout the installation using a calibrated torque wrench as indicated below to ensure the tool is consistently achieving proper torque range.

\*For time-saving tool recommendations, call S-5!

Specified Torque	Inch Pounds	Foot Pounds	Nm
<b>22ga steel</b>	160–180	13–15	18–20
<b>24ga steel and all other metals</b>	130–150	11–12.5	15–17

Once installed correctly, these clamps require no maintenance or re-inspection for the life of the roof.

- For critical attachment applications utilizing an M8-1.25 X 16 mm hex flange bolt, tighten the M8 bolt (sold separately) to 160 inch pounds (13 foot pounds).

**NOTE:** Any S-5! warranty and/or calculation may be void if hardware is used that was not furnished by S-5! directly or through one of their licensed distributors

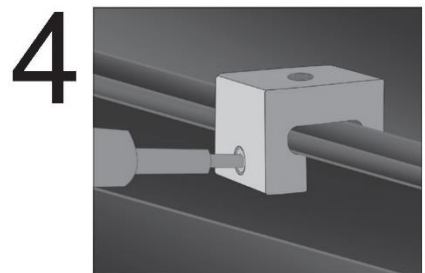
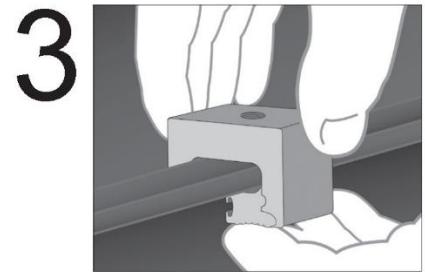
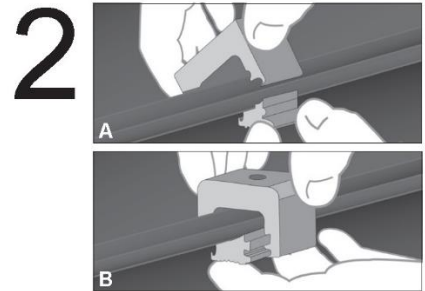
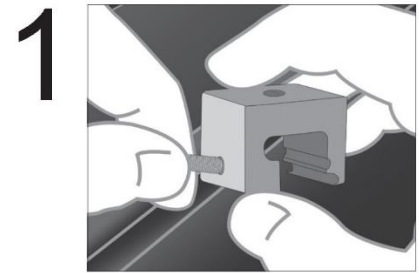

Above illustrations show S-5-T Mini clamp, along with S-5-H Mini clamp on step 2.

#### S-5!® Warning! Please use this product responsibly!

Products are protected by multiple U.S. and foreign patents. Visit the website at [www.S-5.com](http://www.S-5.com) for complete information on patents and trademarks. For maximum holding strength, setscrews should be tensioned and re-tensioned as the seam material compresses, i.e. **tighten the first setscrew, then the second; then repeat until each setscrew achieves the recommended torque.** Clamp setscrew tension should be verified using a calibrated torque wrench between 160 and 180 inch pounds when used on 22ga steel, and between 130 and 150 inch pounds for all other metals and thinner gauges of steel. Consult the S-5! website at [www.S-5.com](http://www.S-5.com) for published data regarding holding strength.

Copyright 2020, Metal Roof Innovations, Ltd. S-5! products are patent protected.

S-5! aggressively protects its patents, trademarks, and copyrights.

TZQHV1.2-0419

# APPENDIX 2 – Anchor Positioning Layout

## THIS IS A GUIDE ONLY

All working at heights safety procedures must be complied with when installing SafetyLink anchor points. For more information refer to your state or territories current legislation, regulations, policies and codes of practices.

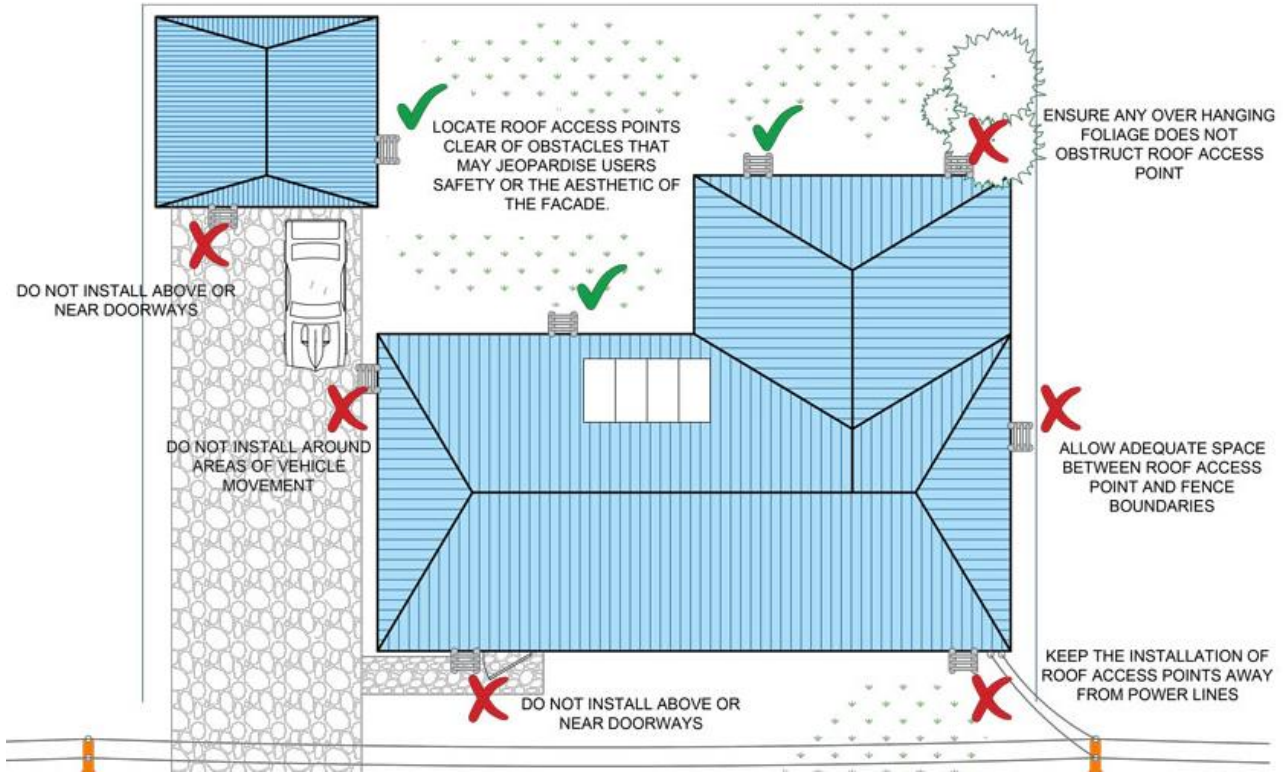

- ⚠ IF ANY DOUBT EXISTS WITH THE STRENGTH OF THE STRUCTURE OR ROOF SHEETS AN ENGINEER SHOULD MAKE THE ASSESSMENT.
- ⚠ DURING INSTALLATION YOU MUST BE SAFE AT ALL TIMES.
- ⚠ INSTALLATION MUST BE CARRIED OUT BY, OR UNDER THE SUPERVISION OF A COMPETENT HEIGHT SAFETY INSTALLER.

### ACCESS, LAYOUT AND USE OF A SAFETYLINK ANCHOR SYSTEM

SafetyLink anchor points are positioned by calculating the pendulum effect, this limits the likelihood of a fall past the edge of the roof space. The pendulum effect still applies to a flat roof.

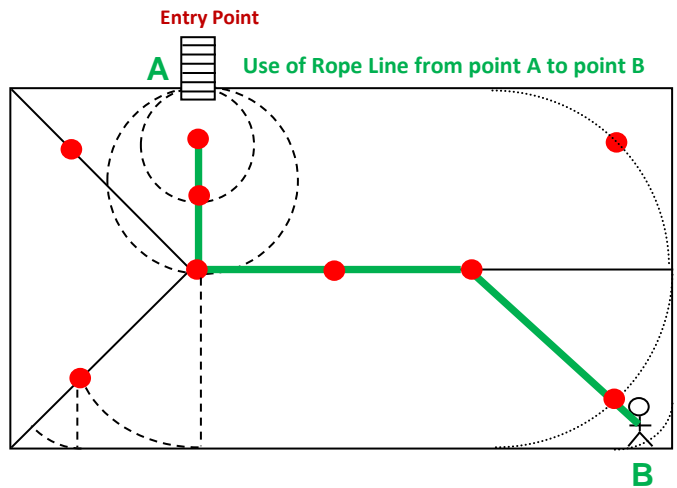
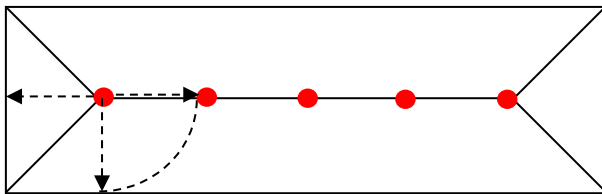

SPACING MUST BE NO GREATER THAN THE RAFTER LENGTH, PLEASE CONTACT YOUR DISTRIBUTOR IF YOU ARE UNSURE.

SAFETYLINK HEIGHT SAFETY SYSTEMS MUST ONLY BE INSTALLED AS PER OUR INSTALLATION GUIDES, TO STRUCTURES AS SPECIFIED IN THE INSTALLATION MANUAL FOR EACH PRODUCT. SHOULD ANY DOUBT EXIST IN REGARD TO THE STRUCTURES INTEGRITY AN ENGINEER SHOULD BE CONSULTED.

# EXPERT FALL PROTECTION PLANNING

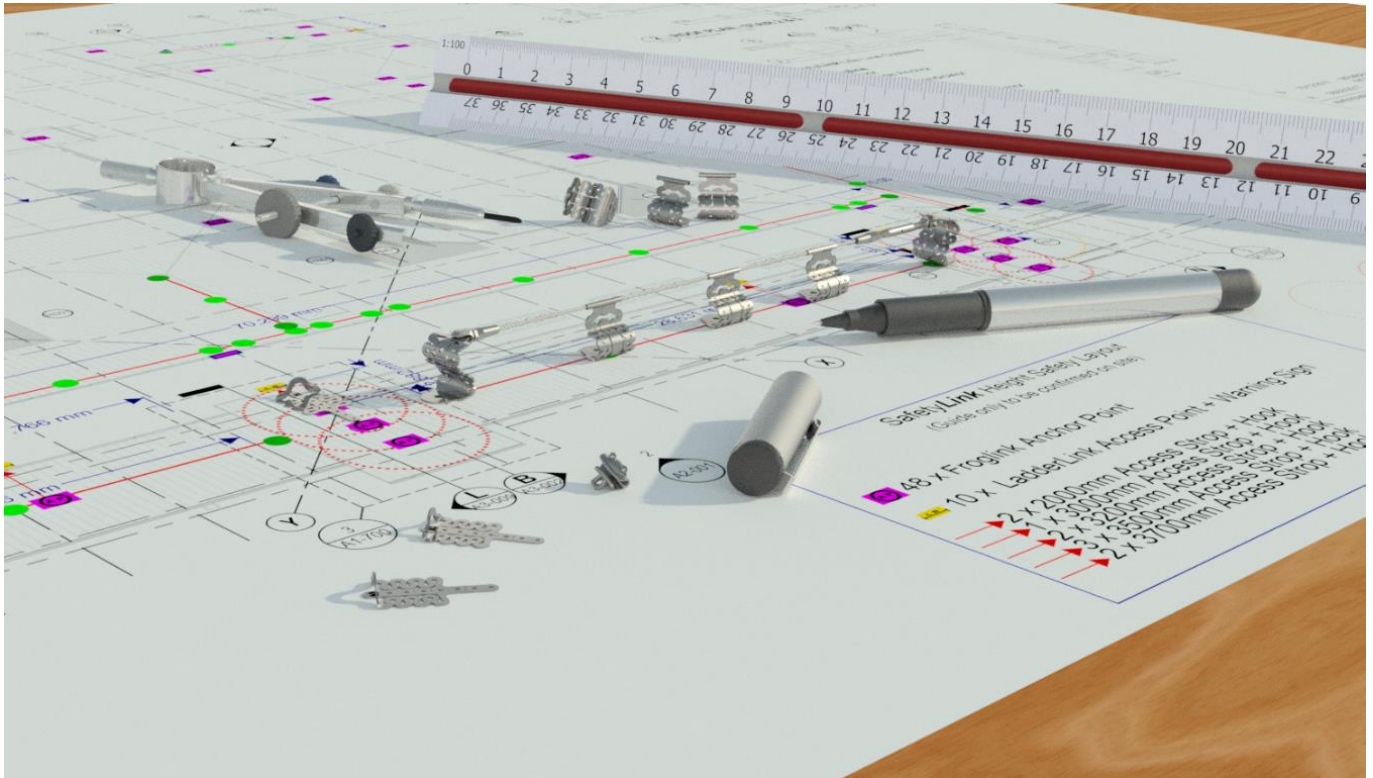

SafetyLink's design and planning team are here to help work out the positioning of your fall protection system, ensuring all areas of your roof are accessed safely.

Things to consider when planning your roof layout:

- Are all areas of your roof protected, allowing complete access when working at heights?
- Are you protected from the ground up, allowing complete access to your roof?
- Detailed comprehensive documentation provided e.g. installation guides, testing results, product sheets should be provided.
- SafetyLink can also provide you with a qualified and reputable installer of SafetyLink products.

Contact our design team at [info@safetylink.com](mailto:info@safetylink.com) and we can plan your fall arrest system for you.

© 2018, SafetyLink Pty Ltd, Australia.

**Patents:** SafetyLink Pty Ltd has a multitude of patents, patents pending, design applications, trademarks and copyrighted documents both lodged and issued. Should you wish to know the progress of our intellectual property on a specific product please email us on [ip@safetylink.com](mailto:ip@safetylink.com) and quote the product code.

# IN CASE OF ACCIDENT

- ⚠️ **A FALL RESCUE PLAN AND SAFE WORK STATEMENT MUST BE DEVELOPED PRIOR TO USING SAFETYLINK SYSTEMS AND EQUIPMENT.**
- ⚠️ **PERSONS WORKING AT HEIGHTS SHOULD NOT WORK ALONE.**

It is critical that before using any SafetyLink Systems a fall rescue plan is in place for any persons suspended mid-air following a fall. Serious injury or death can occur in a matter of minutes, particularly if a person’s movement or breathing is restricted or loss of consciousness has occurred. In accordance with your fall rescue plan and appropriate first aid procedures it is essential to remove the person from the suspended position as quickly as possible.

*In accordance with AS/NZS 1891.4:2009 clause 9.5*

## EQUIPMENT WHICH HAS ARRESTED A FALL OR SHOWS A DEFECT

Any piece of equipment including both personal and permanently installed items, which has been used to arrest a fall or which shows any defect during operator or periodic inspection shall be withdrawn from service immediately and a replacement obtained if necessary. A label indicating the condition or defect should be attached to the equipment, and it should be examined by a competent height safety installer who will decide whether the equipment is to be destroyed or repaired if necessary and returned to service. In the latter case, details of any repair shall be documented, and a copy given to the operator.



SafetyLink Pty Ltd | ABN 83 081 777 371 | [www.safetylink.com](http://www.safetylink.com)

**DISTRIBUTOR:**

Asia-Pacific/The Americas | +61 2 4964 1068 | [info@safetylink.com](mailto:info@safetylink.com)  
Europe/Africa/Middle East | [europe.sales@safetylink.com](mailto:europe.sales@safetylink.com)  
Northern Europe | [uk.sales@safetylink.com](mailto:uk.sales@safetylink.com)

# FROGLINK INSTALLATION AND RECERTIFICATION CHECK LIST

## TO BE READ IN CONJUNCTION WITH **SITE SPECIFIC** INFORMATION

This checklist is to help you compile information about SafetyLink Anchors to ensure they are installed and maintained as per SafetyLink Installation Guides. All anchorages must be inspected every 12 months, inspections need to be carried out by a competent height safety equipment inspector who has been trained in the safe use and maintenance of this system. The system will require re-certification by height safety inspector / suitable qualified engineer or competent person (as defined in AS/NZS 1891.4:2009 clause 1.4 DEFINITIONS) where the systems original date of installation exceeds 10 years, and every subsequent 5 years after that. All anchors must be numbered in layout or by tagged as compliant at installation and re-tagged on re-certification. Tag number codes are to be used in conjunction with a site plan.

- ▲ Improper Use, Installation or Maintenance may result in serious injury or death.
  - ▲ The structure or anchorage to which SafetyLink products are to be installed shall be assessed by a professional engineer to ensure it has adequate strength to support the product.
  - ▲ SafetyLink products shall be installed, used and maintained in accordance with the applicable SafetyLink installation and use manual.
  - ▲ SafetyLink's product shall be used in accordance with the current working at height standards, codes of practice, regulation or legislation in the region of use.
  - ▲ During installation, use and maintenance, personnel shall not be exposed to a fall hazard.
  - ▲ Installation is to be carried out by, or under the supervision of, a competent person.
  - ▲ The installer shall complete the applicable SafetyLink online training modules before installing this product.
  - ▲ Connection systems used with SafetyLink Anchor, Lifelines and Rigid Rail Systems shall contain a personal energy absorber.
  - ▲ Do not carry out any modifications to this product without written permission from SafetyLink.
  - ▲ Training should be repeated periodically.
- ⚠ **WARNINGS: This is a maintenance schedule only and is not intended to substitute training courses in height safety and product installation. Legislative requirements vary according to the region you live in. Please visit the appropriate workcover website for further information. Individual situations vary considerably therefore you should seek appropriate legal advice if you need assistance on the application of law to your situation.**

### 10 YEAR RECERTIFICATION POLICY

10 years from the date of original installation SafetyLink Lifeline/Anchor Systems must be inspected by a suitably qualified engineer or competent height safety installer as defined in AS/NZS 1891.4:2009 clause 1.4 DEFINITIONS. The engineering level of inspection required must be carried out as follows:

#### Summary of requirements after 10 years from original installation date:

- a) The system is to be inspected to ensure it is installed as per SafetyLink's installation instructions.
- b) The system is to be inspected to ensure it passes the annual recertification criteria as set out in SafetyLink's *Installation and Recertification Checklist*.
- c) The structure is to be assessed for any modifications or deterioration which might lead to loss of anchorage strength, and either deemed safe for continued use or taken out of service. Every 5 years after the 10 year Engineer recertification the SafetyLink Lifeline/Anchor Systems must be inspected by a suitably qualified engineer or competent height safety installer as defined in AS/NZS 1891.4:2009 clause 1.4 DEFINITIONS. The engineering level of inspection required must be carried out as follows:

#### Summary of requirements after 5 years from 10 year inspection date:

- a) The system is to be inspected to ensure it is installed as per SafetyLink's installation instructions.
- b) The system is to be inspected to ensure it passes the annual recertification criteria as set out in SafetyLink's *Installation and Recertification Checklist*.
- c) The structure is to be assessed for any modifications or deterioration which might lead to loss of anchorage strength, and either deemed safe for continued use or taken out of service.



**FOR MAINTENANCE ADVICE AND SERVICES PLEASE CONTACT SAFETYLINK ON +61 249 641068 OR 1300 789545 FOR YOUR NEAREST SAFETYLINK INSPECTION SERVICE CENTRE OR EMAIL: [info@safetylink.com](mailto:info@safetylink.com)**





# FROGLINK INSTALLATION AND RECERTIFICATION CHECK LIST

## FROGLINK ANCHOR (S5-Z CLAMP)

NOTE: THIS CHECKLIST IS TO BE USED IN CONJUNCTION WITH A SITE LAYOUT PLAN & INSTALLATION GUIDES & USER MANUALS.

<b>Date of Inspection</b>	
<b>Date of Next Inspection</b>	
<b>Inspector</b>	
<b>Position</b>	
<b>Company</b>	





<b>Site Location or Address</b>		
<b>General Checklist</b>	<b>Yes/No</b>	<b>Action Taken / Comments</b>
Does the site plan match the components installed?		
Are the components correctly tagged?		
Are all components installed as per the installation handbook?		

<b>Component</b>	<b>Component Inspection</b>	<b>Non Compliant Identification Number</b>	<b>Action Taken / Comments</b>
	<b>FrogLink</b> , visually inspect anchors for signs of deterioration, mis-use or loading of the anchor. Eg; distortion, cracks and stretching.		
	<b>Stabilising Joints.</b> The FrogLink anchor point has two (2) energy absorbing regions and two (2) stabilising joints which hold the eyelet in place during use. If these energy absorbing regions are expanded this will indicate the anchor point has arrested a fall. If the two stabilising joints have been broken this would also indicate the FrogLink has arrested a fall and should be replaced.		
Visually inspect the <b>components of the anchor</b> for corrosion, superficial surface marking is permitted while deeper corrosion or pitting would require attention.			

# FROGLINK INSTALLATION AND RECERTIFICATION CHECK LIST

## FROGLINK ANCHOR (S5-Z CLAMP)

NOTE: THIS CHECKLIST IS TO BE USED IN CONJUNCTION WITH A SITE LAYOUT PLAN, SAFETYLINK INSTALLATION GUIDES AND USER MANUALS.

Component	Component Inspection	Non Compliant Identification Number	Action Taken / Comments
<p>Clamps should be checked to ensure the setscrews are tensioned to 16NM on steel roof(see installation guides).</p> 			
<p>Ensure fixing bolt on the top of the <b>Clamp</b> is tightly secured.</p> 			
	<p><b>Parent Structure</b> Visually inspect the parent structure for modifications or deterioration which might lead to loss of anchorage strength. Eg; Rust, splits, tears or missing fixing hardware.</p>		
	<p><b>Certification Label</b>, check for individual anchor compliance tag and I.D. number.</p>		
	<p><b>Warning Compliance Sign</b> must be legible and present. Check installer information and inspection date details complete</p>		
<p><b>Surface Mounted Anchors</b> should be positioned no less than 2 metres from the edge on clip down/standing seam style roof profiles unless additional securing of roof sheeting is made.</p>			
<p>Notes:</p>			



Safety Centre Training



Installation Guide



Anchor Layout Video



Catalogue



Website