



# Concrete**Link** Twin Bolt Anchors

**CONCL011, CONCL011.MINI15,  
CONCL011.MINI22**

## Instruction

**FIGURE 1**



### 1 Warning

- ⚠** *Improper Use, Installation or Maintenance may result in serious injury or death.*
- ⚠** *The structure or anchorage to which SafetyLink products are to be installed shall be assessed by a professional engineer to ensure it has adequate strength to support the product.*
- ⚠** *SafetyLink products shall be installed, used and maintained in accordance with the applicable SafetyLink installation and use manual.*
- ⚠** *SafetyLink's product shall be used in accordance with the current working at height standards, codes of practice, regulation or legislation in the region of use.*
- ⚠** *During installation, use and maintenance, personnel shall not be exposed to a fall hazard.*
- ⚠** *Installation is to be carried out by, or under the supervision of, a competent person.*
- ⚠** *The installer shall complete the applicable SafetyLink online training modules before installing this product.*
- ⚠** *Connection systems used with SafetyLink Anchor, Lifelines and Rigid Rail Systems shall contain a personal energy absorber.*
- ⚠** *Do not carry out any modifications to this product without written permission from SafetyLink.*

## 2 Specification

### 2.1 Description







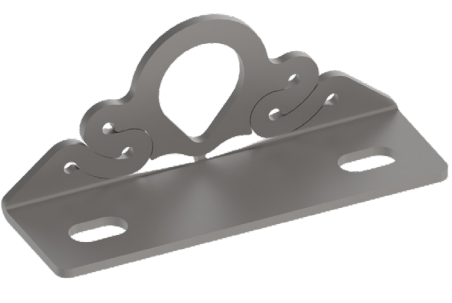

The SafetyLink ConcreteLink is a single point anchor suitable for installation in concrete or steel structure. This product is suitable for use as part of a fall protection system as per AS/NZS1891.4:2025 or as part of a rope access system as per AS/NZS ISO 22846:2020.

### 2.2 Standard

The ConcreteLink is compliant with the standards noted in the below table.

FIGURE 2		
PRODUCT CODE	STANDARD	RATING
CONCL011	AS/NZS5532:2013 1 person	15kN
CONCL011.MINI15	AS5532:2025 1 person	15kN
CONCL011.MINI22	AS5532:2025 2 persons, ANSI Z359.18:2017	22.2kN, 5000LBS

### 2.3 Materials Specification

FIGURE 3		
		
CONCL011	CONCL011.MINI15	CONCL011.MINI22
		
CONCL011+FIXINGS	CONCL011. MINI15+FIXINGS-C	CONCL011. MINI22+FIXINGS-C
		
	CONCL011. MINI15+FIXINGS-M	CONCL011. MINI22+FIXINGS-M
PRODUCT CODE	ENERGY ABSORBER	INSPECTION TAG POINT
CONCL011	Yes	No
CONCL011.MINI15	No	Yes
CONCL011.MINI22	No	Yes

### 3 Installation

#### 3.1 Reaction Loads

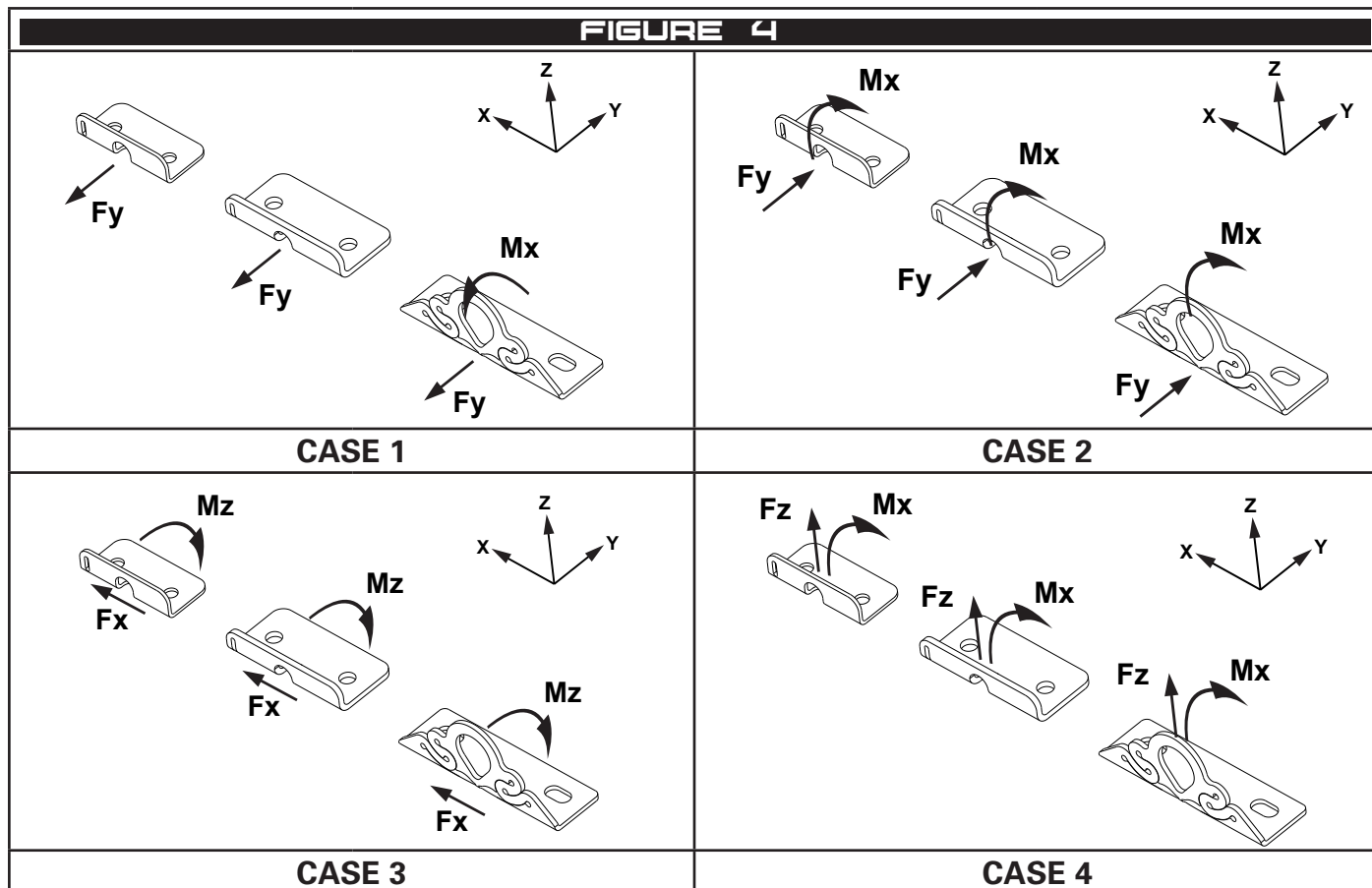

PRODUCT	CASE	LOAD (kN)	MOMENT (kNm)
CONCL011	1	15	0.45
CONCL011	2	15	0.45
CONCL011	3	15	0.45
CONCL011	4	15	0.45
CONCL011.MINI15	1	15	N/A
CONCL011.MINI15	2	15	0.23
CONCL011.MINI15	3	15	0.23
CONCL011.MINI15	4	15	0.23
CONCL011.MINI22	1	22.2	N/A
CONCL011.MINI22	2	22.2	0.33
CONCL011.MINI22	3	22.2	0.33
CONCL011.MINI22	4	22.2	0.33

### 3.2 Concrete Requirements

The below requirements apply for the chemical and mechanical fasteners supplied by SafetyLink in 32MPa non cracked concrete. Other types of fastener may be used but may require different installation depths and distances. Consult the manufacturer's instructions for more information.

FIGURE 5							
Product Code	Minimum Embedment Depth (mm)	Minimum Slab Thickness (mm)	Minimum Edge distance (mm)	Hole Size (mm)	Hole Spacing (mm)	Stud Size	Chemical or Mechanical
CONCL011	104	200	160	14	110	160	C
CONCL011.MINI15	73	130	140	12	55	130	C
CONCL011.MINI15	64	200	120	12	55	130	C
CONCL011.MINI15	72	130	140	10	55	115	M
CONCL011.MINI15	60	200	120	10	55	115	M
CONCL011.MINI22	91	150	190	14	75	130	C
CONCL011.MINI22	94	200	160	14	75	130	C
CONCL011.MINI22	92	150	190	12	75	150	M
CONCL011.MINI22	93	200	160	12	75	150	M

### 3.3 Installation Concrete

- 1 Drill two holes, as per Figure 5. Clean the holes of dust and, insert the mechanical fastener or, inject the chemical adhesive and install the studs.
- 2 Once the chemical has cured, install the anchor with the washer, spring washer and nut. Tighten to 45Nm.
- 3 Proof test each fastener in accordance with AS/NZS1891.4:2025.

**⚠ This method is suitable for CON.CHEM.FISV.300 and FISCHER FAZ II M10/12 fasteners. Other adhesives or mechanical products may require different depths or edge distances. Consult the manufacturer's instructions for details.**

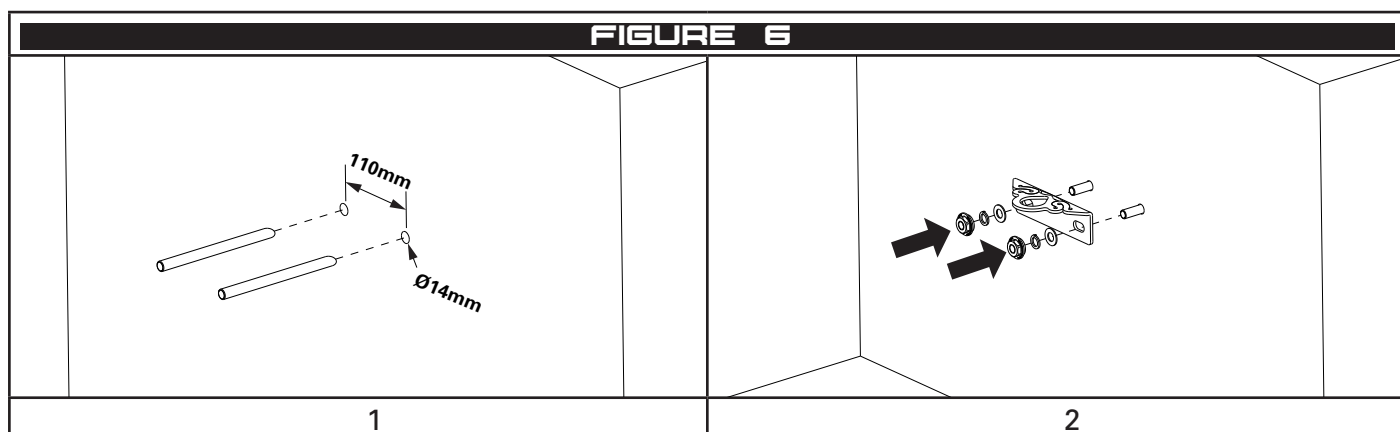

### 3.4 Installation Steel

Fixing shall be M10 or 3/8" for CONCL011.MINI15 and M12 or 1/2" for CONCL011 and CONCL011.MINI22. Fixings shall be stainless steel grade 316 or 304, hot dip galvanised, or zinc plated steel grades 8.8 or 8. Fixing shall be installed with spring washers, locknuts or thread lock adhesive to prevent loosening.

- 1 Drill two holes, as per Figure 5.
- 2 Install the anchor with the bolt, washer, spring washer and nut. Tighten to 45Nm.

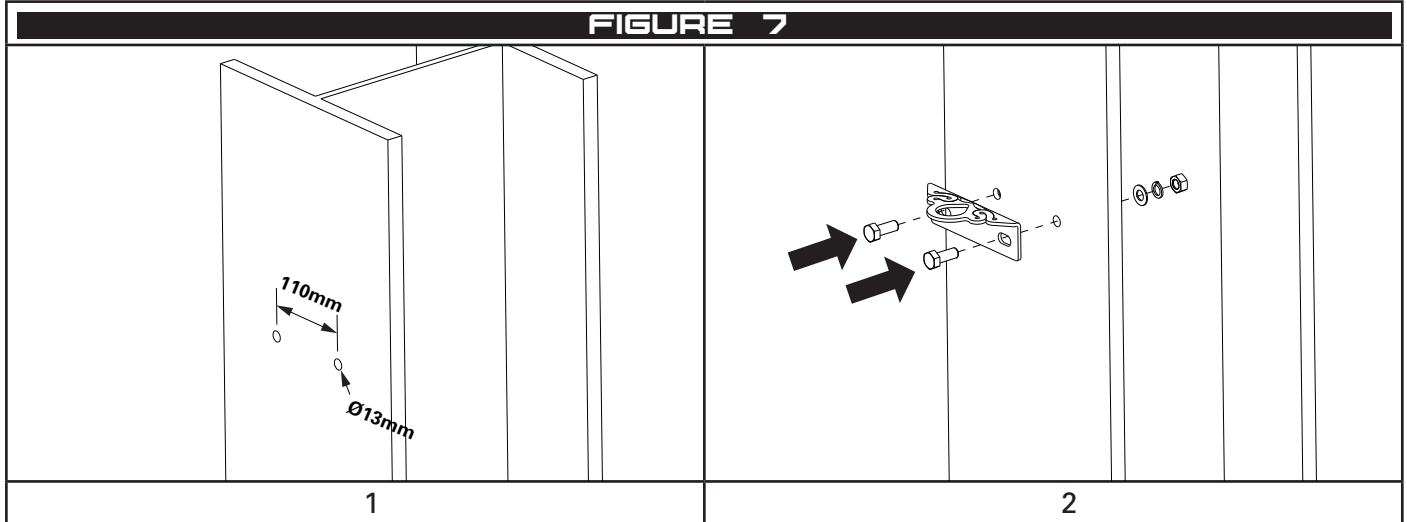

## 4 Limitations of Use

### 4.1 Fall Clearance

When planning your fall protection system, it is important to accurately assess all components of your system in order to avoid injury. Figure 8 provides guidance on how to calculate fall clearance. In Figure 8, (A) represents the deflection ConcreteLink, (B) represents free fall, energy absorber deployment as well as the estimated D-ring side of the harness (Refer the manufacturer's information), (SF) represents the recommended safety factor of 1m, (FC) represents the total allowable fall clearance. For safe use (FC) shall always be greater than  $A+B+SF$ .

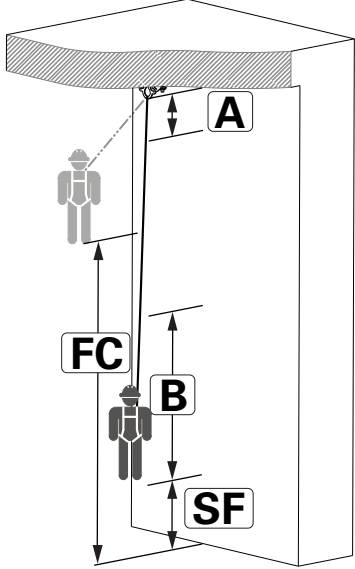
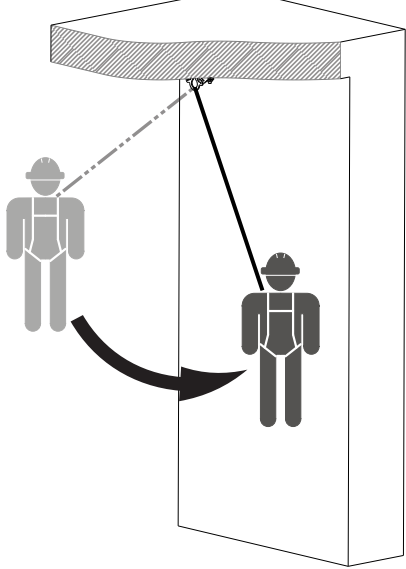
FIGURE 8	FIGURE 9
	
PRODUCT CODE	MAX DEFLECTION
CONCL011	150mm
CONCL011.MINI15	10mm
CONCL011.MINI22	10mm

### 4.2 Swing Fall

Working off centre of an anchor point may cause a swing fall. See Figure 9. Fall protection systems shall be setup in such a way to limit swing fall.

**⚠ The force of striking an object during a swing fall may result in serious injury or death.**

### 4.3 Hazards

Use of this equipment in the presence of hazards may cause damage to the equipment and/or result in the function of the equipment being impeded. These hazards include but are not limited to; extreme temperature, sharp edges, chemical reagents, electrical conductivity, abrasion, cutting, climatic exposure and rotating or moving machinery.

### 4.4 Training

It is essential that all users are trained in the proper inspection, setup and use of this equipment. It's the responsibility of the user to ensure they are trained in the correct use of this equipment and understand the limitations of its use.

**⚠ Incorrect use of this equipment may result in serious injury or death.**

### 4.5 Rescue

It is the responsibility of the user of this equipment and their employer to have a suitable rescue plan and the ability to implement it at any time during setup and use of this equipment.

## 5 Connections

### 5.1 Making Connection

Only make compatible connections. Always ensure connectors close and lock correctly before use. Below and Figure 11 are examples of unsuitable connections;

- 1 To an anchor or D-ring which has another connector attached.
- 2 In a position that will apply load to the gate mechanism.
- 3 By passing the connection through the attachment.
- 4 Connecting a connector to another connector.
- 5 Around a structure and back to the lifeline.
- 6 To an attachment that will limit the function of the gate.
- 7 To a location that will not load the connector as designed.

### 5.2 Compatibility of Connections

Connection made to and with this equipment shall be compatible. Connector shall be compatible shape, size and equivalent rating in order to ensure a compatible connection is made. Incompatible connections may cause loading of the gate mechanism leading to unintentional disengagement. See Figure 10. Connectors shall be compliant with EN362 and auto closing and locking, and meet the gate strength requirement outlined in AS/NZS1891.4:2025.

**⚠ Making incompatible or unsuitable connection may result in unintentional disengagement of the connector resulting in serious injury or death.**

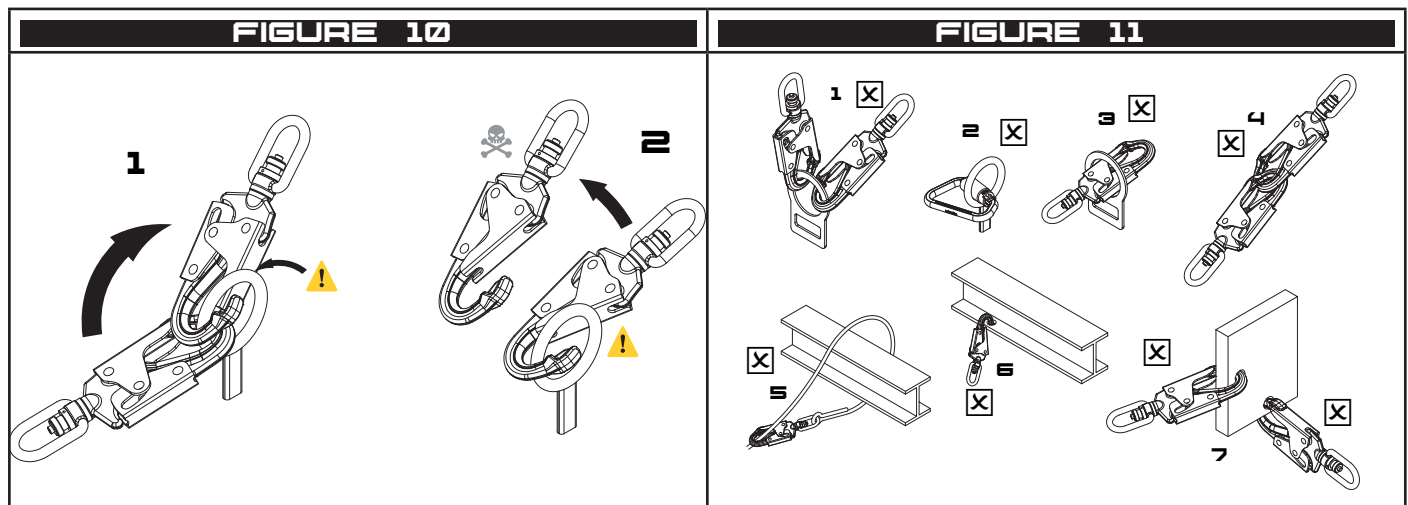

## 6 Use

### 6.1 Planning

Before starting work, plan your working at heights and rescue systems by accounting for all hazards present in the work place and allowing for the available fall clearance. Ensure all users are fit, healthy and capable of safely operating this equipment as well as implementing the rescue plan.

### 6.2 Use

- 1 Inspect the product and structure as per this instruction manual.
- 2 Connect the users fall protection system to the attachment point on the product. See Figure 12
- 3 The product may be used with a fall direction in any direction around the product.

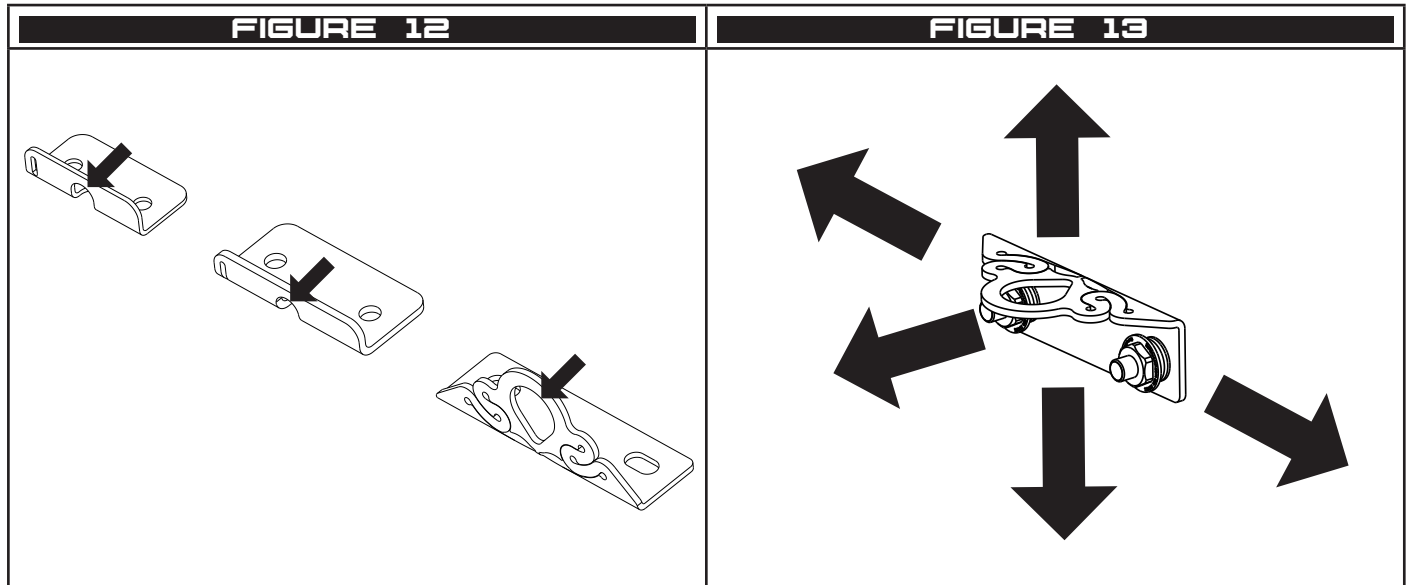

- ⚠ ***The connecting system shall contain a personal energy absorber.***
- ⚠ ***Do not attach to any other point on the ConcreteLink other than the specified attachment point.***
- ⚠ ***Use of incompatible connectors may lead to forced roll out and unintentional disconnection.***
- ⚠ ***Always consult the connecting system manufacturer's instruction to ensure it is suitable for use with this equipment.***
- ⚠ ***During use always allow for the required fall clearance, swing fall and hazards present in the work place.***

## 7 Storage, Transport and Maintenance

### 7.1 Storage and transport

This equipment shall be stored and transported in a cool, dry environment, away from any hazards and out of direct sunlight.

### 7.2 Maintenance

7.2.1 The ConcreteLink Single Point Anchor is non serviceable. The equipment may remain in service until it fails an inspection or is involved in a fall.

**⚠ Do not attempt to modify or disassemble this product.**

### 7.3 Cleaning

The ConcreteLink may be cleaned by the end user periodically to increase service life. After cleaning, the product shall undergo the pre-use inspection. Clean with a rag and warm water to remove dirt and grit. A mild detergent may be used to remove grease or oils from the product.

**⚠ Do not store this product when wet. Allow the product to dry and conduct a pre-use inspection prior to returning the item to service.**

## 8 Inspection

### 8.1 Before and After Use

The ConcreteLink Single Point Anchor shall be inspected before and after each use by the user.

### 8.2 Competent Person

A competent person shall inspect the product at least every 12 months.

### 8.3 Procedure

8.3.1 Attachment point - inspect for damage, deformation, corrosion or signs of over loading. Minor bending of the attachment point is acceptable provided the fall indicator, where present, is intact.

8.3.2 Fall Indicator\* - inspect tab is intact.

8.3.3 Serpentine\* - inspect the serpentines lay flat and in-line with the product. Inspect the energy absorber is free of cracks, dirt, debris, defects, damage, deformation, corrosion, signs of over loading.

8.3.4 Markings - inspect all markings are present and legible. Figure 15.

8.3.5 Proof Loading - Applicable for concrete anchors only as per AS/NZS1891.4:2025. Proof load each fixing to 7.5kN in direct pull and hold for 1 minute. Do not proof load from the attachment point. Competent person inspection only.

**✓** If the following requirements are met, annual proof loading is not required;

- a The appropriate calculations have been conducted in accordance with AS/NZS1891.4:2025 to prove the concrete and fastener used are suitable for this product. For the fasteners supplied by SafetyLink in this manual, these calculations have been completed.
- b The fastener manufacturer's installation requirements have been met.
- c The fastener manufacturer's warranty is valid.
- d Installation documentation is available, and contains evidence of the proof test at installation and the fastener specification.

\* Some models do not include these features.

<b>INSPECTION RECORD</b>			
Product Code		Date of Manufacture	
Serial or Batch No.		Date of Install	
Inspector		Date of Inspection	
<b>PROCEDURE</b>	<b>INSPECTION</b>	<b>USER</b>	<b>COMPETENT PERSON</b>
<b>8.3.1</b>	Attachment point - inspect for damage, deformation, corrosion or signs of over loading. Minor bending of the attachment point is acceptable provided the fall indicator, where present, is intact.	<input type="checkbox"/>	<input type="checkbox"/>
	Comments:		
<b>8.3.2</b>	Fall Indicator* - inspect tab is intact.	<input type="checkbox"/>	<input type="checkbox"/>
	Comments:		
<b>8.3.3</b>	Serpentine* - inspect the serpentines lay flat and inline with the product. Inspect the energy absorber is free of cracks, dirt, debris, defects, damage, deformation, corrosion, signs of over loading.	<input type="checkbox"/>	<input type="checkbox"/>
	Comments:		
<b>8.3.4</b>	Markings - inspect all markings are present and legible. Figure 15.	<input type="checkbox"/>	<input type="checkbox"/>
	Comments:		
<b>8.3.5</b>	Proof Loading - Applicable for concrete anchors only as per AS/NZS1891.4:2025. Proof load each fixing to 7.5kN in direct pull and hold for 1 minute. Do not proof load from the attachment point. Competent person inspection only.	N/A	<input type="checkbox"/>
	Comments:		

**FIGURE 14**

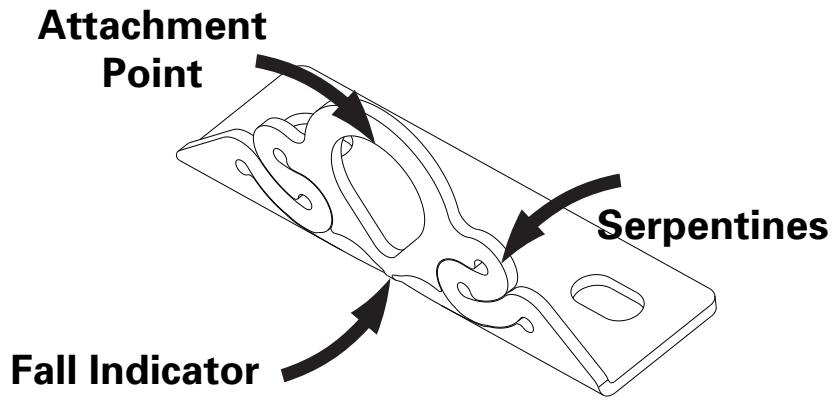

**CONCL011**

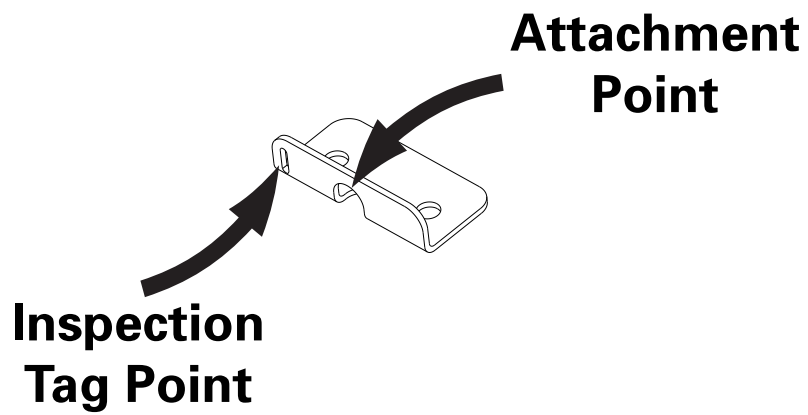

**CONCL011.MINI15**

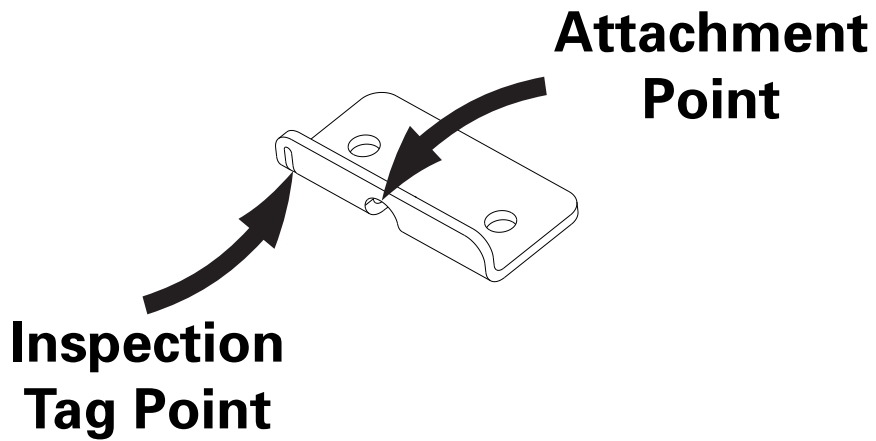

**CONCL011.MINI22**

**FIGURE 15**

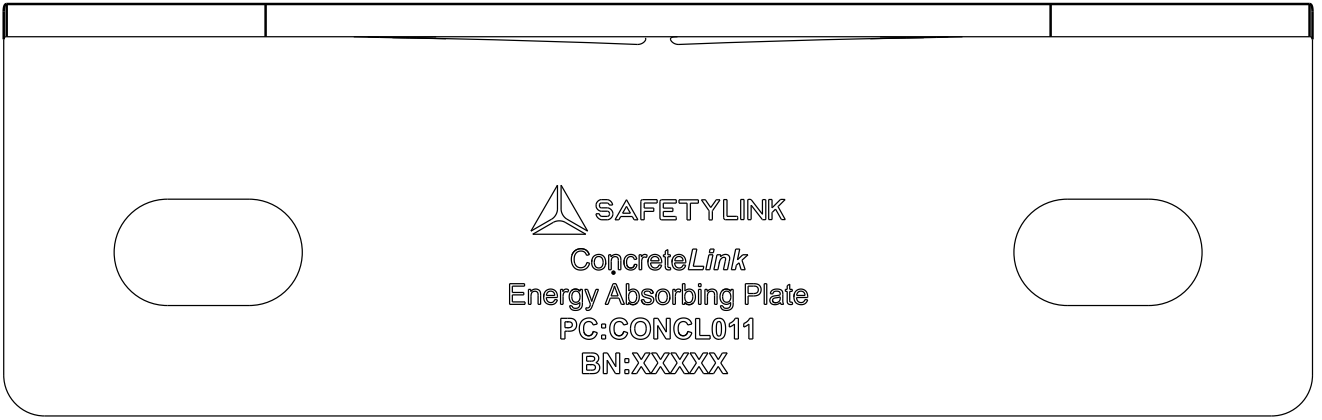

**CONCL011**



**CONCL011.MINI15**

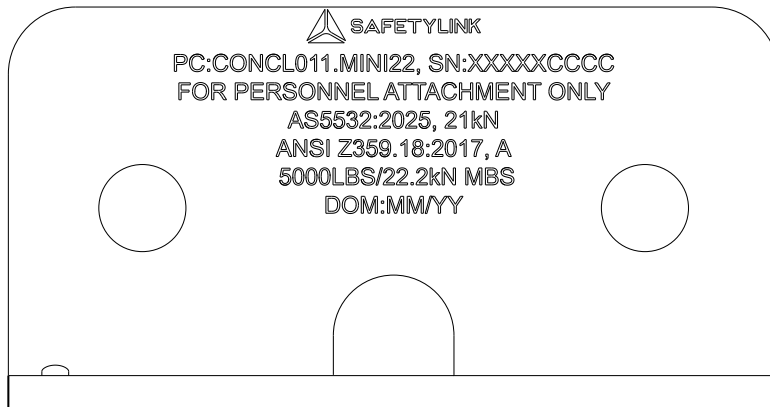

**CONCL011.MINI22**

# Warranties

## EXTRACT: SAFETYLINK PTY LTD STANDARD TERMS AND CONDITIONS

- 1.1 To the extent permitted by law all implied conditions, warranties and undertakings are expressly excluded.
- 1.2 Except as provided in this clause the Company shall not be liable for any loss or damage, whether direct or indirect (including consequential losses or damage) arising out of any breach of contract by the Company or any negligence of the Company, its employees or agents.
- 1.3 Should the Company be liable for a breach of a guarantee, condition or warranty implied by the Australian Consumer Law (not being a guarantee, condition or warranty implied by sections 51, 52 and 53 of that Law) then its liability for a breach of any such condition or warranty express or implied shall be limited, at its option, to any one or more of the following.
- A in case of Goods
- I the replacement of the Goods or the supply of equivalent Goods.
  - II the repair of the goods,
  - III the payment of the cost of replacing the Goods or acquiring equivalent Goods.
  - IV the payment of the cost of having the Goods repaired. Provided that any such Goods are returned to the Company by the Purchaser at the Purchaser's expense.
- B in the case of services
- I the supply of the services again,
  - II the payment of the cost of having the services supplied again.
- 1.4 The Company is not liable for the costs of recovery of the Goods from the field, loss of use of the Goods, loss of time, inconvenience, incidental or consequential loss or damage, nor for any other loss or damage other than as stated above, whether ordinary or exemplary, caused either directly or indirectly by use of the Goods.
- 1.5 The Company warrants that at the time of shipment, Products manufactured by it will be free from defects in material and workmanship. In the absence of a modified written warranty, the Company agrees to making good any such defects by repairing the same or at the Company's option by replacement, for a period of (1) one year from the date of shipment. This limited warranty applies provided that:
- a defects have arising solely from faulty materials or workmanship;
  - b the Products have not received maltreatment, inattention or interference;
  - c the Products have been installed in accordance with the Company's Installation Handbooks using only products supplied by the Company;
  - d accessories used with the Products are manufactured by or approved by the Company
  - e the Products are maintained in accordance with Australian Standard 1891.4 (section 9).
  - f you notify any claim under this warranty to SafetyLink in writing to the address below no later than 14 days after the event or occurrence concerning the produce giving rise to the claim and you pay all costs related to your claim.

This warranty does not apply to any defects or other malfunctions caused to the Goods by accident, neglect, vandalism, misuse, alteration, modification or unusual physical, environment or electrical stress.

Please note that the benefits to the purchaser (as a consumer) given by this warranty are in addition to your other rights and remedies under the Australian Consumer Law. Our goods come with guarantees that cannot be excluded under the Australian Consumer Law. You are entitled to a replacement or refund for a major failure and compensation for any other reasonably foreseeable loss or damage. You are also entitled to have the goods repaired or replaced if the goods fail to be of acceptable quality and the failure does not amount to a major failure.

1.6 If any goods are not manufactured by the Company, the guarantee of the manufacturer thereof shall be accepted by the Purchaser as the only express warranty given in respect of the goods.

1.7 Except as provided in this clause 11, all express and implied warranties, guarantees and conditions under statute or general law as the merchantability, description, quality, suitability or fitness of the Products for any purpose or as to design, assembly, installation, materials or workmanship or otherwise are hereby expressly excluded (to the extent to which they may be excluded by law).

PLEASE SEE SAFETYLINK PTY LTD FULL STANDARD TERMS OF CONDITIONS OF SALE FOR FURTHER REFERENCE.



SafetyLink Pty Ltd | ABN 83 081 777 371 | [www.safetylink.com](http://www.safetylink.com)

Head Office: 54 Bonville Ave, Thornton, 2322, NSW, Australia

+64 2 4964 1068 | 1300 789 545

Asia-Pacific/The Americas | [info@safetylink.com](mailto:info@safetylink.com)

Europe/Africa/Middle East | [europe.sales@safetylink.com](mailto:europe.sales@safetylink.com)

Northern Europe | [uk.sales@safetylink.com](mailto:uk.sales@safetylink.com)