

INSTALLATION HANDBOOK

18v CRIMPING TOOL

SafetyLink is an innovative anchor company achieving success and keeping you safe whilst working at heights.

- ROOF ANCHORS
- HORIZONTAL LIFELINES
- PERMANENT LADDERS
- LADDER STABILIZERS
- TEMPORARY ANCHOR

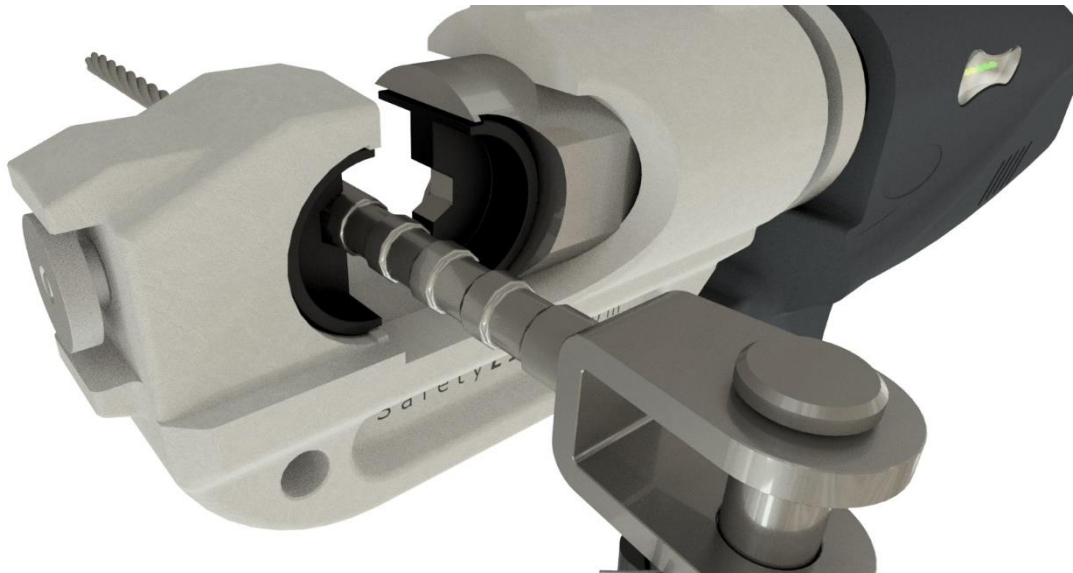

Read entire handbook before installing SafetyLink products. All products must be installed in accordance with SafetyLink's installation handbook, using only products supplied by SafetyLink Pty Ltd. Failure to follow all warnings and instructions may result in a serious injury or death.



SafetyLink Pty Ltd
AU: 1300 789 545
INT: +61 2 4964 1068
info@safetylink.com

www.safetylink.com

TABLE OF CONTENTS

SafetyLink Crimping Tool

WARRANTIES	4
CRIMPING TOOL - SPECIFICATION	5
CRIMPING TOOL – PRIOR TO USE.....	6
CRIMPING TOOL – OPERATING/USE.....	6
CRIMPING TOOL – OPERATING/USE.....	8
MAINTENANCE GUIDE – CRIMPING TOOL	9
STORAGE.....	9
STORAGE.....	9
BREAKDOWN SOLVING	9
CRIMPING TOOL - 18V BATTERY & CHARGER SET	10
HOW TO OPERATE/USE CH-07 CHARGER	10
CRIMPING TOOL - 18V BATTERY & CHARGER SET	11
ABOUT THE 18V LI-ION BATTERY: B-04 & B-06	11
CRIMPING TOOL - 18V BATTERY & CHARGER SET	12
MANUAL/INSTRUCTION OF BATTERY	12
SPECIFICATION.....	12
BEFORE OPERATION PLEASE NOTE	12
HOW TO CLEAN THE BATTERY.....	12
RECYCLE & THROW AWAY	12
EXAMPLE: LAYOUT OF LIFELINE SYSTEM.....	13
APPENDIX A – CRIMPED FITTINGS.....	14
NOTES	15
NOTES	16
IN CASE OF ACCIDENT.....	17

WARRANTIES

EXTRACT: SafetyLink Pty Ltd STANDARD TERMS AND CONDITIONS

- 11.1 To the extent permitted by law all implied conditions, warranties and undertakings are expressly excluded.
- 11.2 Except as provided in this clause the Company shall not be liable for any loss or damage, whether direct or indirect (including consequential losses or damage) arising out of any breach of contract by the Company or any negligence of the Company, its employees or agents.
- 11.3 Should the Company be liable for a breach of a guarantee, condition or warranty implied by the Australian Consumer Law (not being a guarantee, condition or warranty implied by sections 51, 52 and 53 of that Law) then its liability for a breach of any such condition or warranty express or implied shall be limited, at its option, to any one or more of the following.
- A) in case of Goods
- (I) the replacement of the Goods or the supply of equivalent Goods.
 - (II) the repair of the goods,
 - (III) the payment of the cost of replacing the Goods or acquiring equivalent Goods.
 - (IV) The payment of the cost of having the Goods repaired.
- Provided that any such Goods are returned to the Company by the Purchaser at the Purchaser's expense.
- B) in the case of services
- (i) the supply of the services again,
 - (ii) the payment of the cost of having the services supplied again.
- 11.4 The Company will not be liable for the costs of recovery of the Goods from the field, loss of use of the Goods, loss of time, inconvenience, incidental or consequential loss or damage, nor for any other loss or damage other than as stated above, whether ordinary or exemplary, caused either directly or indirectly by use of the Goods.
- 11.5 The Company warrants that at the time of shipment, Products manufactured by it will be free from defects in material and workmanship. In the absence of a modified written warranty, the Company agrees to making good any such defects by repairing the same or at the Company's option by replacement, for a period of (1) one year from the date of shipment. This limited warranty applies provided that:
- (a) defects have arisen solely from faulty materials or workmanship;
 - (b) the Products have not received maltreatment, inattention or interference;
 - (c) **the Products have been installed in accordance with the Company's Installation Handbooks using only products supplied by the Company;**
 - (d) accessories used with the Products are manufactured by or approved by the Company;
 - (e) the Products are maintained in accordance with Australian Standard 1891.4 (section 9).
 - (f) you notify any claim under this warranty to SafetyLink in writing to the address below no later than 14 days after the event or occurrence concerning the product giving rise to the claim and you pay all costs related to your claim.

This warranty does not apply to any defects or other malfunctions caused to the Goods by accident, neglect, vandalism, misuse, alteration, modification or unusual physical, environment or electrical stress.

Please note that the benefits to the purchaser (as a consumer) given by this warranty are in addition to your other rights and remedies under the Australian Consumer Law. Our goods come with guarantees that cannot be excluded under the Australian Consumer Law. You are entitled to a replacement or refund for a major failure and compensation for any other reasonably foreseeable loss or damage. You are also entitled to have the goods repaired or replaced if the goods fail to be of acceptable quality and the failure does not amount to a major failure.

- 11.6 If any goods are not manufactured by the Company, the guarantee of the manufacturer thereof shall be accepted by the Purchaser as the only express warranty given in respect of the goods.
- 11.7 Except as provided in this clause 11, all express and implied warranties, guarantees and conditions under statute or general law as the merchantability, description, quality, suitability or fitness of the Products for any purpose or as to design, assembly, installation, materials or workmanship or otherwise are hereby expressly excluded (to the extent to which they may be excluded by law).

PLEASE SEE SAFETYLINK PTY LTD FULL STANDARD TERMS OF CONDITIONS OF SALE FOR FURTHER REFERENCE.



CRIMPING TOOL - SPECIFICATION

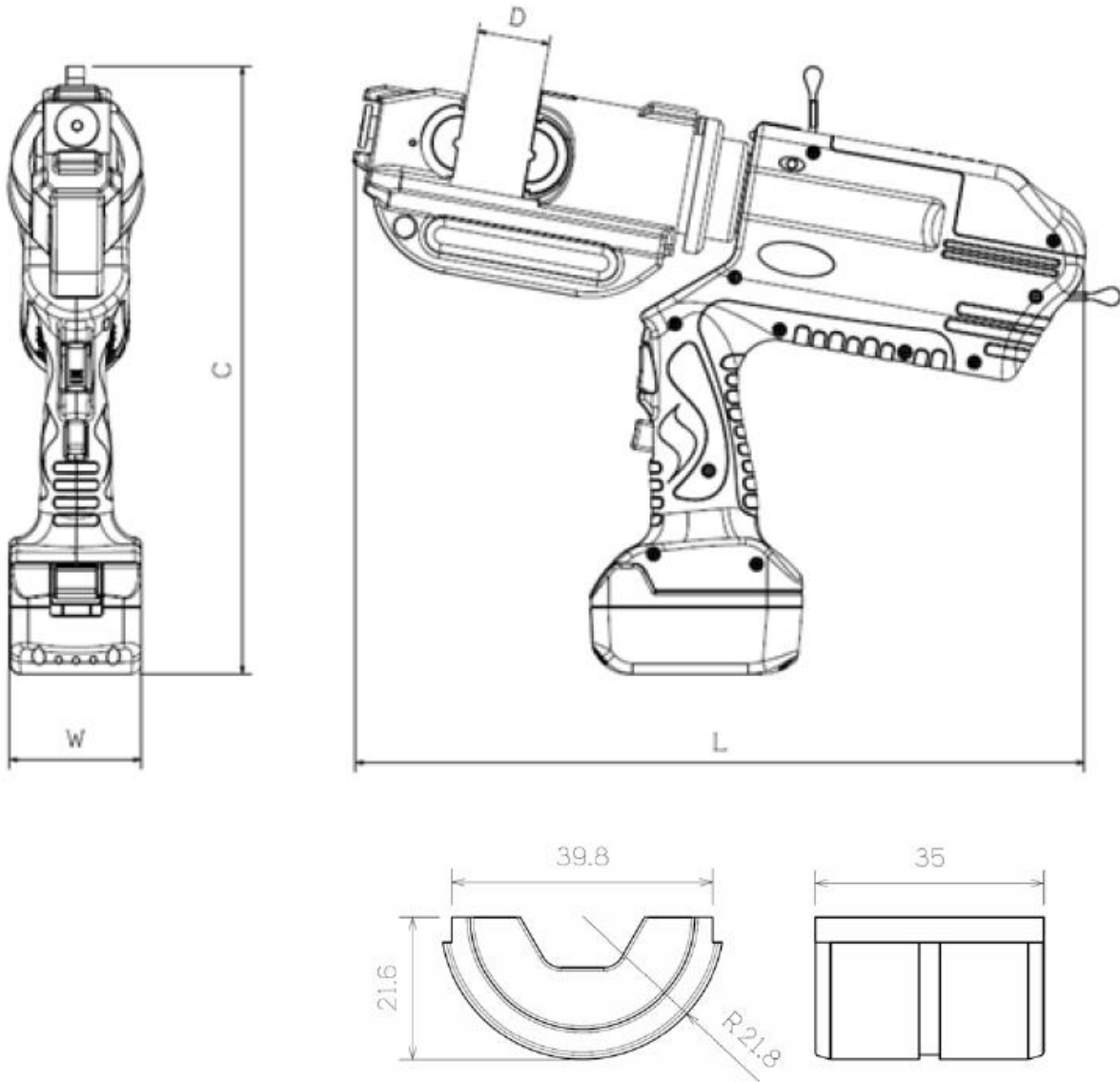

SPECIFICATION	
MODEL NO.	EPB-4201
OUTPUT	12 TONS
VOLTAGE	DC 18V
WEIGHT	7.3 KGS
DIMENSION	460mm(L) 70mm(W) 240mm(C)
OPENING(D)	42mm
CRIMPING RANGE	35-400sqmm

DIE NO.	
NC3035	CU35
NC3050	CU50
NC3070	CU70
NC3095	CU95
NC30120	CU120
NC30150	CU150
NC30185	CU185
NC30240	CU240
NC30300	CU300
NC30400	CU400

CRIMPING TOOL – PRIOR TO USE

- Please wear protective equipment while operating to ensure your safety. Warning: This tool is not insulated.
- Check the crimping range and suitable crimping material.
- Check your crimping material is suitable for this tool and your crimping material is in the range of EPB SERIES TOOLS.
- Do not crimp without any material in crimping area, otherwise the tool will be damaged.
- Do not put your hands/fingers in the working area while operating, cleaning and testing. This action is very dangerous.
- Please do not aim at anyone while operating. This action is very dangerous.
- Before crimping, the dies must be fixed tightly to the dies holder.

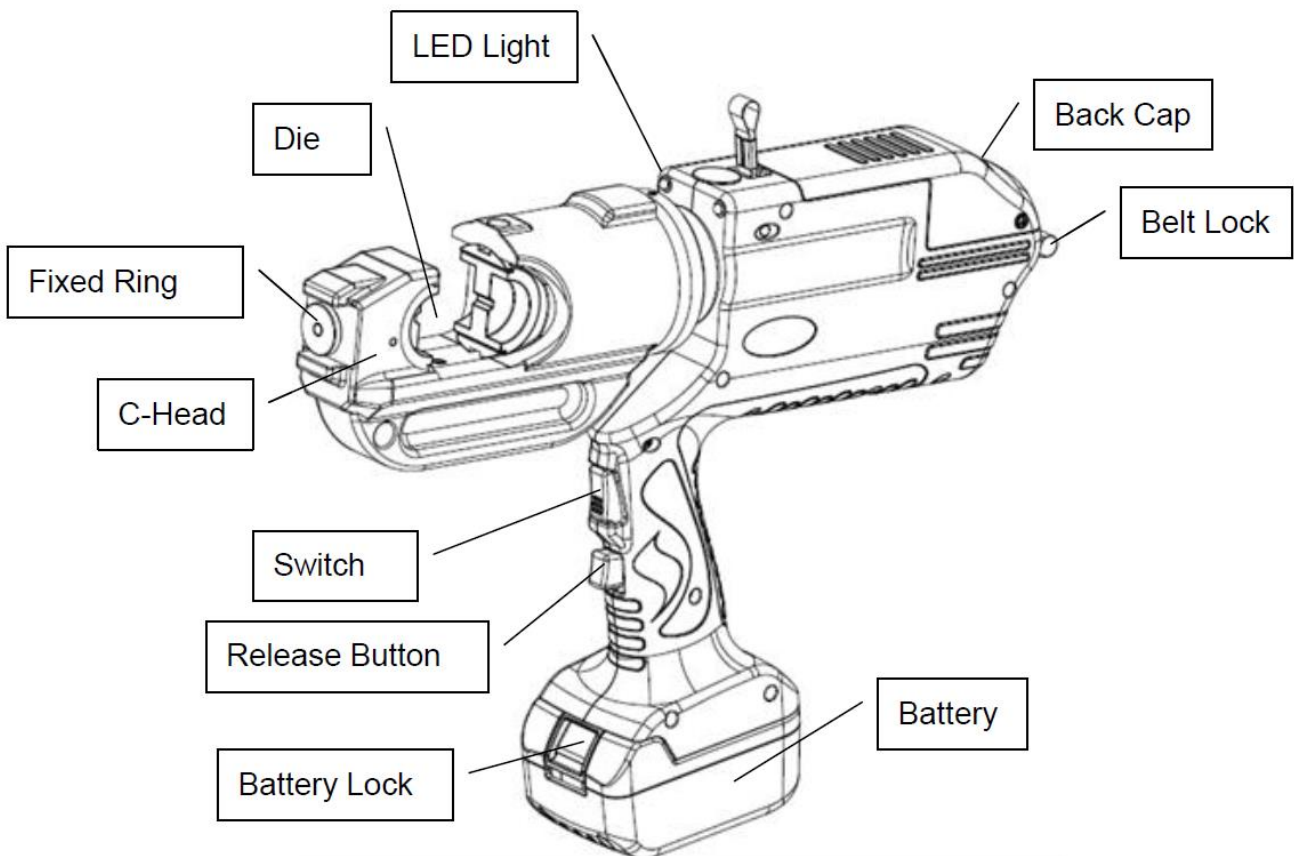

CRIMPING TOOL – OPERATING/USE

Insert the battery to CRIMPER as below picture 1:

- Battery will be buckled to the tool

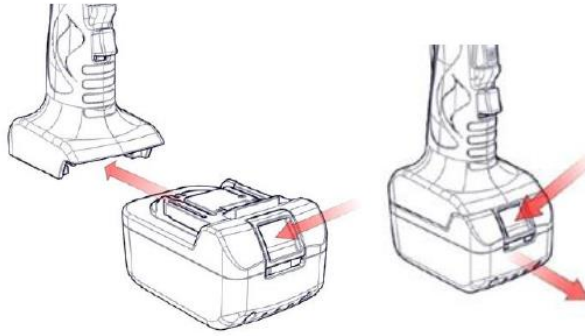

Picture 1: Set battery

Follow four steps as below picture 2 to insert the dies:

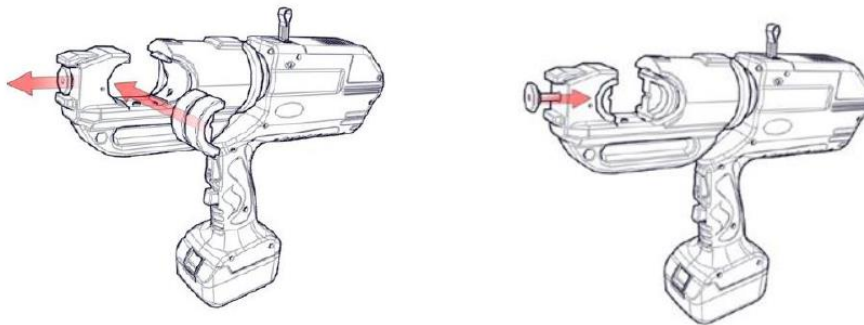

1/ Pull out Fixed Ring and put the dies in. 2/ Push the Fixed Ring as narrow direction.

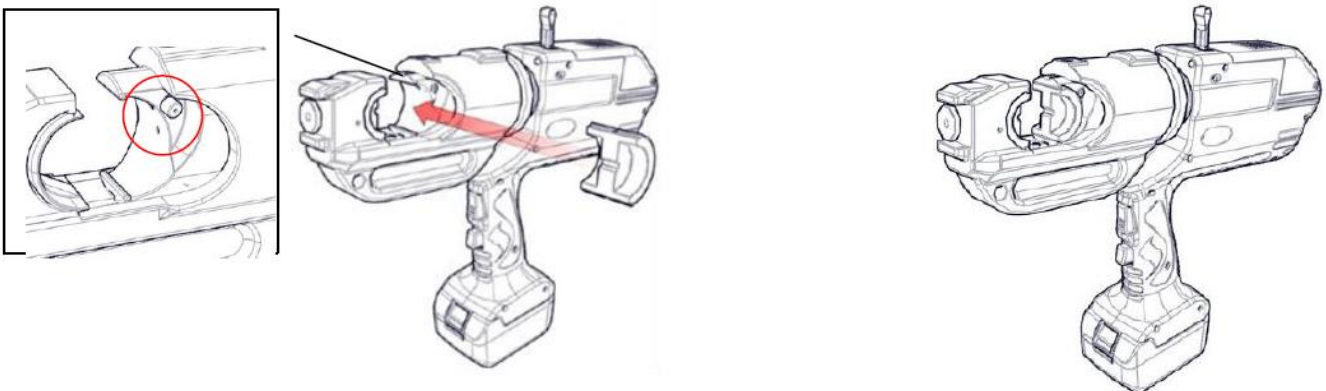

3/ Press the small button here and insert the dies. 4/ Dies are well inserted.

Picture 2: Set dies

CRIMPING TOOL – OPERATING/USE

After setting the dies, crimping material and battery, please press the Switch and Oil Return to operate the crimping dies to crimp, as below picture 3:

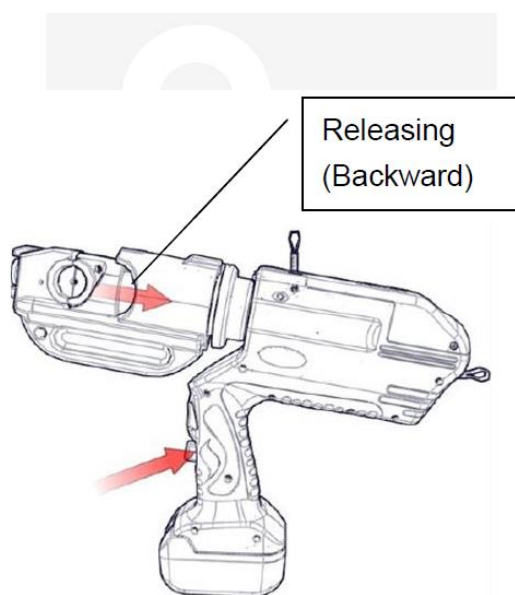
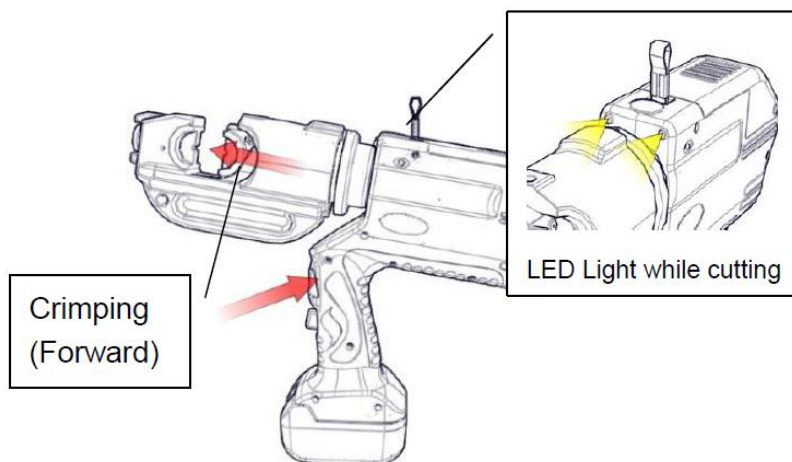

Fall Protection

Picture 3: Operation

MAINTENANCE GUIDE – CRIMPING TOOL

STORAGE

The hydraulic oil for EPB-4201:

Add/use hydraulic oil **SHELL TELLUS T-15** or **SEA#20**. Do not use other brands. Otherwise the tool will be damaged.

HOW TO ADD OIL

Take the screw out and open the oil hole.

Take the housing out.

Take the plug and add the correct oil in.

Put the plug to the original place and set the housing & screw back

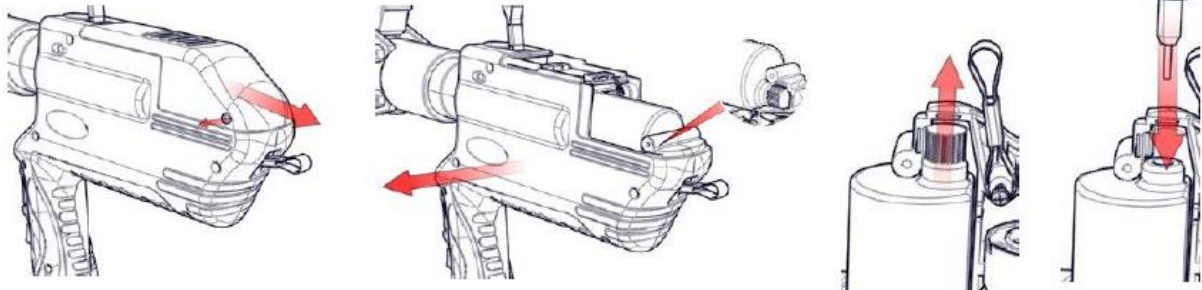

STORAGE

Put the tool, charger and battery in a dry clean place. Please charge the battery fully once every two months to make sure the battery has longer life. Clean the tool and add some anti rust oil on the metal parts, i.e. blade, blade holder before storage.

BREAKDOWN SOLVING

BREAKDOWN SITUATION	PROBLEM	METHOD TO SOLVE
NORMAL MOTOR BUT BLADE NOT MOVING	OIL IS NOT ENOUGH	ADD OIL OR SEND BACK
	AIR IN OIL RESERVOIR	SEND BACK FOR SUPPORT
	OIL RETURN IS DEFECT	SEND BACK FOR SUPPORT
NORMAL MOTOR BUT WITHOUT PRESSURE	O-RING IS BREAKDOWN	SEND BACK FOR SUPPORT
	OIL IS NOT ENOUGH	ADD OIL OR SEND BACK
MOTOR DEFECT	BATTERY DEFECT	CHANGE BATTERY
	CONNECTION OF BATTERY AND TOOL DEFECT	CHECK ALL CONNECTION POINTS
	SWITCH BREAKDOWN	CHECK SWITCH SEND BACK FOR SUPPORT
OIL RETURN DEFECT	CAN NOT OPERATE	COMPLETE THE CIRCLE
	BLADES BLOCKED	CLEAN THE BLOCK
	OIL RETURN BREAKDOWN	SEND BACK FOR SUPPORT

- ⚠ If you encounter any breakdown that you cannot handle, please contact us via info@safetylink.com
- ⚠ Do not try to solve the breakdown without any protective equipment.

CRIMPING TOOL - 18V BATTERY & CHARGER SET

HOW TO OPERATE/USE CH-07 CHARGER

- The charger CH-07 is suitable for Li-Ion battery B-04(3Ah) & B-06(1.5Ah). The voltage of charger CH-07 is 18V.

LED MEANINGS OF SITUATION

DIGITAL		Well charged	DIGITAL		Battery Error/Low voltage
		Battery Error/No rising voltage			over temperature



- While connecting to power, the digital monitor shows **Err**. The Buzzer buzzes once.
- Already connected to power, but the battery is not in the charger, the digital monitor shows **Err** and flash once a second.
- After inserting the battery in the charger, it will detect the battery voltage and show the capacity in percentages.
- If the battery is well charged, the digital monitor shows **100**. The Buzzer buzzes once every three seconds.
- If the voltage of battery is low, the digital monitor shows **LoD**. If the Buzzer buzzes once every second, it indicates the battery has error/defect.
- If the temperature of the battery is high the digital monitor shows **Err**. The Buzzer buzzes once a second, wait until the battery is cooled down, then charge the battery.
- After charging for 10 Minutes, the voltage is not rising, the digital monitor shows **bor**. The Buzzer buzzes once every two seconds and stop one second, it means the battery has error/defect.
- The Max. Charging Time is 60-70 Minutes. After 70 Minutes, no matter if the battery is fully charged or not. The charger will stop.
- While charging, the digital monitor shows the capacity in percentage each 5% until 90%. After 90% of capacity, it will show the capacity in percentage each 1% until full charged, i.e. 100%.
- There is a protecting system that while the battery is full charged, it will stop charging automatically. And if the battery temperature is over 65 degree, it will stop charging automatically, too.

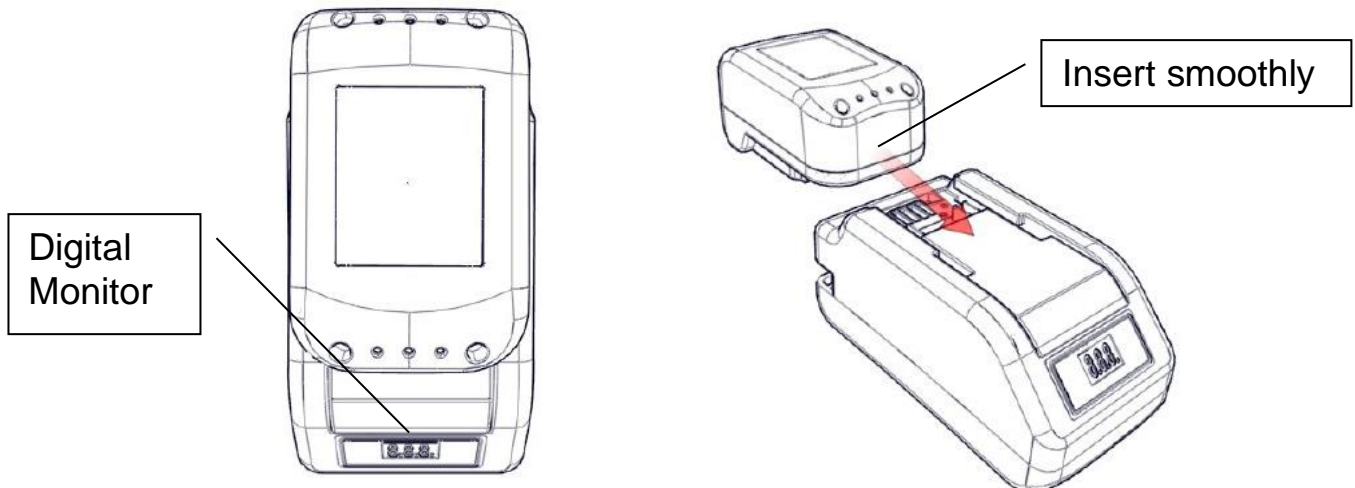

CRIMPING TOOL - 18V BATTERY & CHARGER SET

ABOUT THE 18V LI-ION BATTERY: B-04 & B-06

B-04(3.0Ah)

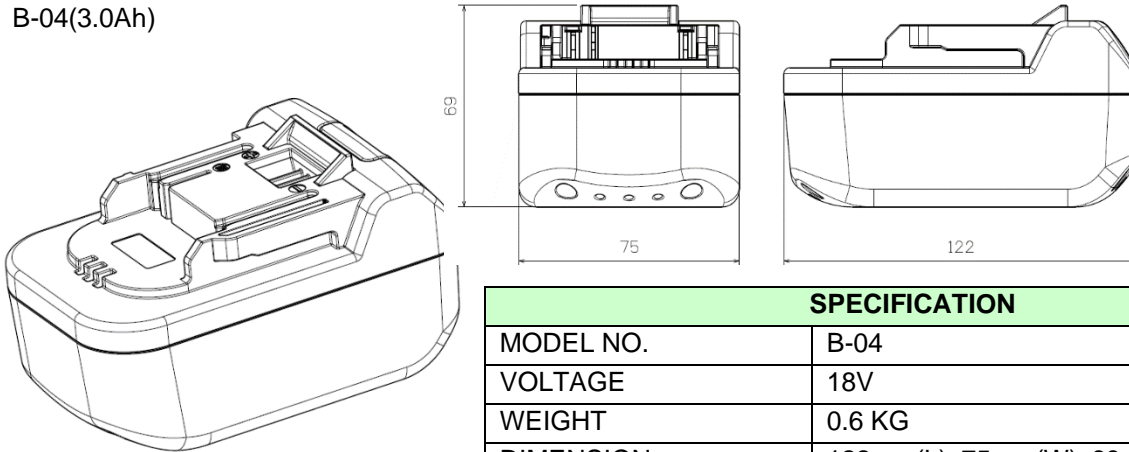

SPECIFICATION	
MODEL NO.	B-04
VOLTAGE	18V
WEIGHT	0.6 KG
DIMENSION	122mm(L)x75mm(W)x69mm(H)
CHARGING TIME	60-70 MINUTES
CAPACITY	3.0Ah
MEMORY EFFECT	NO

B-06(1.5Ah)

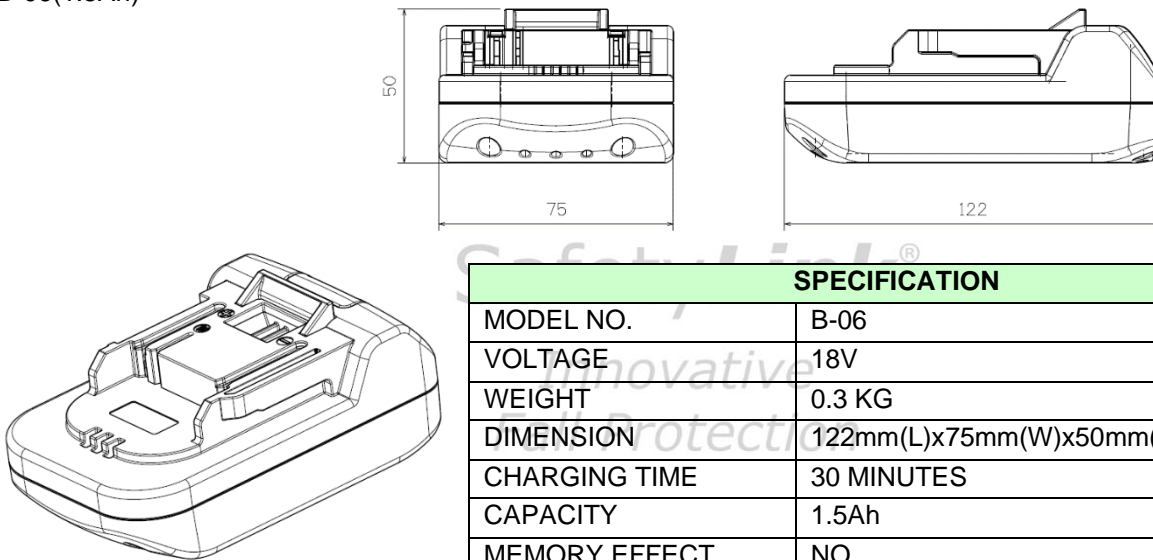

SPECIFICATION	
MODEL NO.	B-06
VOLTAGE	18V
WEIGHT	0.3 KG
DIMENSION	122mm(L)x75mm(W)x50mm(H)
CHARGING TIME	30 MINUTES
CAPACITY	1.5Ah
MEMORY EFFECT	NO

CRIMPING TOOL - 18V BATTERY & CHARGER SET

MANUAL/INSTRUCTION OF BATTERY

SPECIFICATION

Voltage	9.6V	14.4V	18V	CURRENT	CHARGING
Ni-MH	B-03	B-02	-	3.0Ah	90 MIN.
LI-ION	-	B-05	B-04	3.0Ah	60 MIN.
	-	-	B-06	1.5Ah	30 MIN.

BEFORE OPERATION PLEASE NOTE

- ◆ Do not contact the battery terminals with any metal. Otherwise the battery may short circuit.
- ◆ Do not store the battery in wet/hot spaces. Store battery in a dry clean space.
- ◆ The electrical capacity of the battery may be reduced/lost/damaged if the battery is left in the tool or charger for a long period.
- ◆ Do not heat the battery.
- ◆ Keep the battery away from water, keep the battery dry & clean.
- ◆ Do not press/take apart/throw down the battery. Do not put the battery near water or fire. Do not put the battery in your pocket.
- ◆ Do not damage/destroy the housing/package/body of battery.
- ◆ Do not use damaged batteries with strange/abnormal appearances.
- ◆ The battery after use will be warm.
- ◆ The battery in low temperatures (10 Degree or below), will be deteriorated and its use time will be shorter. This is normal.
- ◆ Please follow the instructions of battery manual to charge the battery.
- ◆ Do not charge the battery directly under the sun or in a space with high temperature.
- ◆ Please use supplied charger to charge the battery.
- ◆ Do not use battery with other brands.
- ◆ Please charge the battery before storage if you will not use the battery for a long time. Please charge the battery at least once a month to ensure its life.

HOW TO CLEAN THE BATTERY

- ◆ If the connecting points (+/-) or the cap of battery is dirty. It may obstruct the electrical current. Therefore, you will find the digital monitor will still show "Without Power" under full charged.
- ◆ Please keep the connecting points (+/-) or the cap of battery clean. Use a dry soft cloth to wipe the battery housing/cap and the connecting points (+/-).
- ◆ Do not use cleaners or chemical cleaners to clean the battery or charger, otherwise damage may result.

RECYCLE & THROW AWAY

- ◆ Make sure there is without any power inside the battery before throwing the battery away.
- ◆ Please charge the battery fully at the first use. If the battery's life is reduced after several uses, you will require a replacement battery.
- ◆ Please stick gummed tape on the connecting points (+/-) for fire/explosion prevention. Please follow the local rule of recycling.



EXAMPLE: LAYOUT OF LIFELINE SYSTEM

All working at heights safety procedures must be complied with when installing SafetyLink height safety systems. For more information refer to your state or territories current legislation, regulations, policies and codes of practices. Horizontal height safety lifelines must only be installed and used by competent people with relevant current height safety qualifications.

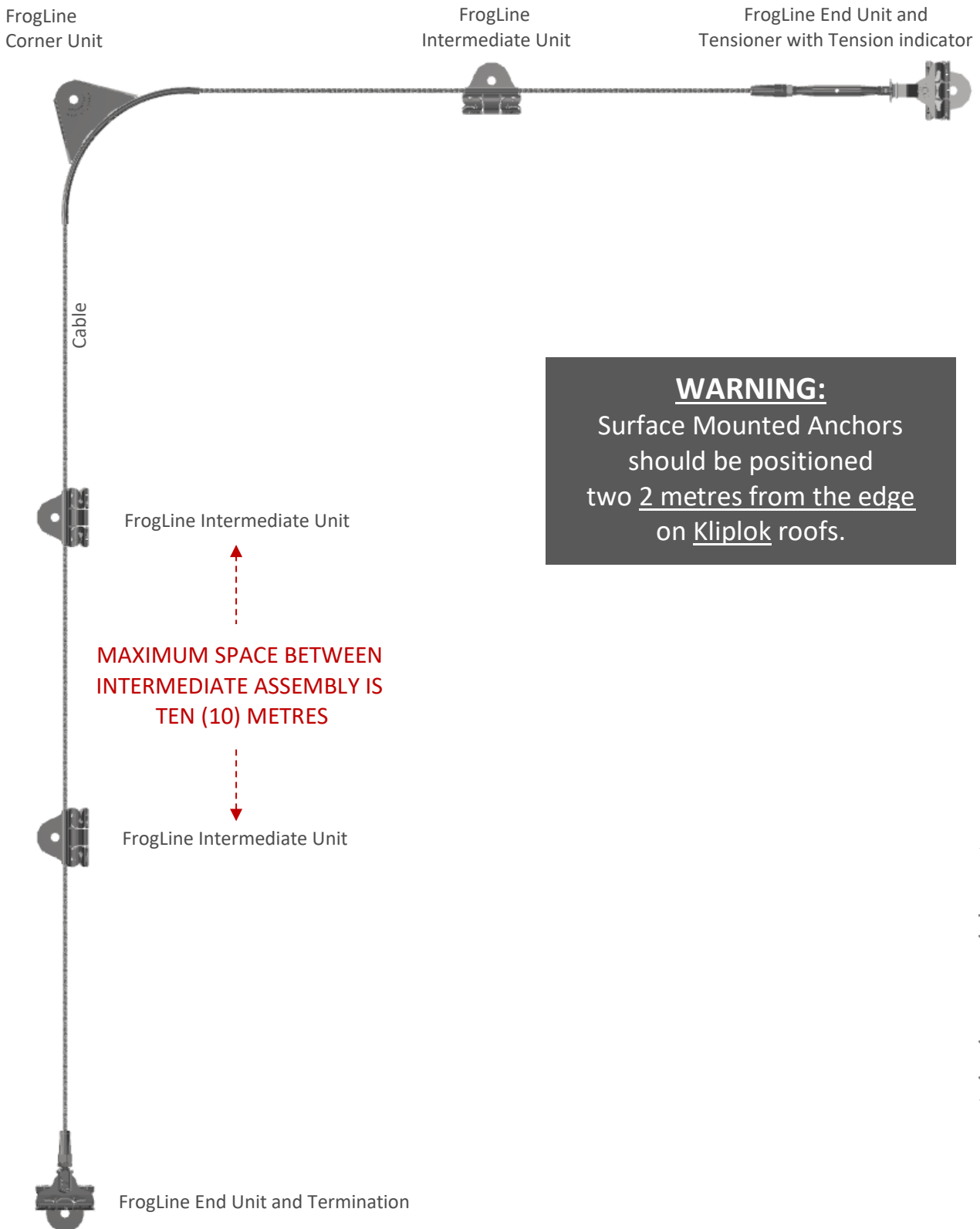

This is a guide only

SAFETYLINK HEIGHT SAFETY SYSTEMS MUST ONLY BE INSTALLED AS PER OUR INSTALLATION GUIDES, TO STRUCTURES AS SPECIFIED IN THE INSTALLATION MANUAL FOR EACH PRODUCT. SHOULD ANY DOUBT EXIST IN REGARDS TO THE STRUCTURES INTEGRITY AN ENGINEER SHOULD BE CONSULTED.



APPENDIX A – CRIMPED FITTINGS

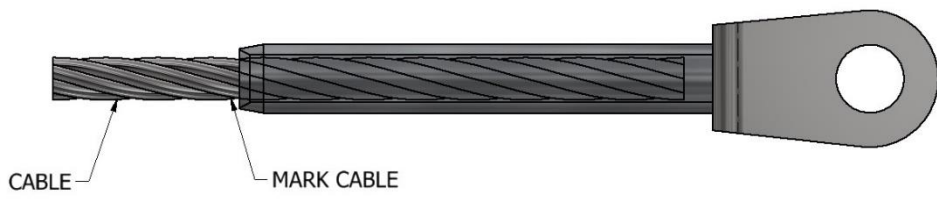

1. Insert the cable into the open end of the fitting to be swaged, mark the cable where the cable and the fitting meet. Remove the cable and check that the mark is at least 84mm from the cable end.

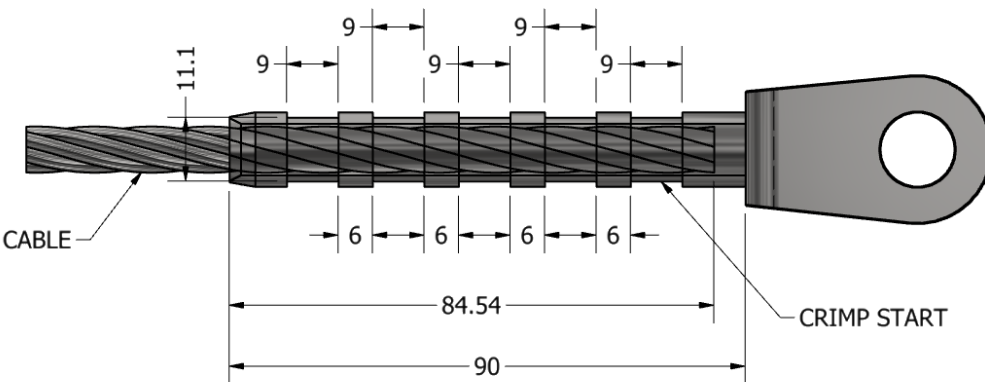

2. Re-insert the cable into the fitting to distance previously marked. Start swaging the fitting from the closed end as shown above. Continue to swage as indicated above 5 times, first swage is 6mm from the depth indicator.

3. Ensure that you can no longer see the mark that was made in Step 1. Check the crimped sections are within the allowable tolerances using Vernier Callipers. (Allowable tolerances = $11.10 \pm 0.2\text{mm}$).

IMPORTANT NOTES TO REMEMBER

- ⚠ Ensure marked cable as indicated in step one is a minimum of 84mm.
- ⚠ Ensure all crimped sections (flat) with 11.10mm, with a tolerance level of + or - 0.2mm. This distance should be the case of all 8mm 7 x 19 and 7 x 7 cable. The measurement should be taken with Vernier Callipers to ensure accuracy. If your measurements are outside the acceptable tolerance range this can be a sign of either a loss of pressure in your swaging tool or an indication that your dies are worn or incompatible. Any swaging that occurs outside the acceptable tolerances will need to be restarted using the appropriately amended tools.
- ⚠ When swaging the cable the mark made in step 1 will disappear during the final swage due to the lengthening of the material during the swaging operation.
- ⚠ The swaged end has a mark indicating the end of the solid section of the unit and the start of the hollow section. Start swaging 6mm from the mark indicating the solid section.
- ⚠ When completed the swaged section should be a minimum of 80mm long. The dies are made with a 9mm wide section to crimp. These 9mm crimping sections need to be completed 5 times, that is there will be five flat sections along the swaged end. In between each crimped section you need to maintain a distance of between 5 and 6mm.

DO NOT swage the solid section indicated by the mark on the unit this will damage the swaging tool and the dies. (Marking the swaging depth on the end to be swaged unit (84mm from the opening will help to avoid this). To do this, use Vernier Callipers, checking the maximum size and minimum size.



SafetyLink®

*Innovative
Fall Protection*



SafetyLink®

*Innovative
Fall Protection*

IN CASE OF ACCIDENT

⚠️ A FALL RESCUE PLAN AND SAFE WORK STATEMENT MUST BE DEVELOPED PRIOR TO USING SAFETYLINK SYSTEMS AND EQUIPMENT.

⚠️ PERSONS WORKING AT HEIGHTS SHOULD NOT WORK ALONE.

It is critical that before using any SafetyLink Systems a fall rescue plan is in place for any persons suspended mid-air following a fall. Serious injury or death can occur in a matter of minutes, particularly if a person's movement or breathing is restricted or loss of consciousness has occurred. In accordance with your fall rescue plan and appropriate first aid procedures it is essential to remove the person from the suspended position as quickly as possible.

IN ACCORDANCE WITH AS/NZS 1891.4:2009 CLAUSE 9.5

EQUIPMENT WHICH HAS ARRESTED A FALL OR SHOWS A DEFECT

Any piece of equipment including both personal and permanently installed items, which has been used to arrest a fall or which shows any defect during operator or periodic inspection shall be withdrawn from service immediately and a replacement obtained if necessary. A label indicating the condition or defect should be attached to the equipment, and it should be examined by a competent person who will decide whether the equipment is to be destroyed or repaired if necessary and returned to service. In the latter case, details of any repair shall be documented and a copy given to the operator.



SafetyLink®
*Innovative
Fall Protection*



FS 707792

DISTRIBUTOR:

SafetyLink Pty Ltd | ABN 83 081 777 371
Phone: 1300 789 545 or +61 2 4964 1068
info@safetylink.com | www.safetylink.com